

T. 8 S., R. 19 E., W.M.
 APPLICATION MAP FOR
 JON BOWERMAN

T-5186

Jon Bowerman

RECEIVED

JAN 17 1983

WATER RESOURCES DEPT.
 SALEM, OREGON

RECEIVED

NOV 29 1982

WATER RESOURCES DEPT.
 SALEM, OREGON

APPROVED

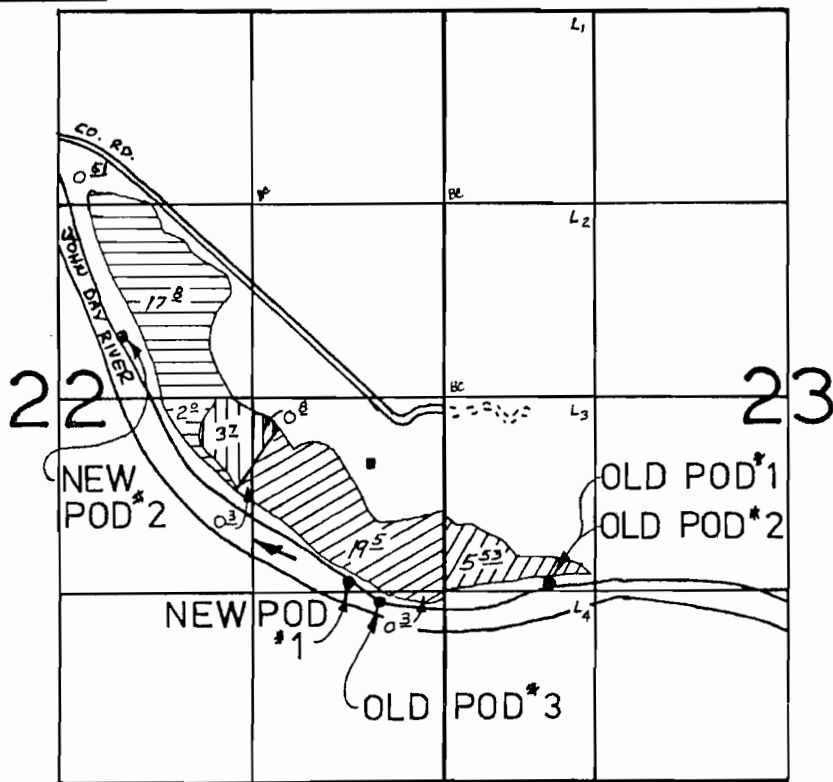

SCALE

4" = 1 mi

- D POD#1: 1370 ft N & 700 ft E of SW cor Sec. 23
 - D POD#2: 1270 ft S & 682 ft E of W 1/2 cor Sec. 23
 - D POD#3: 1350 ft S & 450 ft W of E 1/2 cor Sec. 22
- T. 8 S., R. 19 E., W.M.

	C-31299
	C-25129
	C-25129
	C-12191

FROM OLD POD	TO NEW POD
#1	#2
#3	#2
#3	#1
#2	#1

NEW POD#1: 1250 ft S & 650 ft W of E 1/2 cor Sec. 22
 NEW POD#2: 420 ft N & 2200 ft W of E 1/2 cor Sec. 22
 both T. 8 S., R. 19 E., W.M.

Application No. 64524
 Permit No.

RECEIVED

NOV 4 1982

WATER RESOURCES DEPT.
 SALEM, OREGON

T. 8S., R. 19E., W. M.

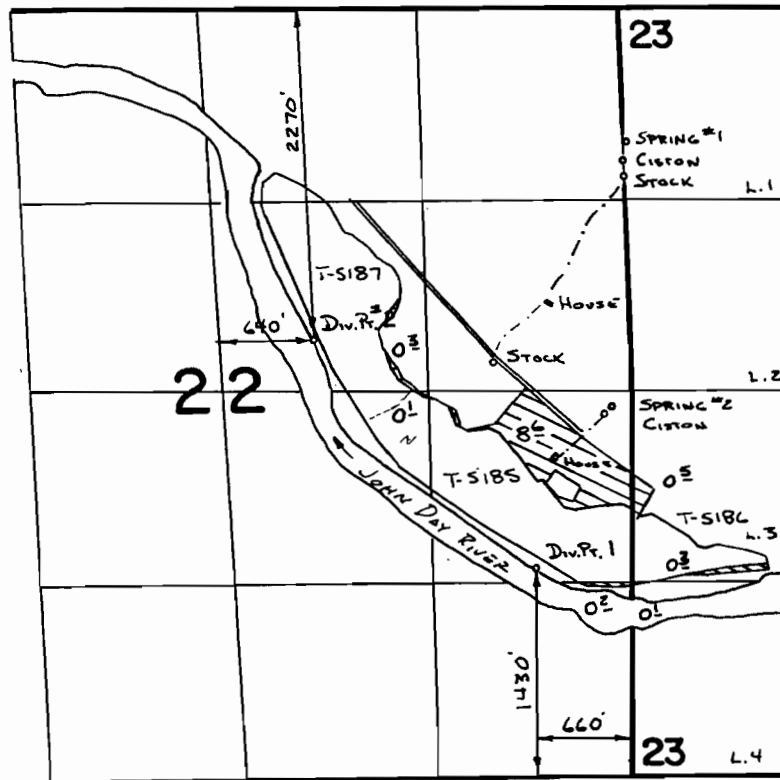

▨ Div. Pt. 2
▨ Div. Pt. 1

SCALE 1" = 1320'

SPRING #1 Loc: 920'S. & 20'E. FROM NW. COR. SEC. 23
SPRING #2 Loc: 100'S. & 140'W. FROM E 1/4 COR SEC 22

FINAL PROOF SURVEY UNDER

TRANSFERS 5185, 5186, 5187
Application No. **64524** Permit No. **47231**....
IN NAME OF

.....**JON BOWERMAN**.....

Surveyed 5-12..... 1987, by V.L. Church.....