

T.4N., R.28E., W. M.

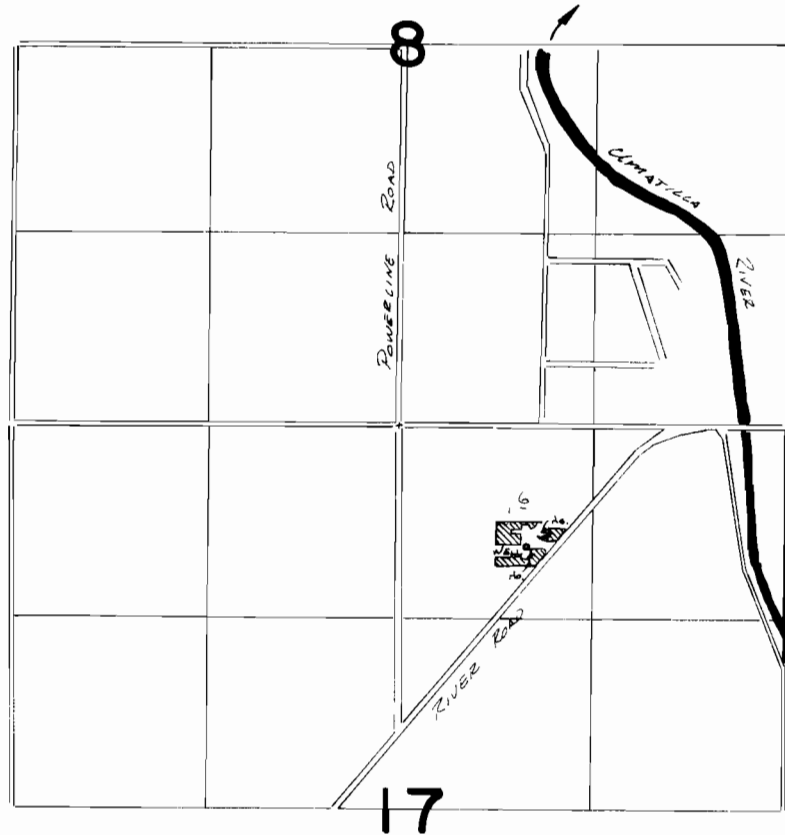

WELL LOG: 830'S & 870'E FROM N/4 COR SEC 17

FINAL PROOF SURVEY
UNDER

Application No. G:6101 Permit No. G:8229
IN NAME OF

.....JOHN L. KING.....

Surveyed Feb. 22..... 1983., by J. L. Church.....