

T.7S., R.2W., W.M.

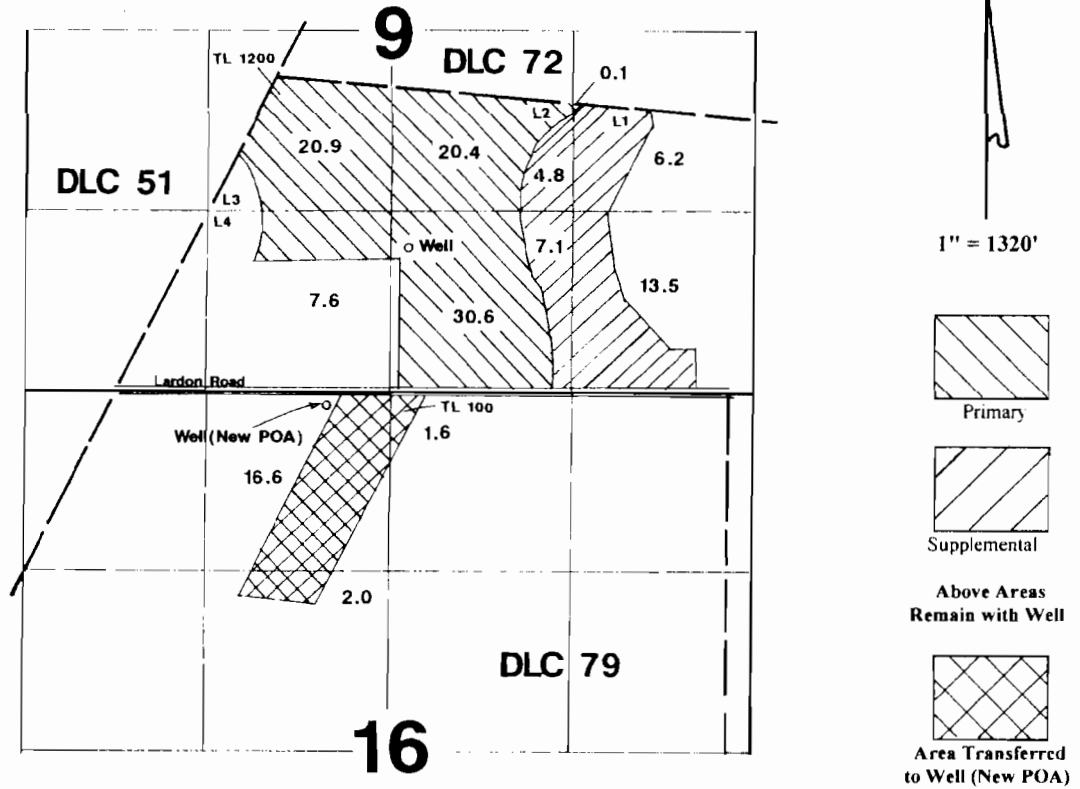

Well is located 1240'S & 930'E from NW corner of Lot 3, Section 9.
 Well (New POA) is located 50'S & 2200'E from NW corner Section 16.

T 10728

Application Map

RECEIVED

Stan A. Herr & Greg L. Herr

NOV 24 2008

Transfer #:

This Map was Prepared for the Purpose of Identifying the Location of a Water Right Only and is Not Intended to Provide Legal Dimensions or Location of Property Ownership Lines.

