

CLAIM OF BENEFICIAL USE POINT OF APPROPRIATION MAP

APPLICATION #G-11942
PERMIT #G-11379

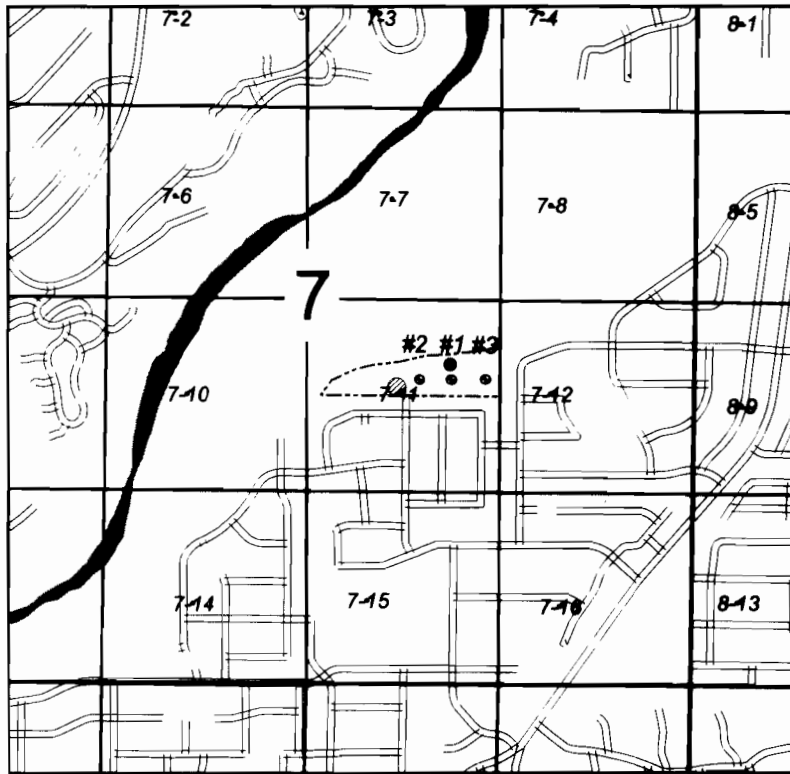

- LEGEND:**
- Well
 - ⊗ Reservoir
 - Flow Meters
 - ⊡ Well Taxlots
 - Road Centerline
 - █ DESCHUTES RIVER

ROCK BLUFF WELLS #1,2,3
TOWNSHIP 18S, RANGE 12E, WM
SECTION 7,
TAX MAP 181207DB, TAXLOT 100

AUTHORIZED PLACE OF USE FOR PERMIT G-11379 IS SHOWN IN FIGURE 1.

ROCK BLUFF WELLS:

- WELL #1: 1000 FEET EAST AND 543 FEET SOUTH OF THE NW CORNER OF THE SE 1/4 OF SECTION 7, T18S, R12E W.M.
- WELL #2: 779 FEET EAST AND 543 FEET SOUTH OF THE NW CORNER OF THE SE 1/4 OF SECTION 7, T18S R12E W.M.
- WELL #3: 1234 FEET EAST AND 539 FEET SOUTH OF THE NW CORNER OF THE SE 1/4 OF SECTION 7, T18S R12E W.M.

RECEIVED

JAN 08 2009

WATER RESOURCES DEPT
SALEM, OREGON

DISCLAIMER: The purpose of the map is to identify the location of the water right. It is not intended to provide information relative to the location of property ownership lines.

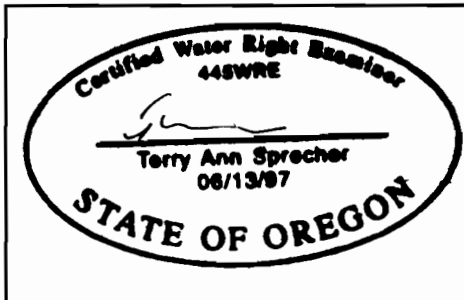

SCALE: 1"=1,320'

	Project #:	ROCK BLUFF WELL FIELD CITY OF BEND	FIGURE 2
	Date: 04/24/2008		

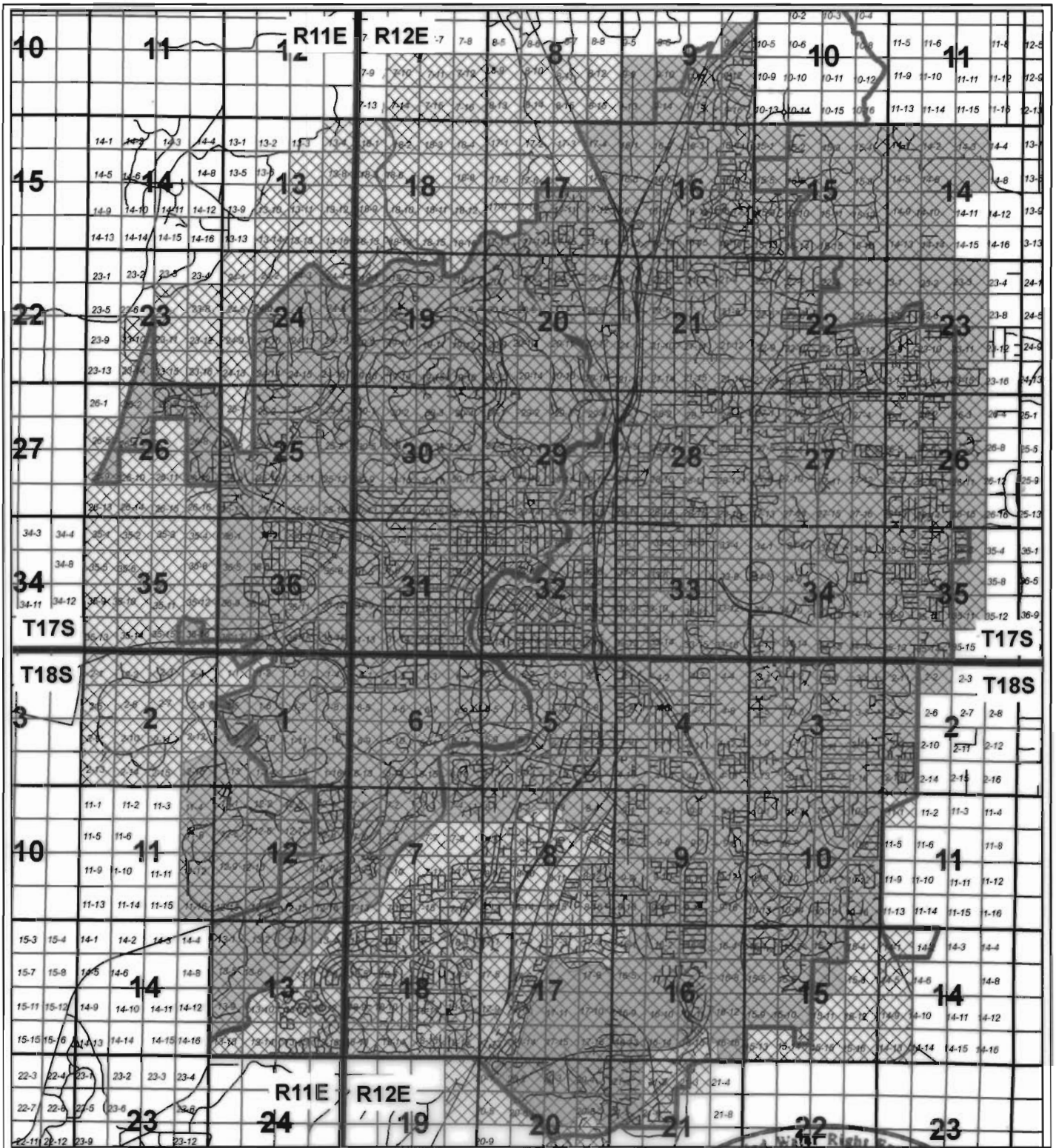

DISCLAIMER: The purpose of the map is to identify the location of the water right. It is not intended to provide information relative to the location of property ownership lines.



0 1,320 2,640 5,280 7,920 10,560



SCALE: 1"=5,280'

LEGEND:

- URBAN GROWTH BOUNDARY
- ROAD CENTERLINE
- DESCHUTES RIVER
- MAXIMUM EXTENT OF BENEFICIAL USE
- PLACE OF USE AUTHORIZED BY PERMIT G-11379



RECEIVED

PLACE OF USE MAP

APR 23 2009 APPLICATION G-11942, PERMIT G-11379
CITY OF BEND

FIGURE

1