

# T. 2 N., R. 30 E., W. M.

RECEIVED

MAY 20 1983

WATER RESOURCES DEPT.  
SALEM, OREGON

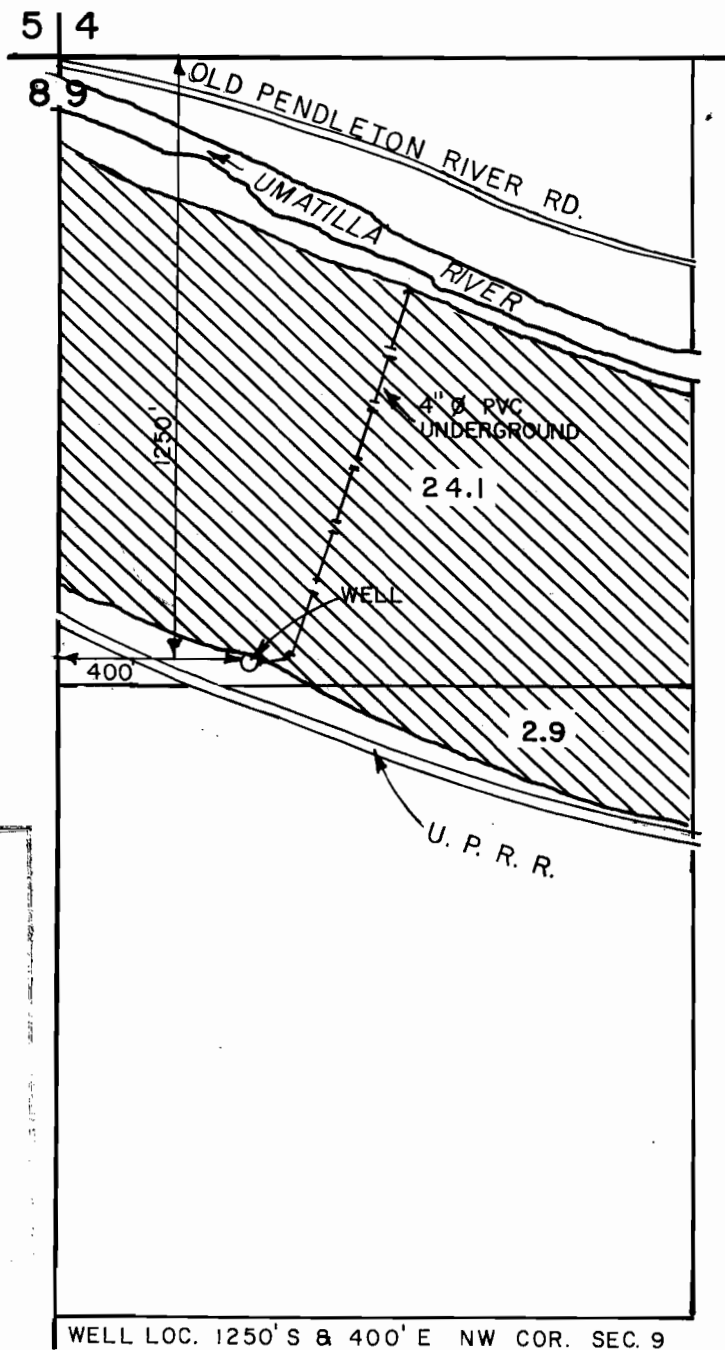

SCALE 1" = 400'

The preparation of this map was for the purpose of identifying the location of water right only, and has no intent to provide dimensions or locations of property ownership lines.

WELL LOC. 1250' S & 400' E NW COR. SEC. 9

## FINAL PROOF SURVEY

UNDER

Application No. G-12492 Permit No. G-11333

IN NAME OF

YGNACIO & SYLVIA ARISTEQUI

