

RECEIVED

SEP 29 2008

Claim of Beneficial Use Map
Permit R-10837 (Application R-69175)
Section 8, Township 2 South, Range 4 East (W.M.)

WATER RESOURCES DEPT
SALEM OREGON

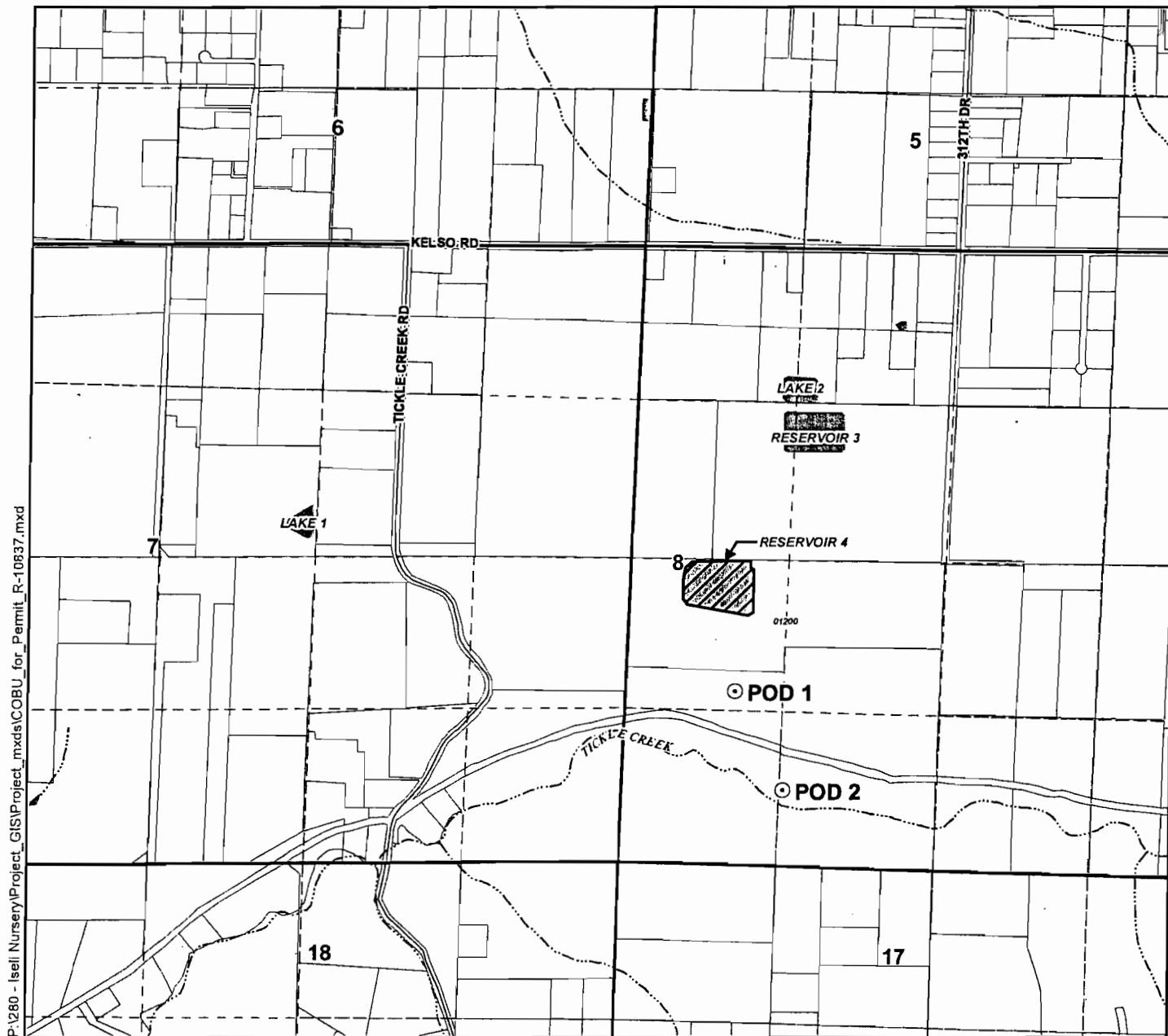

P:\280 - Isell Nursery\Project_GIS\Project_mxd\COBU_for_Permit_R-10837.mxd

Legend

- ⊙ Point of Diversion (POD)
- ~ Watercourses
- ▨ Place of Use (POU)
- ☪ Waterbodies
- ⊕ Tax Lots
- ⚡ Roads

Map Information

Projection: Oregon State Plane North Zone
Datum: North American Datum of 1983
Date: August 18, 2008
Prepared By: GSI Water Solutions, Inc.

Data Sources

Clackamas County GIS, Oregon Geospatial Data Clearinghouse

Disclaimer

This map was prepared for the purpose of identifying the location of a water right only and it is not intended to provide legal dimensions or location of property ownership lines.

POD Location Description

POD 1

Located 1,490 feet North and 900 feet East from the SW corner of Section 8, Township 2 South, Range 4 East (W.M.)

POD 2

Located 645 feet North and 1,345 feet East from the SW corner of Section 8, Township 2 South, Range 4 East (W.M.)

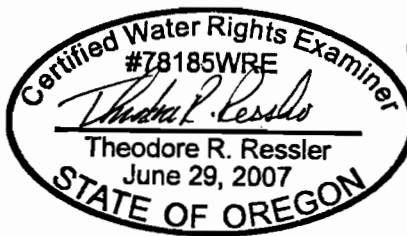

EXPIRES: 12-31-2008



Scale

0 660 1,320
1 inch equals 1,320 feet

