

Claim of Beneficial Use Map
 Permit R-9901 (Application R-68128)
 Section 8, Township 2 South, Range 4 East (W.M.)

WATER RESOURCES DEPT.
 LEM, OREGON

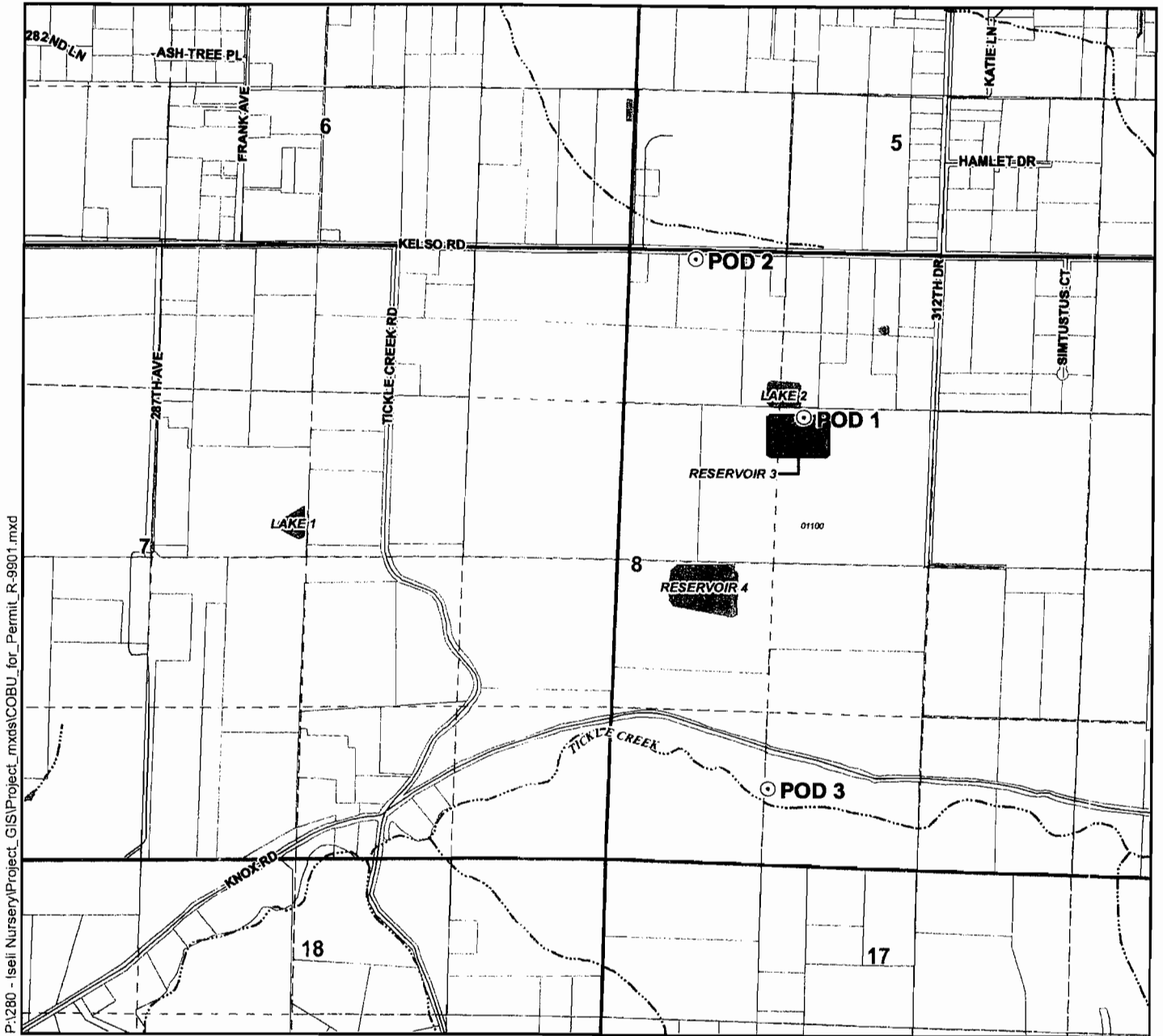

P:\280 - Isell Nursery\Project_GIS\Project_mxd\COBU_for_Permit_R-9901.mxd

Legend

- ⊙ Point of Diversion (POD) ⊕ Tax Lots ~ Watercourses
- ▨ Place of Use (POU) ~ Roads ■ Waterbodies

POD Location Description

- POD 1**
 Located 1,255 feet North and 1,160 feet West from the Center corner of Section 8, Township 2 South, Range 4 East (W.M.)
- POD 2**
 Located 60 feet South and 565 feet East from the NW corner of Section 8, Township 2 South, Range 4 East (W.M.)
- POD 3**
 Located 645 feet North and 1,345 feet East from the SW corner of Section 8, Township 2 South, Range 4 East (W.M.)

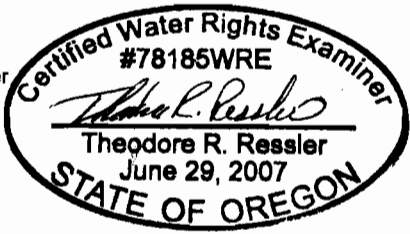

EXPIRES: 12-31-2008

Map Information

Projection: Oregon State Plane North Zone
 Datum: North American Datum of 1983
 Date: August 13, 2008
 Prepared By: GSI Water Solutions, Inc.

Data Sources

Clackamas County GIS, Oregon Geospatial Data Clearinghouse

Disclaimer

This map was prepared for the purpose of identifying the location of a water right only and it is not intended to provide legal dimensions or location of property ownership lines.

