

T.9S.R.IE., W.M.

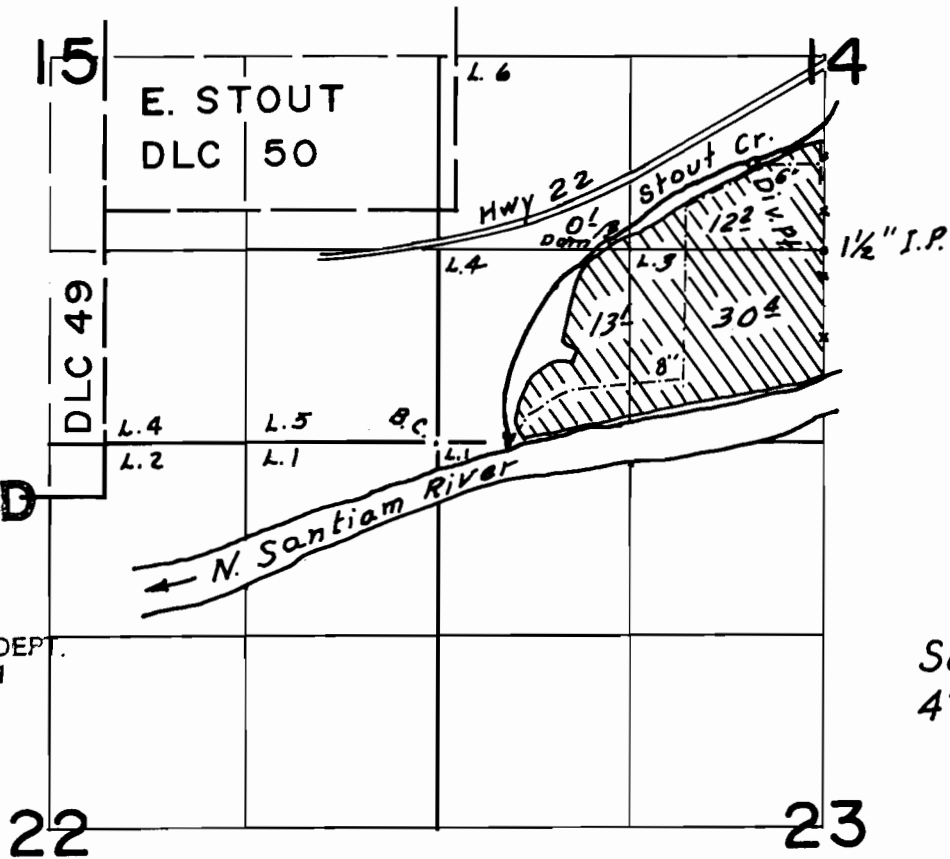

RECEIVED
SEP 16 1997
WATER RESOURCES DEPT.
SALEM, OREGON

Div. Pt. loc. 565' N & 480' W from NE Cor. lot 3

FINAL PROOF SURVEY UNDER

Application No. 7.0399 Permit No. 5.1.73.3.
IN NAME OF

MARK & JOLLY KRAUTMAN

Surveyed Aug. 11, 19.97, by

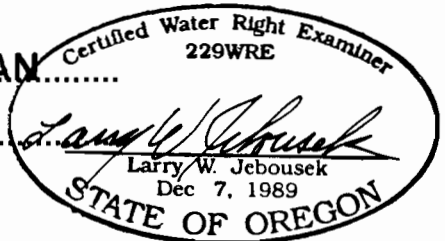

THIS MAP WAS PREPARED FOR THE PURPOSE OF IDENTIFYING THE LOCATION OF A WATER RIGHT ONLY AND IS NOT INTENDED TO PROVIDE LEGAL DIMENSIONS OR LOCATION OF PROPERTY OWNERSHIP LINES.

WAC-940R 18-57 5-6-94