

T 6 S, R 1 W, W.M.

MARION COUNTY

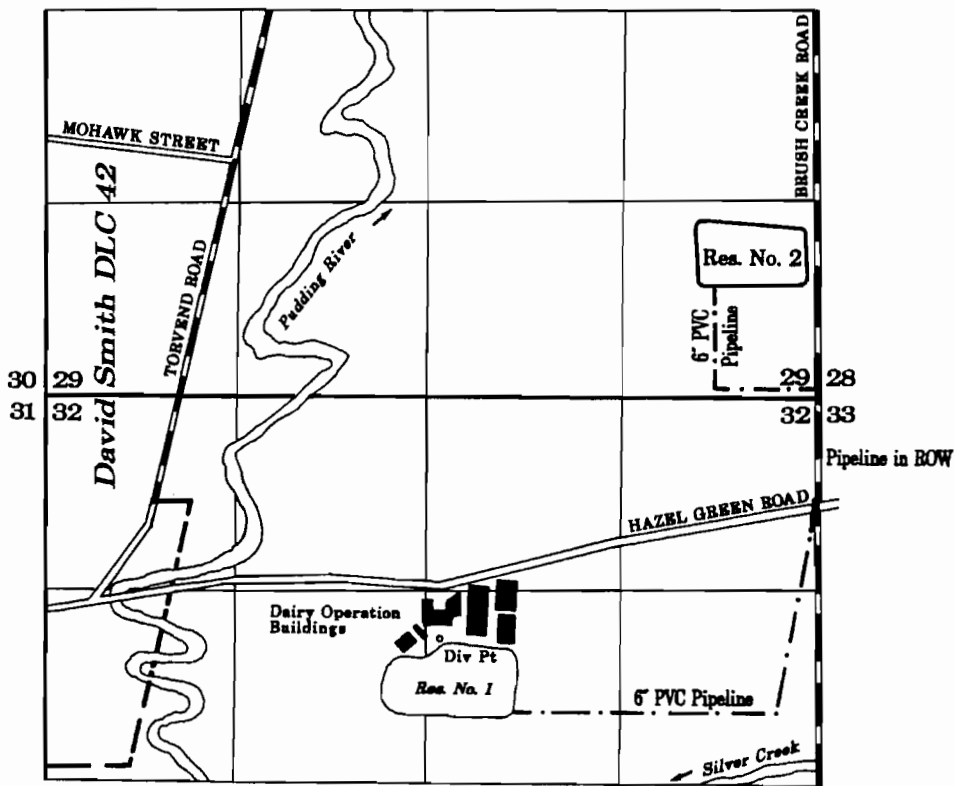

Div. Pt. 2580' West and 1660' South of the NE corner of Section 32.

FINAL PROOF SURVEY

UNDER

Application R-71914 Permit R-11534

IN THE NAME OF

MALLORIE'S DAIRY, INC.

September 17, 1999

Scale: 1" = 1320'

RECEIVED

OCT 01 1999

**WATER RESOURCES DEPT
SALEM, OREGON**

NOTE: This map is for the purpose of identifying the location of water rights and has no intent to locate or dimension property ownership lines.

