

RECEIVED

SEP 29 1993

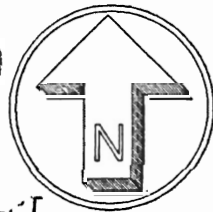

WATER RESOURCES DIVISION
SALEM, OREGON

APP: G-11707
PERMIT: G-10956

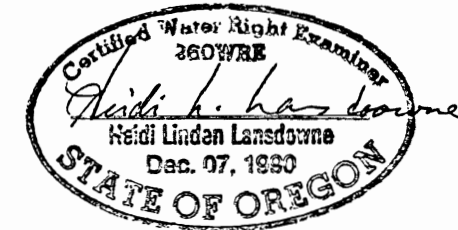

TAX LOT 2500, SECTION 20;
TAX LOTS 2510 & 2511,
SECTION 19; T20S, R11E,
W.M., DESCHUTES COUNTY, OREGON

THE WELL IS LOCATED 1760 FEET
WEST AND 470 FEET NORTH
OF THE SOUTHEAST CORNER OF
SECTION 19, T20S, R11E, W.M.
DESCHUTES COUNTY, OREGON.

TOTAL IRRIGATED AREA = 3.7 ACRES

I, Heidi L. Lansdowne, Certified Water Rights Examiner
in the State of Oregon, hereby certify the above
final proof map was prepared under my direct
supervision.

The preparation of this map is for the purpose
of identifying the location of the water right only
and has no intent to provide dimensions or locations
of property ownership lines.

IRRIGATED AREA



LANSLOWNE ENGINEERING
25 NW MINNESOTA, SUITE 14, BEND, OREGON 97701 (503)389-9060
SCALE: 1" = 400'
DATE: 27 SEPT 1993
DRAWN: HLL
DRWG. NO. TT

WATER RIGHTS
FINAL PROOF SURVEY MAP

FOR:
THOUSAND TRAILS, INC.
17480 SOUTH CENTURY DR.
BEND, OREGON 97707

SHEET
1
1
OF SHEETS

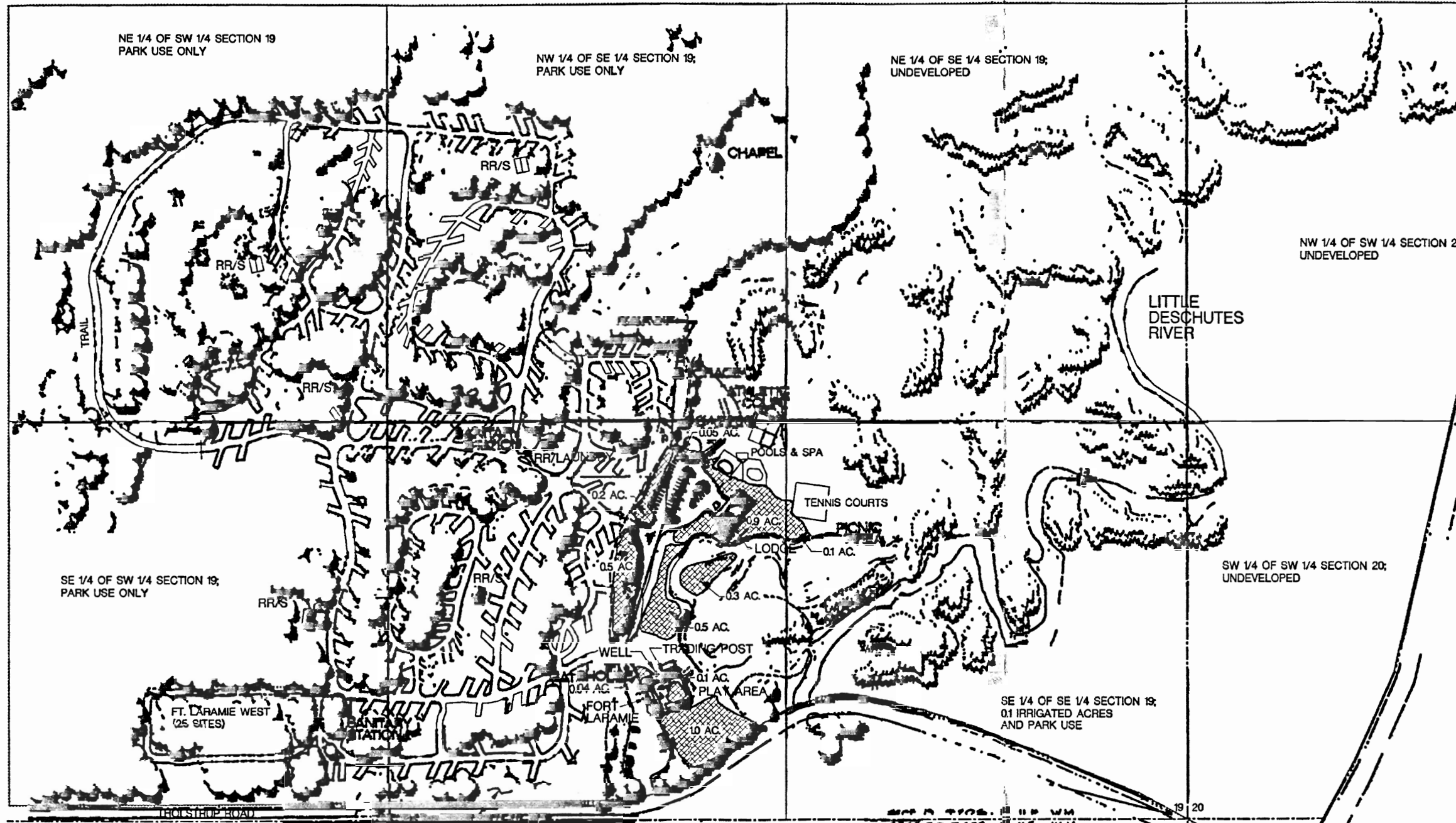

NE 1/4 OF SW 1/4 SECTION 19
PARK USE ONLY

NW 1/4 OF SE 1/4 SECTION 19;
PARK USE ONLY

NE 1/4 OF SE 1/4 SECTION 19;
UNDEVELOPED

NW 1/4 OF SW 1/4 SECTION 20;
UNDEVELOPED

SW 1/4 OF SW 1/4 SECTION 20;
UNDEVELOPED

SE 1/4 OF SE 1/4 SECTION 19;
0.1 IRRIGATED ACRES
AND PARK USE

SW 1/4 OF SE 1/4 SECTION 19;
3.6 IRRIGATED ACRES
AND PARK USE

S. 1/4 CORNER, SECTION 19

Thousand Trails