

T.4S., R.2W., W.M.

WATER RESOURCES
BUREAU

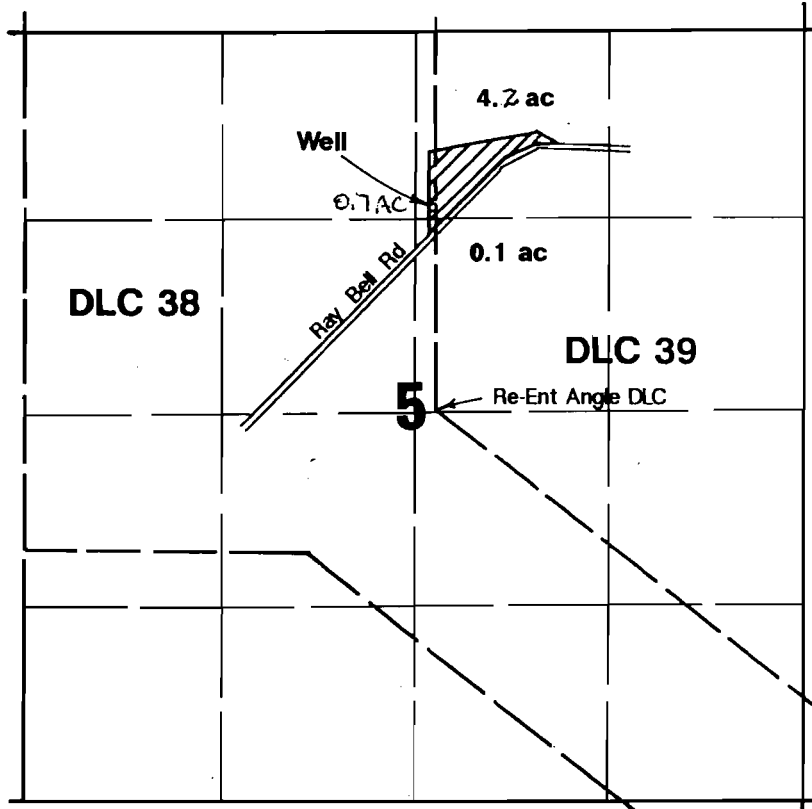

1" = 1320'

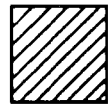

Nursery Operations

Well located 1380'N & 5'W from re-ent angle corner DLC.

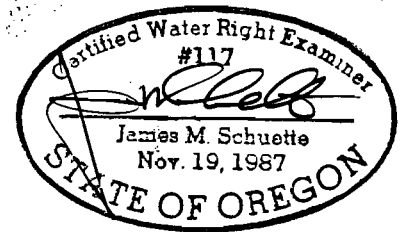

Final Proof Survey

Application #: G-12021 Permit #: G-10982

In Name Of

Portland Chapter American Rhododendron Society

Surveyed on September 22, 1993 by JM Schuette

THIS MAP WAS PREPARED FOR THE PURPOSE OF IDENTIFYING THE LOCATION OF A WATER RIGHT ONLY AND IS NOT INTENDED TO PROVIDE LEGAL DIMENSIONS OR LOCATION OF PROPERTY OWNERSHIP LINES.

AMENDED BY WRD STAFF, 4-3-2009, jwg