

T.4S., R.1W., W.M.

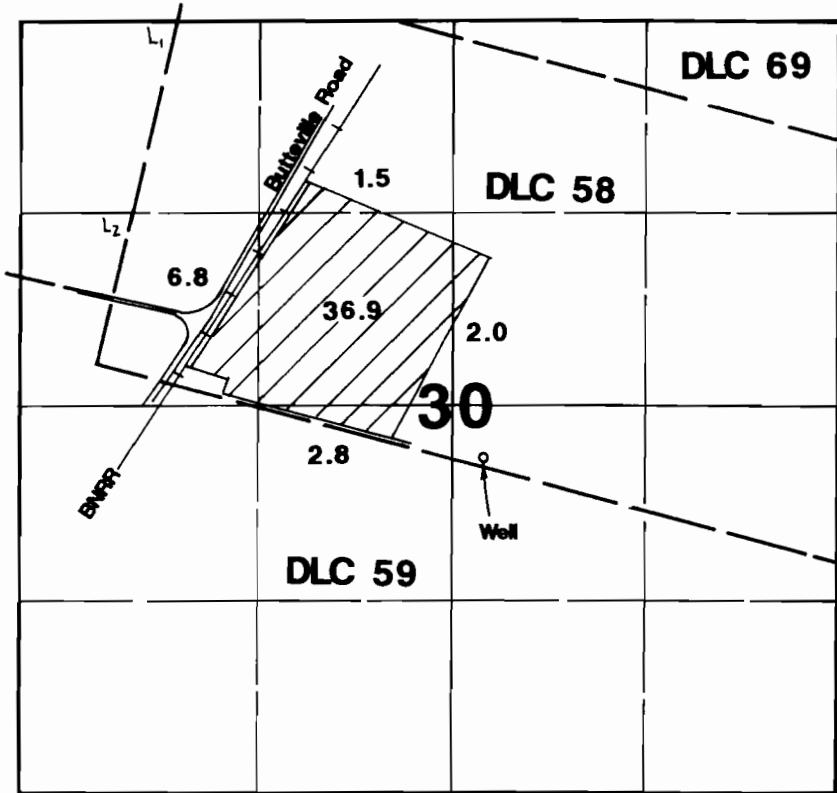

Well located 350'S & 200' E from center of Section 30.



Final Proof Survey

Application #: G-11860 Permit #: G-10997

In Name of

Erwin M. Nyquist

Surveyed on September 5, 1993 by JM Schuette

THIS MAP WAS PREPARED FOR THE PURPOSE OF IDENTIFYING THE LOCATION OF A WATER RIGHT ONLY AND IS NOT INTENDED TO PROVIDE LEGAL DIMENSIONS OR LOCATION OF PROPERTY OWNERSHIP LINES.