

T. 40 S., R. 8 E., W.M.

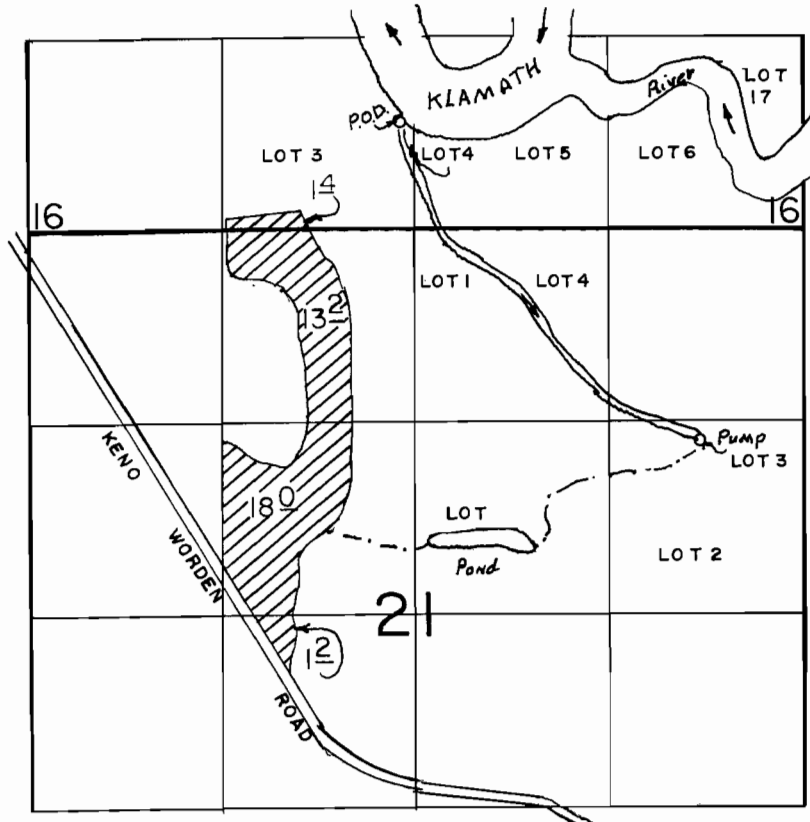

P.O.D. LOC: 750' N & 2550' E FROM SW COR. OF SEC 16.

SCALE: 1" = 1320'

FINAL PROOF SURVEY UNDER

Application No. 63271 Permit No. 46715
IN NAME OF

FLOWERS BROTHERS, INC.

Surveyed JULY 24, 1990, by D.SPARKS