

T.5S.,R.6W.,W.M.
SECTION 35

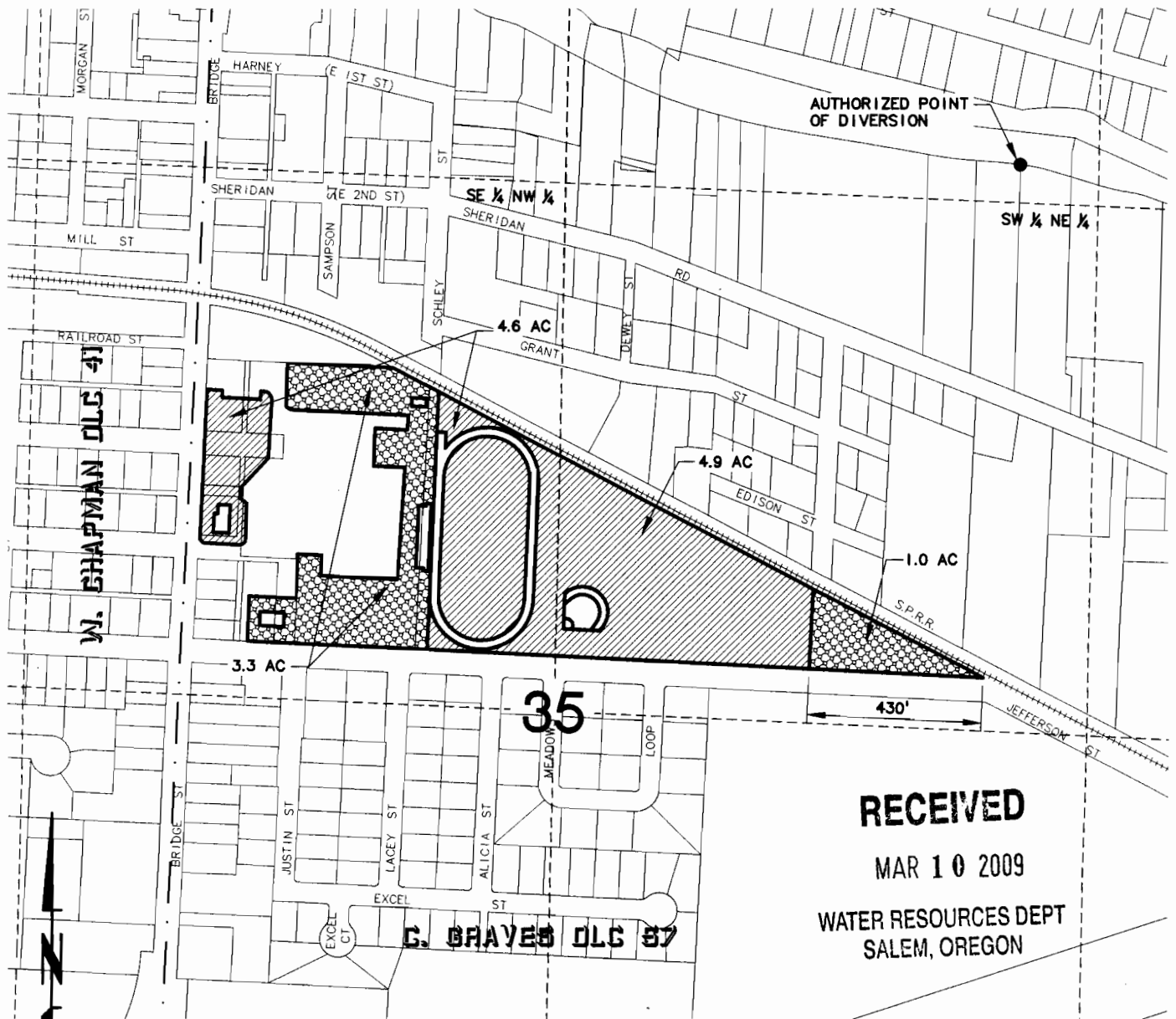

RECEIVED

MAR 10 2009

WATER RESOURCES DEPT
SALEM, OREGON

**APPLICATION MAP FOR TRANSFER OF WATER RIGHT
CERTIFICATE NO. 61618 PERMIT NO. S44812
EXISTING PLACE OF USE
IN THE NAME OF
SHERIDAN SCHOOL DISTRICT 48J
YAMHILL COUNTY**

SCALE:
1"=400'

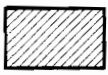
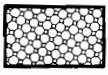
-  EXISTING PLACE OF USE TO REMAIN
AREA=9.5 ACRES
-  PROPOSED CHANGE IN PLACE OF USE
AREA=4.3 ACRES

JULY 2008
REVISED MARCH 2, 2009



RENEWS 6.30.09

NOTE: This map is for the purpose of identifying the location of the water right only and is not intended to provide legal dimensions or locations of property lines.