

THIS MAP WAS PREPARED FOR THE PURPOSE OF IDENTIFYING THE LOCATION OF THE WATER RIGHT AND IS NOT INTENDED TO PROVIDE LEGAL DIMENSIONS OR LOCATIONS OF PROPERTY OWNERSHIP LINES.

RECEIVED

T21S; R3E

JUL 17 1996

WATER RESOURCES DEPT.
SALEM, OREGON

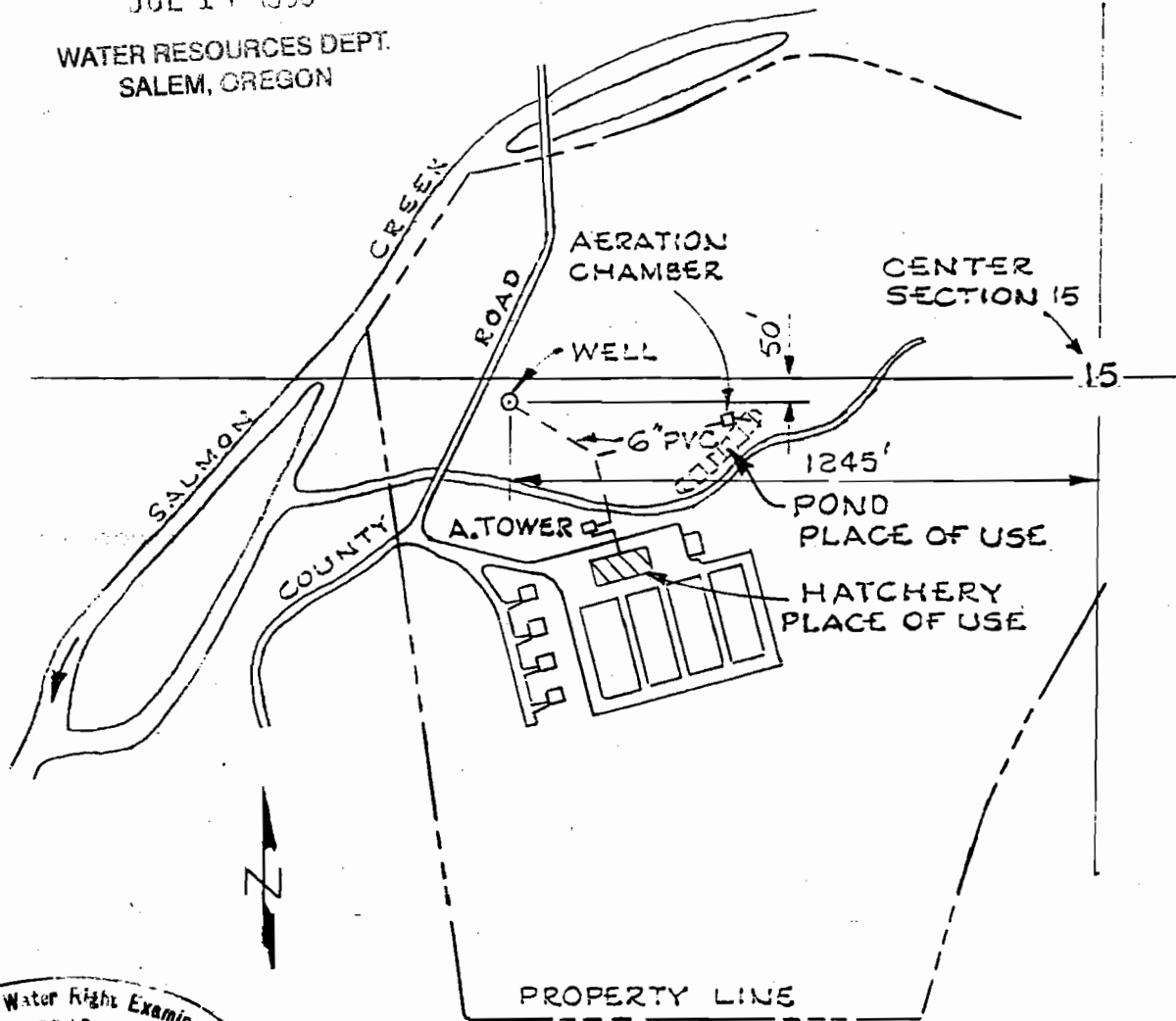

Certified Water Right Examiner
#040
Robert O. Dodge
ROBERT O. DODGE
NOV. 19, 1987
STATE OF OREGON

SCALE: 1" = 400'

FINAL PROOF SURVEY UNDER

APPLICATION NO. G-13755 PERMIT NO. G-12109
IN NAME OF

OREGON DEPARTMENT OF FISH AND WILDLIFE
SURVEYED: 7/8/96 BY: DODGE