

FINAL PROOF SURVEY
FOR WILLAMETTE INDUSTRIES, INC.

ALBANY PAPERMILL

LOCATED IN

SECTIONS 28 & 33

T.10S., R.3W., W.M.

LINN COUNTY, OREGON

SCALE: 1"=1320'-0"

PERMIT NO. 47184 APPLICATION 64514

TRANSFER 7508 - PERMIT AMENDMENT

RECEIVED

SEP 19 1997

WATER RESOURCES DEPT.
SALEM, OREGON

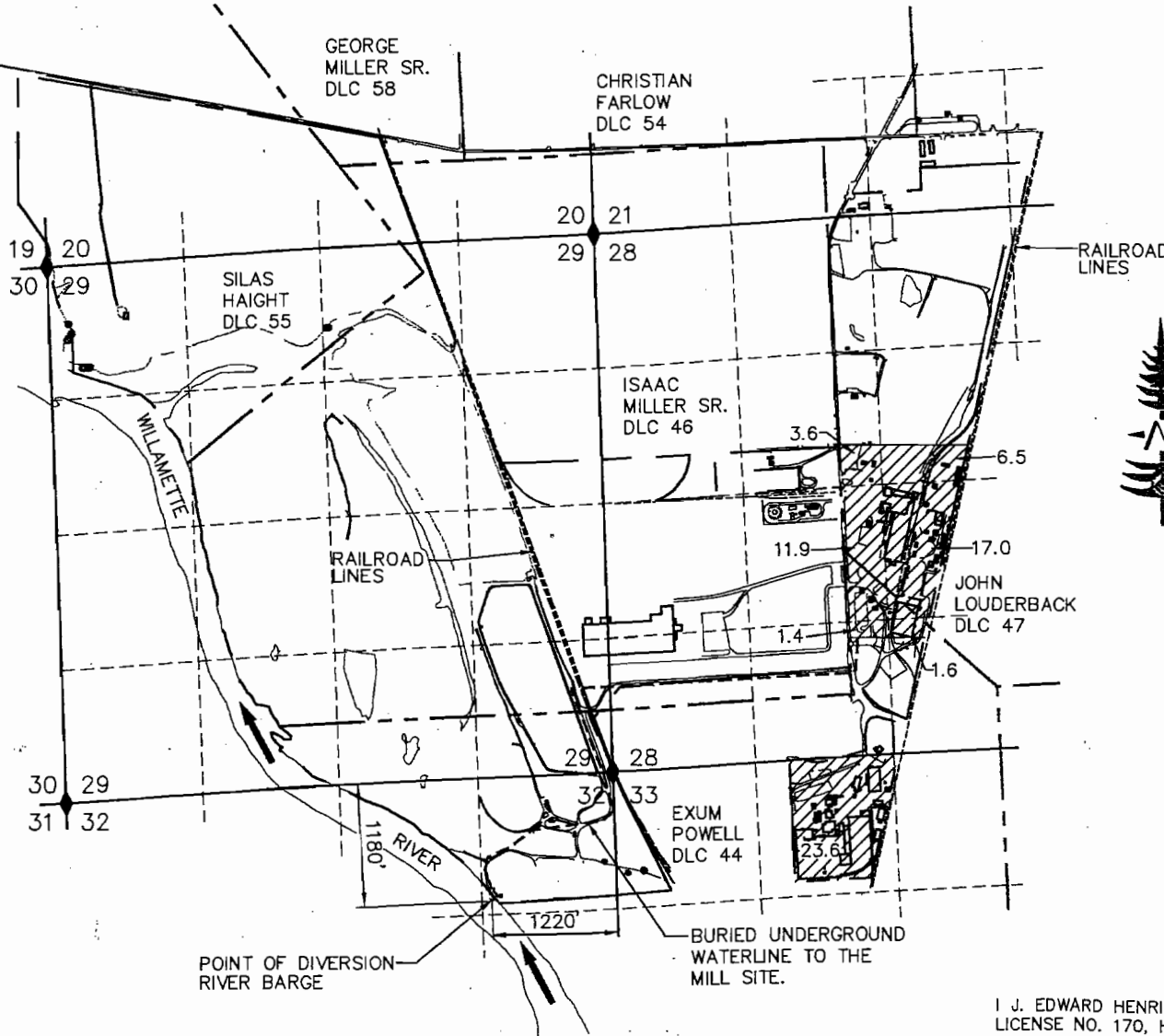

ACREAGE SUMMARY

SECTION 28—SW 1/4, NE 1/4	6.5 ACRES DLC 47
SE 1/4, NW 1/4	3.6 ACRES DLC 47
NW 1/4, SE 1/4	18.0 ACRES DLC 47
	1.0 ACRES DLC 44
SW 1/4, SE 1/4	1.6 ACRES DLC 44
NE 1/4, SW 1/4	4.5 ACRES DLC 44
	7.4 ACRES DLC 47
SE 1/4, SW 1/4	1.4 ACRES DLC 46

SECTION 33—NE 1/4, NW 1/4 23.6 ACRES DLC 44

65.6 ACRES TOTAL

LEGEND:

- SECTION LINES
- - - FORTY LINES
- - - DONATION LAND CLAIM LINES
- - - APPROXIMATE PROPERTY LINE
- - - BURIED WATERLINE TO THE MILL SITE
- ////// AREA BEING USED UNDER PERMIT NO. 47184 APPLICATION 64514 & T-7508. 65.6 ACRES TOTAL

I J. EDWARD HENRICKS, BEING DULY SWORN AS A WATER RIGHT EXAMINER LICENSE NO. 170, HAVE PREPARED THIS MAP FOR WILLAMETTE INDUSTRIES, INC. ON THIS 3rd DAY OF SEPTEMBER 1997. THE AREAS HATCHURED REPRESENT THE AREAS BEING APPLIED TO BENEFICIAL USE..

PREPARATION OF THIS MAP IS FOR THE PURPOSE OF IDENTIFYING THE LOCATION OF THE WATER RIGHT ONLY AND HAS NO INTENT TO PROVIDE DIMENSIONS OR LOCATION OF PROPERTY OWNERSHIP LINES.

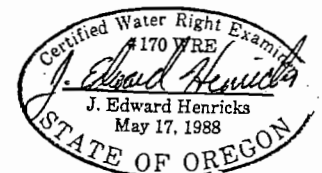

MISC-97-3349-L-01

ONLY DOCUMENTS STAMPED WITH
RED INK ARE ORIGINALS.