

SECTION 18 T3S R5W W.M.

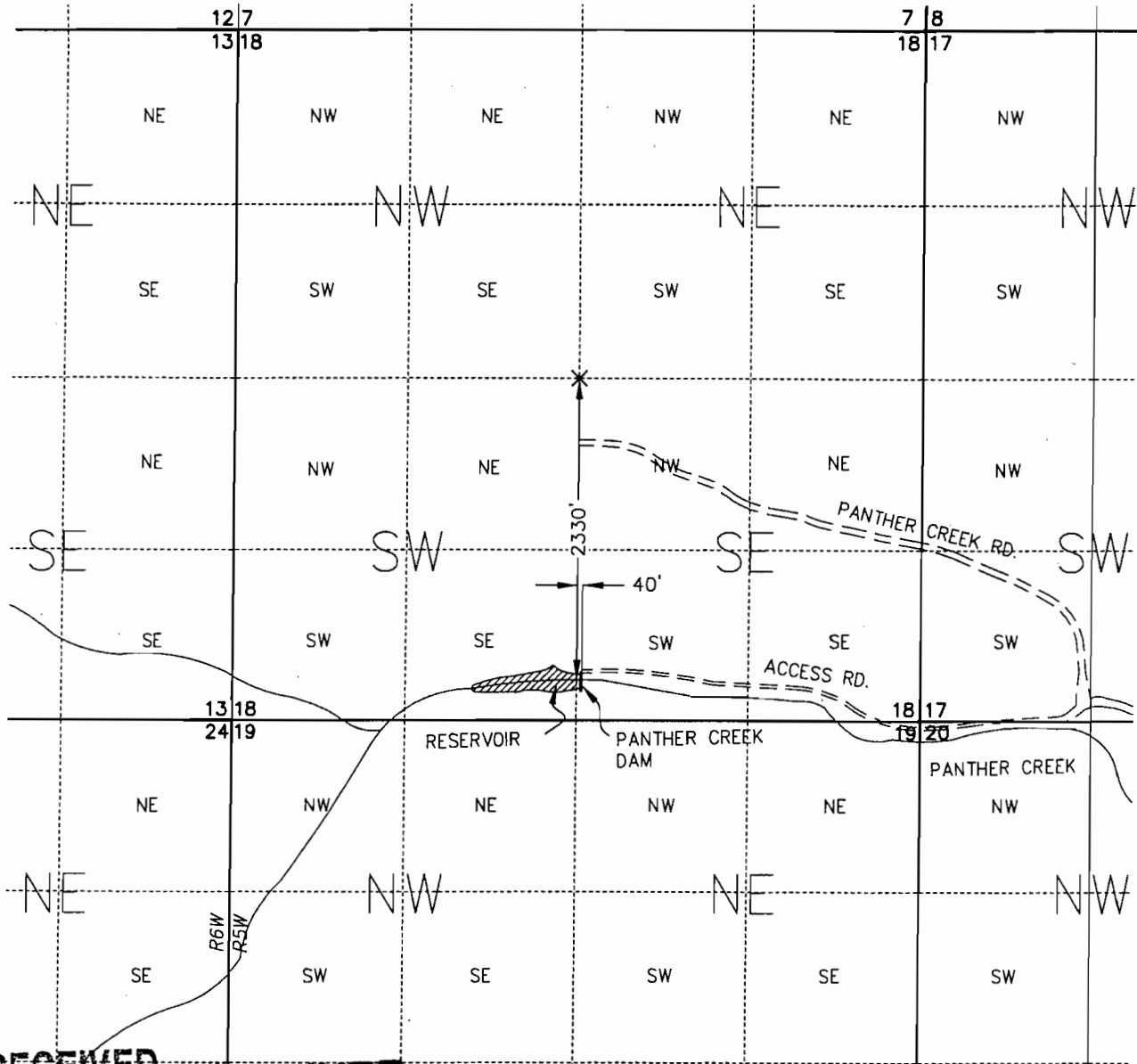

RECEIVED

AUG 12 2009

WATER RESOURCES DEPT  
SALEM, OREGON

RECEIVED

DEC 21 2004

WATER RESOURCES DEPT  
SALEM, OREGON

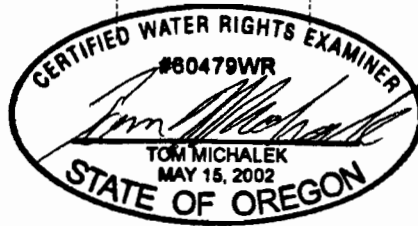

NORTH



1 inch = 1320 ft.

POINT OF DIVERSION: PANTHER CREEK DAM, LOCATED  
40' E AND 2330' S FROM THE CENTER OF SECTION 18.

THE PREPARATION OF THIS MAP WAS FOR  
THE PURPOSE OF IDENTIFYING THE LOCATION  
OF THE WATER RIGHTS AND HAS NO INTENT  
TO PROVIDE DIMENSIONS OR LOCATIONS OF  
PROPERTY OWNERSHIP LINES.

PREPARED FOR:  
CITY OF CARLTON  
P.O. BOX 452  
CARLTON, OREGON 97111

**LDC** Design Group  
Planners  
Engineers  
Surveyors  
20085 N.W. TANASBOURNE DR.  
HILLSBORO, OREGON 97124  
PHONE: (503) 856-4242  
FAX: (503) 645-5500  
www.lcdesign.com

DRAWING TITLE:  
CLAIM OF BENEFICIAL USE MAP  
APPL. R-69512  
PERMIT R-10900  
CITY OF CARLTON  
KMH

JOB NO.:  
0037.002  
DRAWING NO.:  
1 of 1