

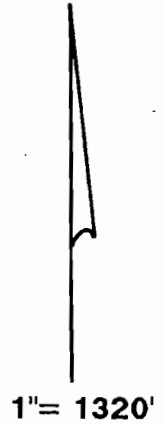

T.4S., R.1W., W.M.

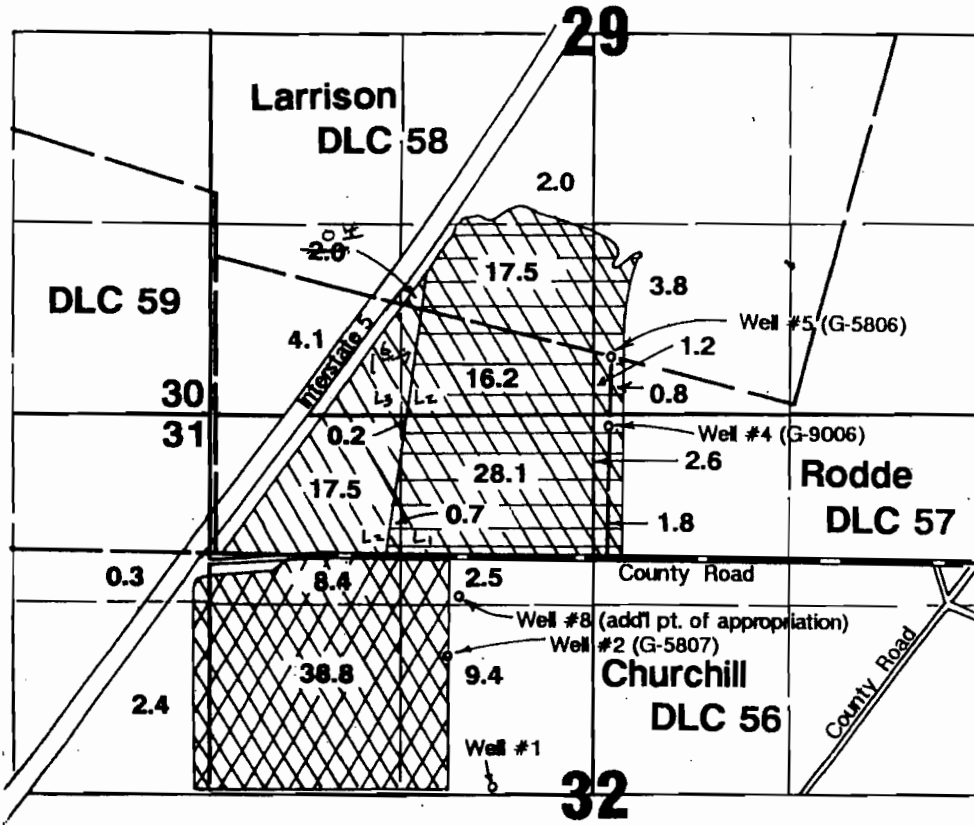
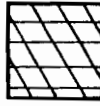

- Area Irrigated**
-  C-45551
 -  C-54710
 -  P-8387

Well #8 (add'l pt. of appropriation) located 1380'N & 920'W from center Section 32.

Final Proof Survey
Transfer #6438
 In Name Of
Tom DeArmond

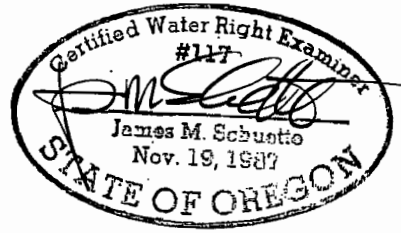

Surveyed on October 15, 1993 by JM Schuetto

Map amended by WRD's staff, 6-3-09, gwg

THIS MAP WAS PREPARED FOR THE PURPOSE OF IDENTIFYING THE LOCATION OF A WATER RIGHT ONLY AND IS NOT INTENDED TO PROVIDE LEGAL DIMENSIONS OR LOCATION OF PROPERTY OWNERSHIP LINES.