

T. 28 S., R. 11 W., W.M.

RECEIVED

SEP 28 1998

WATER RESOURCES DEPT.
SALEM, OREGON

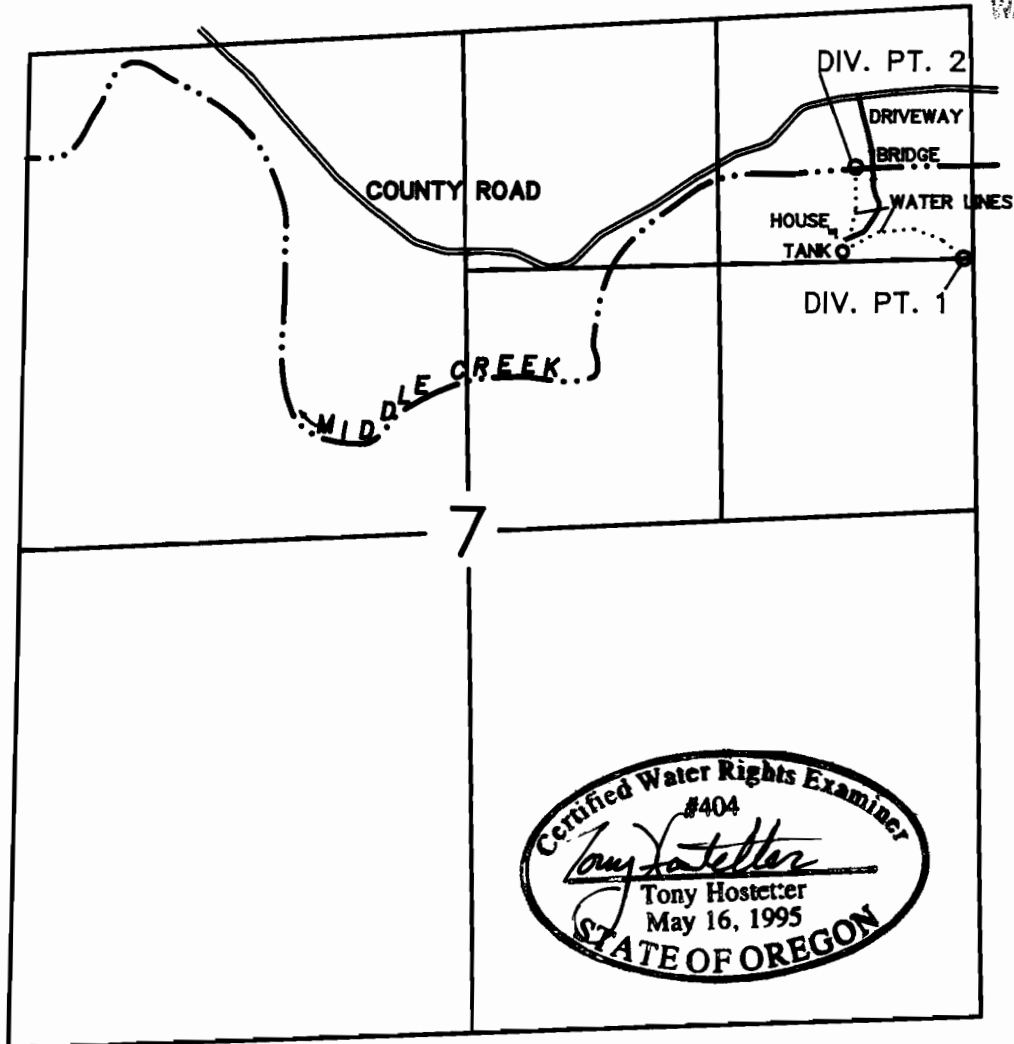

PRIMARY

DIV. PT. 1 LOCATED 0' N. & 49' W, FROM N 1/16
CORNER ON THE EAST LINE OF SECTION 7

SECONDARY

DIV. PT. 2 LOCATED 4410' N. & 680' W, FROM THE
SE CORNER OF SECTION 7

SCALE: 1" = 1000'

FINAL PROOF SURVEY

UNDER

Application No. S-76871 Permit No. 52736

IN NAME OF
DIANE TISSOT

Surveyed September 6, 1998, by T. HOSTETTER