

RECEIVED

DEC 12 1997

WATER RESOURCES DEPT.
SALEM, OREGON

T.6S., R.1W., W.M.

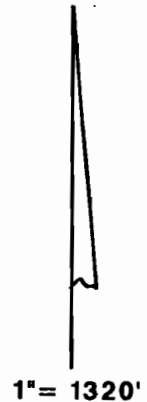
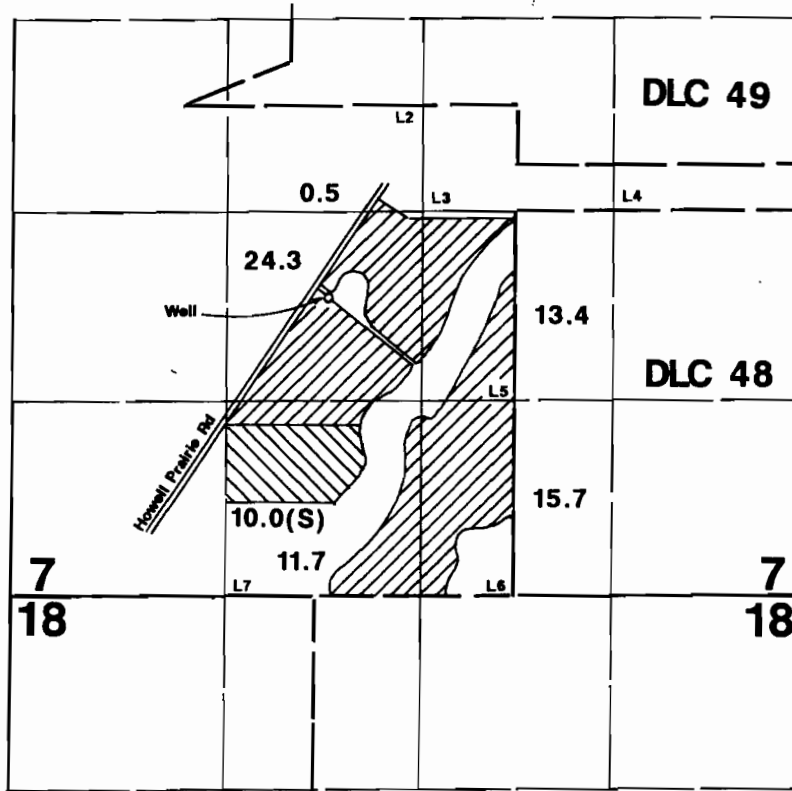

Well located 600'S & 1270'W from NW corner DLC 48.

Final Proof Survey

Application #: G-14086 Permit #: G-13042

In Name Of

Stefan Tipikin

Surveyed on November 26, 1997 by JM Schuette

THIS MAP WAS PREPARED FOR THE PURPOSE OF IDENTIFYING THE LOCATION OF A WATER RIGHT ONLY AND IS NOT INTENDED TO PROVIDE LEGAL DIMENSIONS OR LOCATION OF PROPERTY OWNERSHIP LINES.

