

T 6 S, R 3 W, WM

MARION COUNTY, OREGON

11

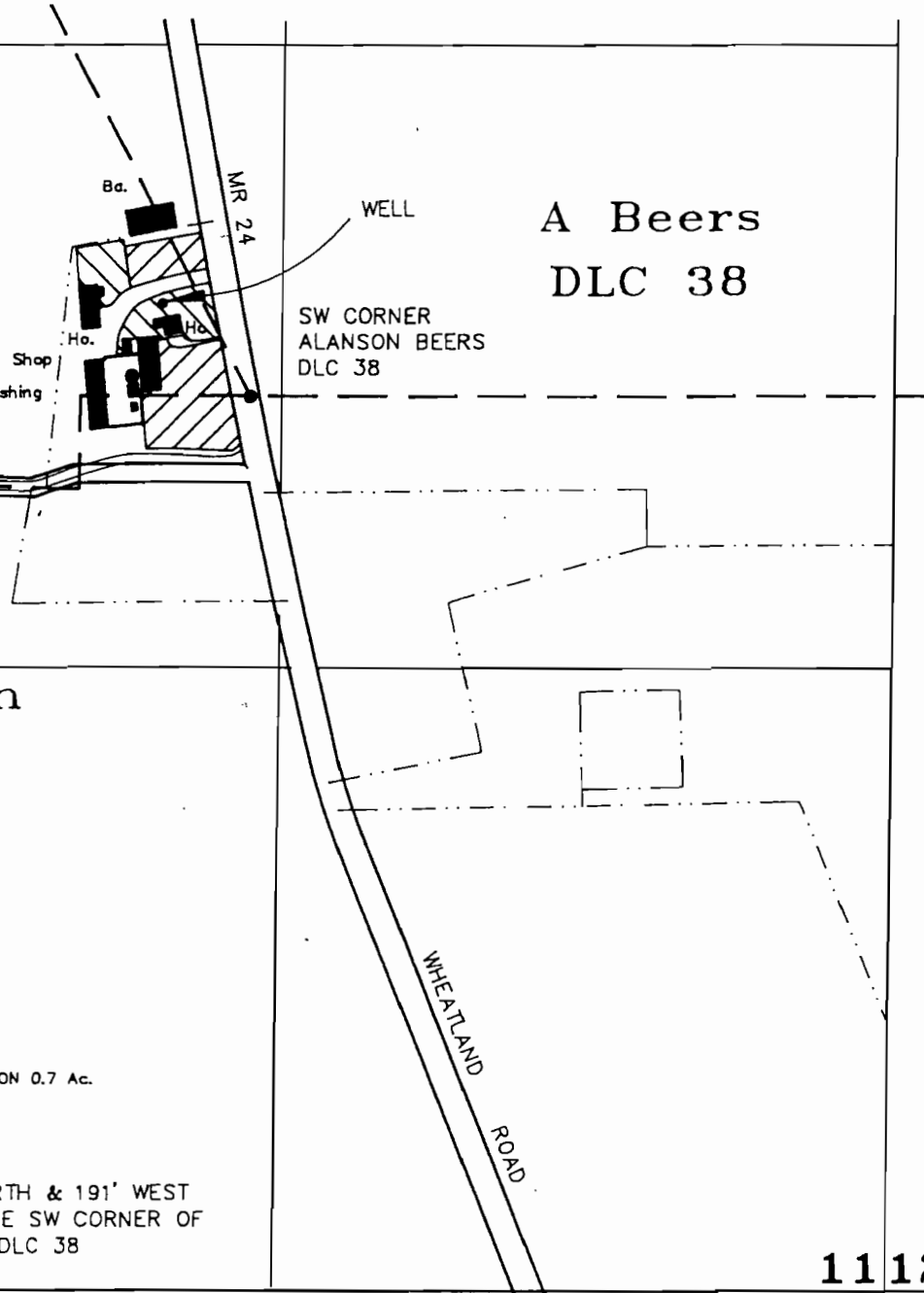

Lot 2



J Durbin
DLC 60



LEGEND

-  BUILDINGS
-  SUPPLEMENTAL IRRIGATION 0.7 Ac.
-  NURSERY 1.2 Ac.

DIV. PT. WELL: 197' NORTH & 191' WEST
FROM THE SW CORNER OF
BEERS DLC 38

11 12
14 13

FINAL PROOF SURVEY

Application No. G-13786 UNDER G-12437 Permit No. G-11528 *709*
 in the name of
Bruce Chapin

Surveyed: NOVEMBER 27, 1997

Scale: 1" = 400'

RECEIVED

APR 06 1998

WATER RESOURCES DEPT.
SALEM, OREGON

NOTE

THIS MAP IS FOR THE PURPOSE OF
IDENTIFYING THE LOCATION OF WATER RIGHTS
AND HAS NO INTENT TO DIMENSION OR LOCATE
PROPERTY OWNERSHIP LINES.

