

T.6S., R.4W., W.M.

RECEIVED
JUL 09 2008
LAND DIVISION
Salem, Oregon

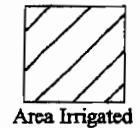
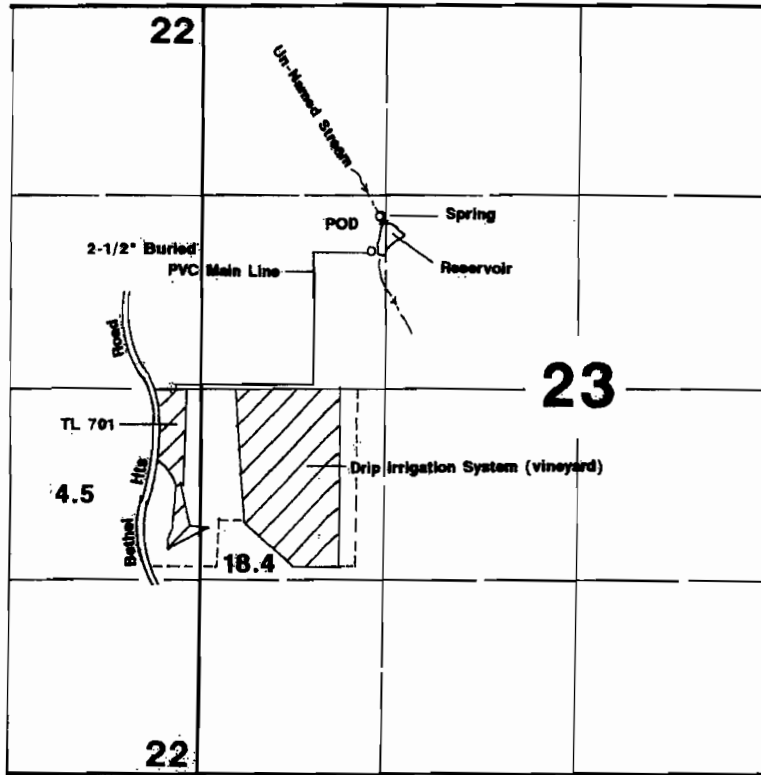

Spring is located 1180'N & 1260'E
POD is located 930'N & 1240'E-----both from the W1/4 corner of Section 23.

Final Proof Survey

In the Name of

Bethel Heights Vineyard

Transfer #: T-8793

Surveyed on November 26, 2008 by JM Schuette

This Map was Prepared for the Purpose of Identifying the Location of a Water Right Only and is Not Intended to Provide Legal Dimensions or Location of Property Ownership Lines.

