

T.4S. R.3W. Section 4, W.M.

33 34
4 3

RECEIVED

JUL 16 2009

WATER RESOURCES DEPT
SALEM, OREGON

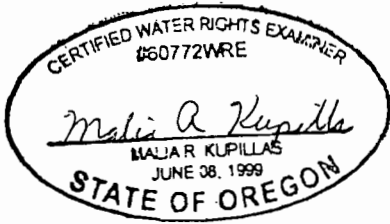
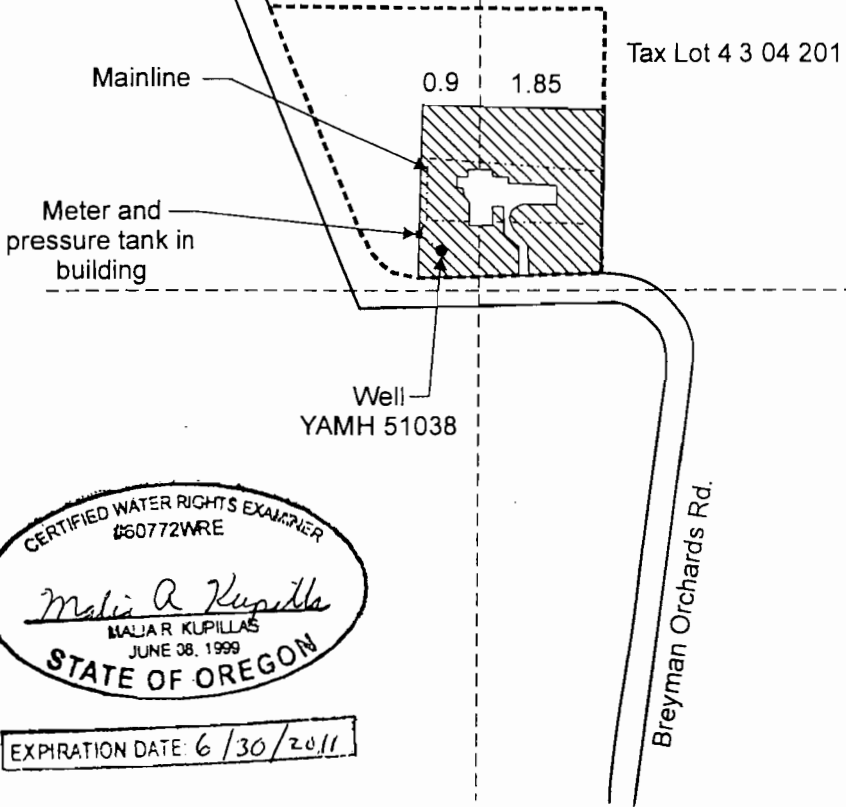

EXPIRATION DATE 6/30/2011

Well is located 1,270 feet south and 1,400 feet west from the NE corner of Section 4.

Area (2.7 Acres) irrigated under Application G-15270, Permit G-15057.

----- Tax lot boundary

- - - - - Mainline

Scale: 1" = 400'

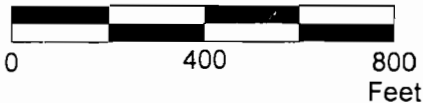

This map was prepared for the purpose of identifying the location of a water right only and is not intended to provide legal dimensions or location of property ownership lines.

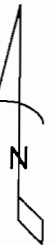

Claim of Beneficial Use Map
Application G-15270, Permit G-15057

Pacific Hydro-Geology Inc.

Kenneth F. and Katherine F. Durant