

THIS MAP WAS PREPARED FOR THE PURPOSE OF IDENTIFYING THE LOCATION OF THE WATER RIGHT AND IS NOT INTENDED TO PROVIDE LEGAL DIMENSIONS OR LOCATIONS OF PROPERTY OWNERSHIP LINES.

T34S; R7E 7.5E

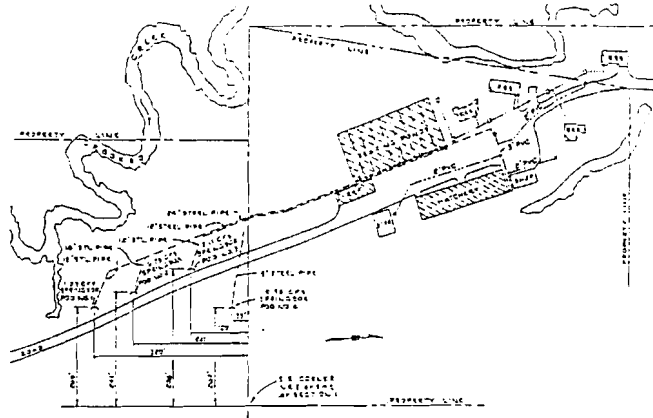

SCALE: 1" = 400'

SPRING NO. 1	LOCATED	209'	^S	&	320'	W	} FROM S.E. COR. NE 1/4 OF SW 1/4 OF SEC. 1
"	" 2	"	241'	"	241'	"	
"	" 3	"	288	"	120'	"	
"	" 4	"	207	"	35	"	

FINAL PROOF SURVEY

UNDER

APPLICATION NO. S-71758 PERMIT NO. 53345

IN NAME OF

OREGON DEPARTMENT OF FISH AND WILDLIFE

SURVEYED: 6/2/98

BY: DODGE

Map amended by WAD Staff, 7-21-2009 JWS