

RECEIVED

JUL 17 1998

T. 7 & 8 S., R. 3 W. W.M.

WATER RESOURCES DEPT  
SALEM, OREGON

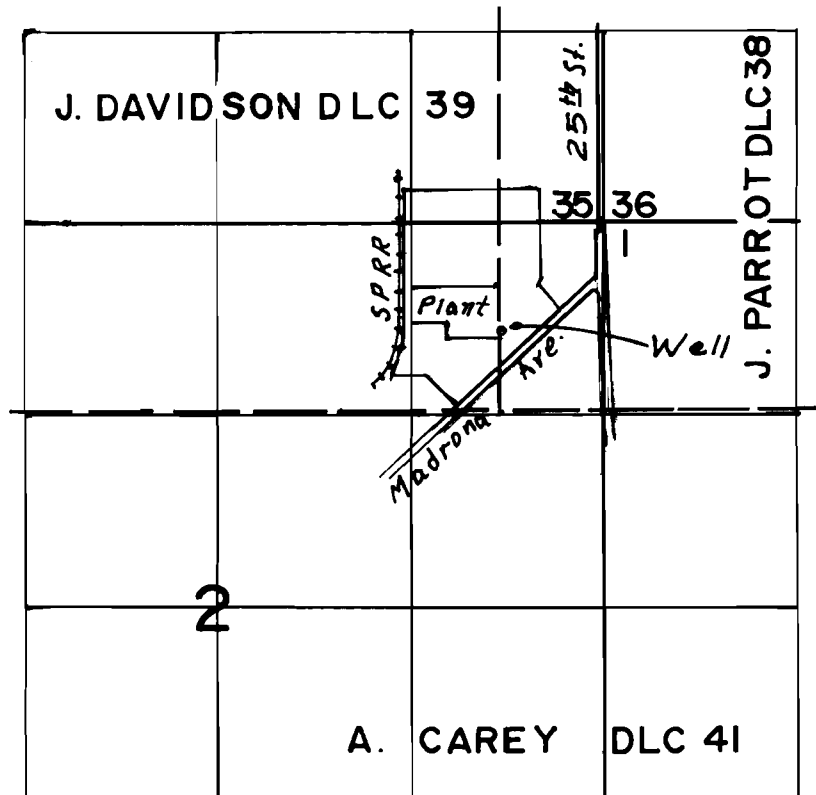

Well loc. 560' N & 10' E from SW Cor. DLC 38

**FINAL PROOF SURVEY**  
UNDER

Application No. *G-19235* Permit No. *G-13062...*

IN NAME OF

..... **NORPAC FOODS, INC.** .....

Surveyed *June 2, 1998*, by .....

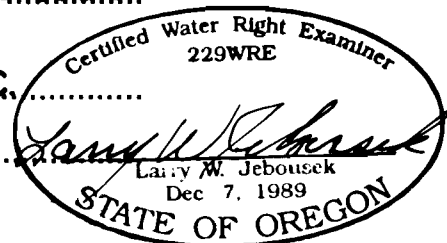

THIS MAP WAS PREPARED FOR THE PURPOSE OF IDENTIFYING THE LOCATION OF A WATER RIGHT ONLY AND IS NOT INTENDED TO PROVIDE LEGAL DIMENSIONS OR LOCATION OF PROPERTY OWNERSHIP LINES.