

T. 9 S., R. 3 W., W. M.

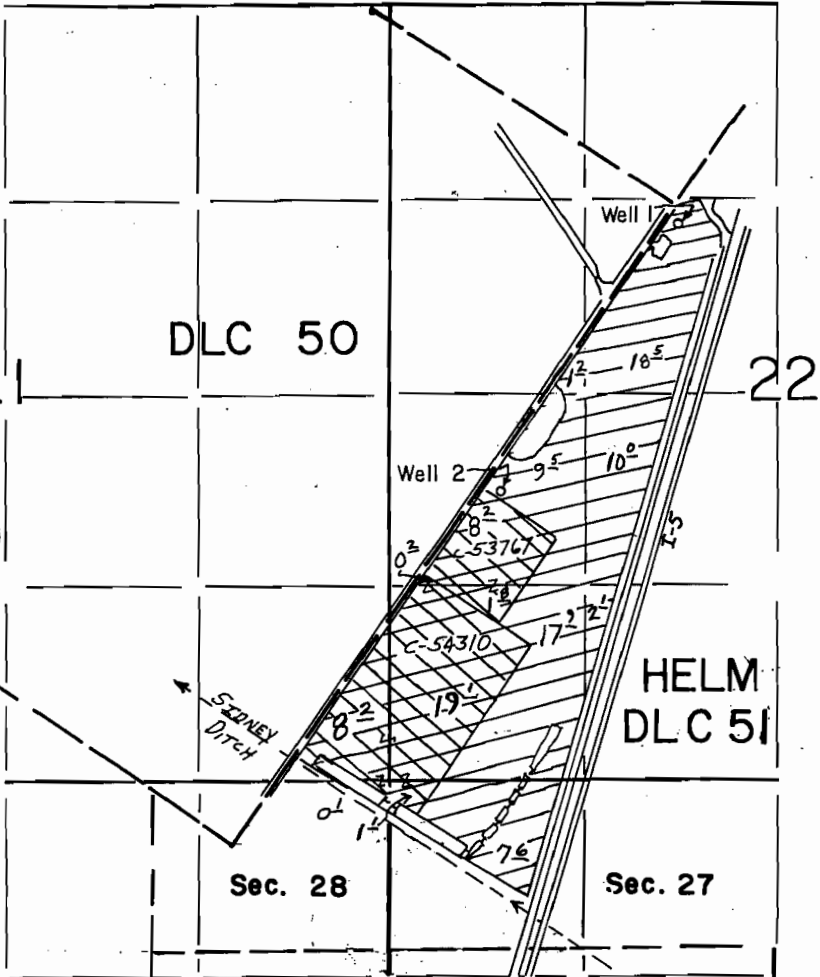

SCALE
1" = 1320'



Certified Water Right Examiner
#139
Thompson M. Warren
Thompson M. Warren
Nov. 19, 1987
STATE OF OREGON
EXPIRES 6-30-2000

Well 1 Loc.: 150' S. & 10' E. from NE Cor. DLC 50
Well 2 Loc.: 2400' N & 1840' E. from SE Cor. DLC 50

THIS MAP WAS PREPARED SOLELY FOR
THE PURPOSE OF DEPICTING THE LOCATION
OF A WATER RIGHT, AND HAS NO INTENTION
OF BEING USED TO DETERMINE REAL
PROPERTY BOUNDARIES.

AGRICULTURE USE
("NURSERY OPERATIONS")
&
SUPPLEMENTAL IRRIGATION

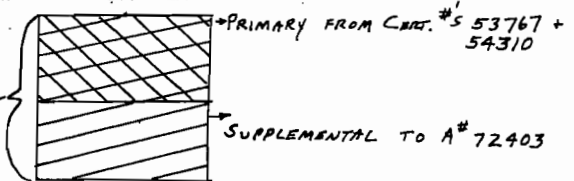

FINAL PROOF SURVEY
UNDER

App. G-12913 Permit G-11671

HAROLD M. MILLER

Surveyed 9/19/98 by T.M. Warren

RECEIVED

SEP 29 1998

WATER RESOURCES DEPT.
SALEM, OREGON