

RECEIVED

SEP 18 1998

RESOURCES DEPT.
SALEM, OREGON

TOWNSHIPS 4 & 5 SOUTH, RANGE 1 WEST, W.M.

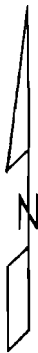
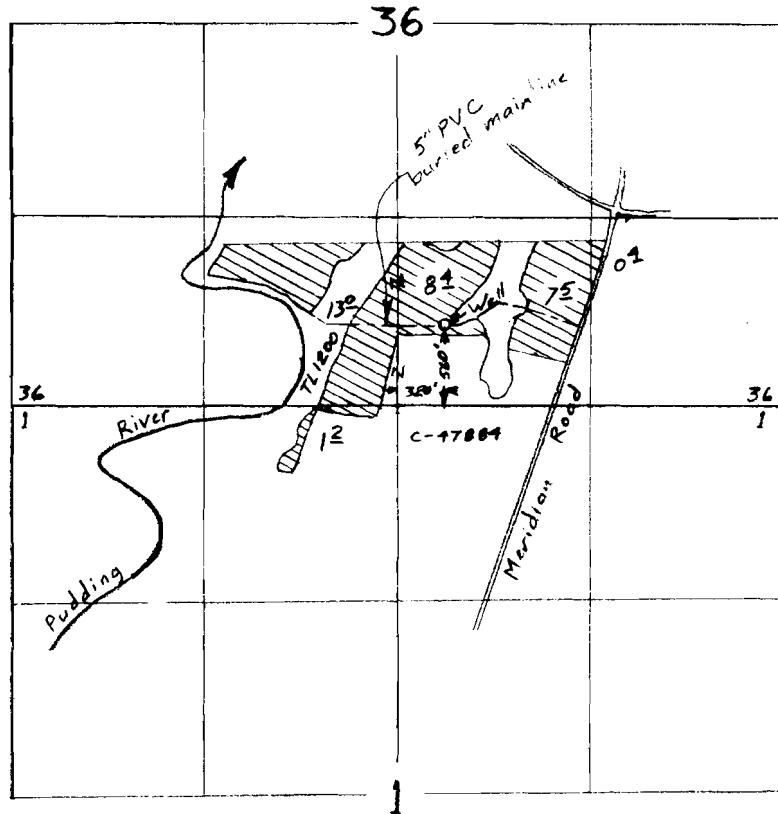

Scale 1" = 1320'

Surveyed August 7, 1996 & June 10, 1998

Claim of Beneficial Use Map

for

IVAN & ZINA SNEGIREV

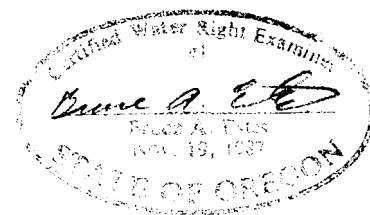

Application G-13230

Permit G-11877

This map is for the purpose of locating a water right only and has no intent to provide legal dimensions or the location of property lines.

ESTES SURVEYS
 6293 Sunnyview Rd. NE 60382 Arnold Rd.
 Salem, OR 97305 Bend, OR 97702
 (503) 585-7593 (503) 382-7391