

T.27S. R.6W. W.M.

RECORDED
MAP
SALE 27 1997

SCALE 1 INCH = 1320'

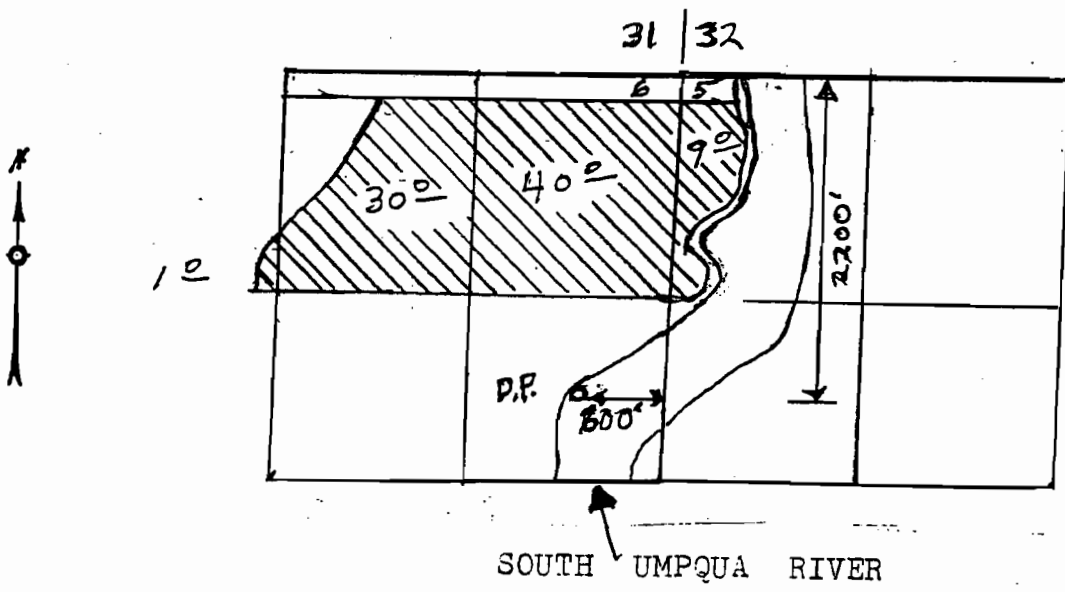

THE PURPOSE OF THIS MAP IS TO IDENTIFY THE LOCATION OF THE WATER RIGHT. IT IS NOT INTENDED TO PROVIDE INFORMATION RELATIVE TO THE LOCATION OF PROPERTY OWNERSHIP BOUNDARY LINES.

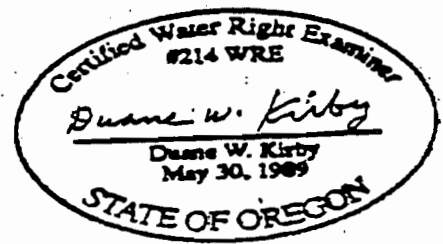

FINAL PROOF SURVEY UNDER

Application No- 81134 Permit No. 53193
IN NAME OF
WAYNE PARKER
Surveyed SEPT 3 19 97 by DUANE KIRBY

Township 31 South Range 4 West W.M.

N
SCALE
1" = 1320'

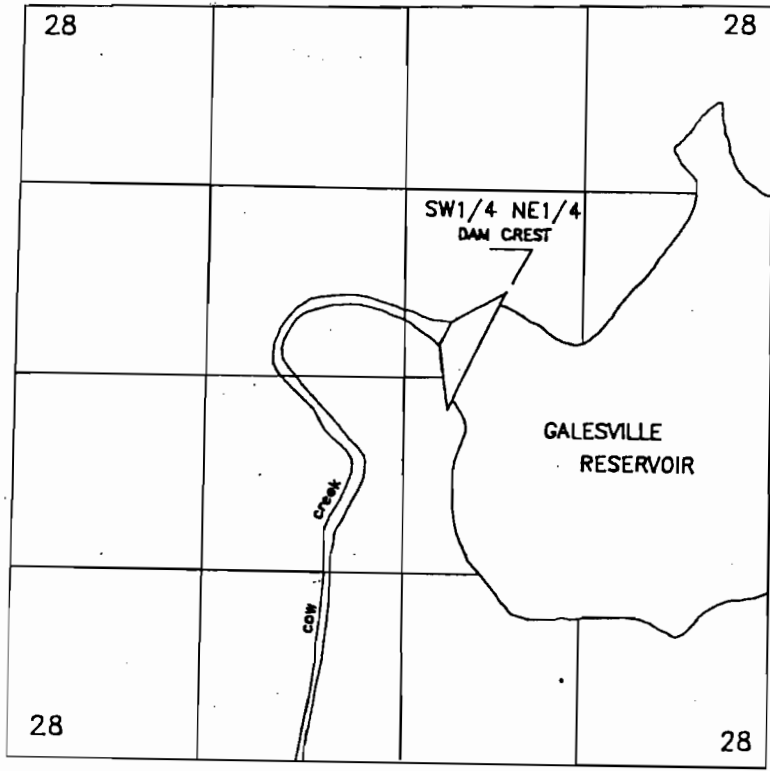

GALESVILLE PROJECT
Douglas County, Oregon
Contract No: _____

Point of Diversion:
2,920'N.; 2,060'W
From SE Cor. Sec.28
Within Township 31 South
Range 4 West W.M.

RECEIVED

APR 18 1996

WATER RESOURCES DEPT.
SALEM, OREGON

Dam (Pod)=2920'N.;2060'w. From S.E. Cor. Sec. 28