

1737

MAP

Accompanying application of NELSON NYE, ELSIE PHIPPS, C.W. C.D., and CLEM CLARKE of Prospect, and E.H. HURD of Medford, Jackson County, Oregon. for permit to the waste waters, at No 2 Intake and waters of North Fork of Rogue River at No 1 Intake at points designated on this plat in Jackson County, Oregon. for the purpose of irrigation. October 1923.

Map made from notes of an actual survey in the field by myself, the same correctly showing, points of Intakes, Course of ditch, lands to be irrigated, together with streams and ditches, in immediate vicinity.

Fred. N. Cummings. C.E.

STATE ENGINEER RECEIVED

OCT 22 1923

SALEM, OREGON

Tp325R2E. Tp335R2E.

Tp325R3EW.M Tp335R3EWM

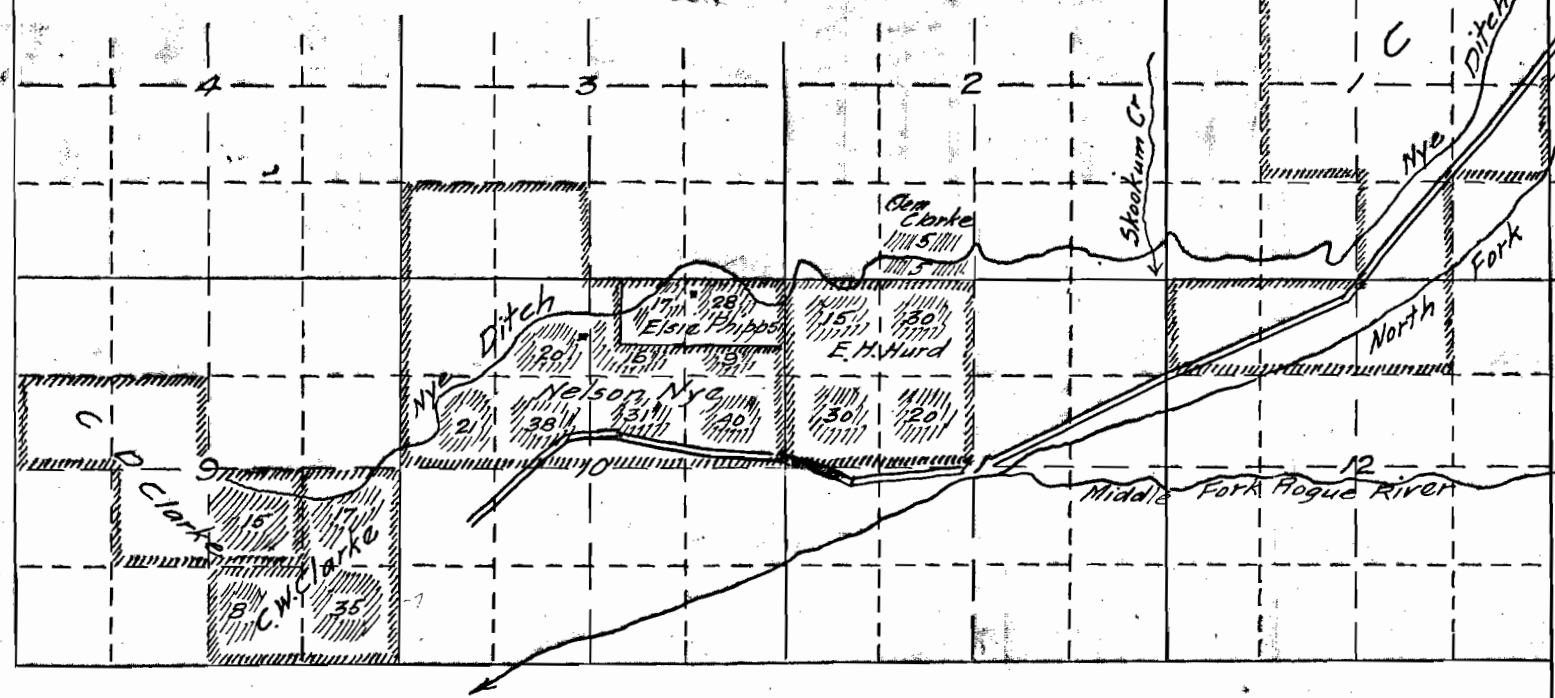

Application No. 7371  
Permit No. 6119

Amended Maps.

Fred. N. Cummings  
STATE ENGINEER  
OCT 22 1923

1737