

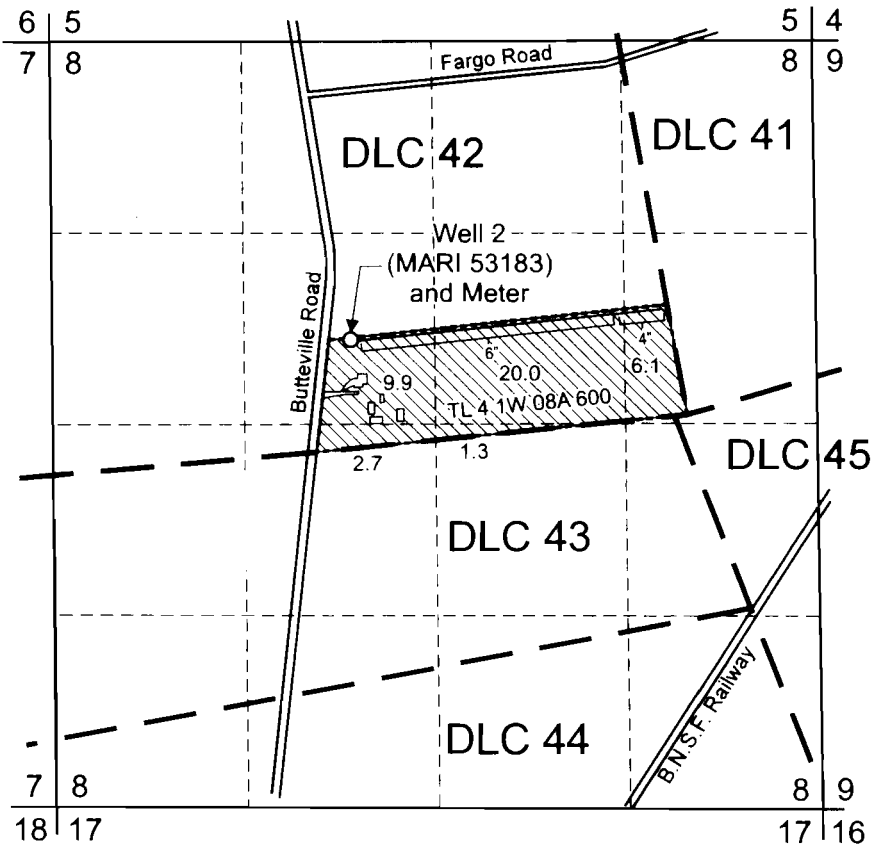



T.4S. R.1W. Section 8, W.M.



Well 2 (MARI 53183) is located 590 feet north and 2,030 feet east from the W 1/4 corner, Section 8.

 Area (40.0 Acres) irrigated under Application G-16963, Permit G-16412.

 Tax lot boundary

 6" Irrigation main line

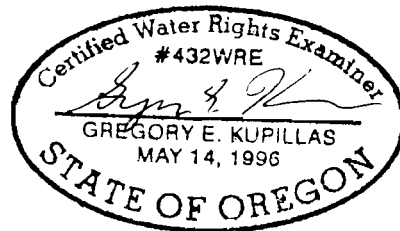

EXPIRATION DATE: 6/30/2011

Scale: 1" = 1,320'



This map was prepared for the purpose of identifying the location of a water right only and is not intended to provide legal dimensions or location of property ownership lines.



Pacific Hydro-Geology Inc.

Claim of Beneficial Use Map
Application G-16963, G-16412

F. John Rissberger
T4S, R1W, Section 8, W.M.

9/2009