

T. 16 S., R. 43 E., W.M.

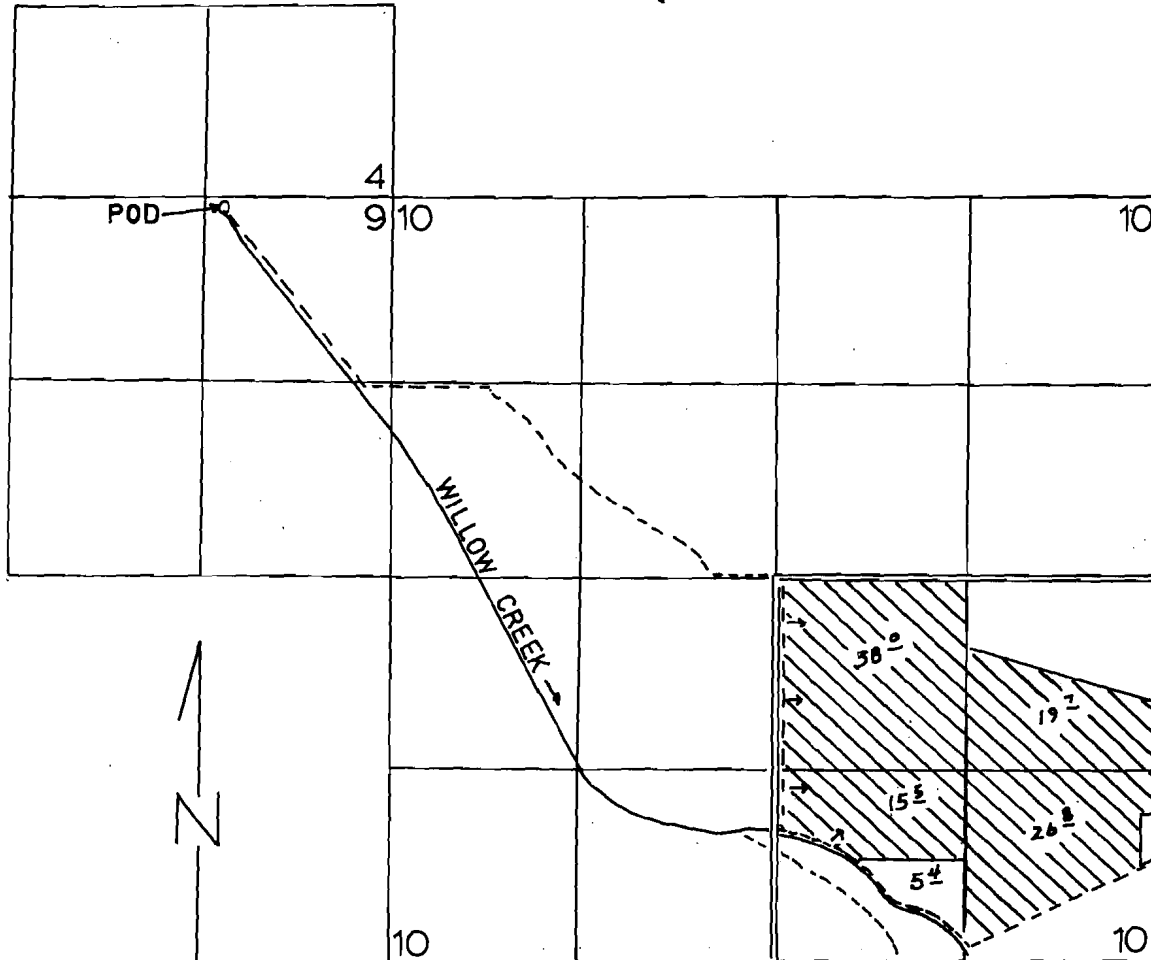

POD - 30' S. & 1190' W. OF THE NE COR. SECTION 9.

1" = 1320'

FINAL PROOF SURVEY

UNDER

Application No. 56200 Permit No. 50180
IN NAME OF

EMIL MAAG

Surveyed AUGUST 13, 1993, by L. MILLER

RECEIVED

AUG 26 2002

**WATER RESOURCES DEPT.
SALEM, OREGON**