

CORRUPT MAP # 0475-

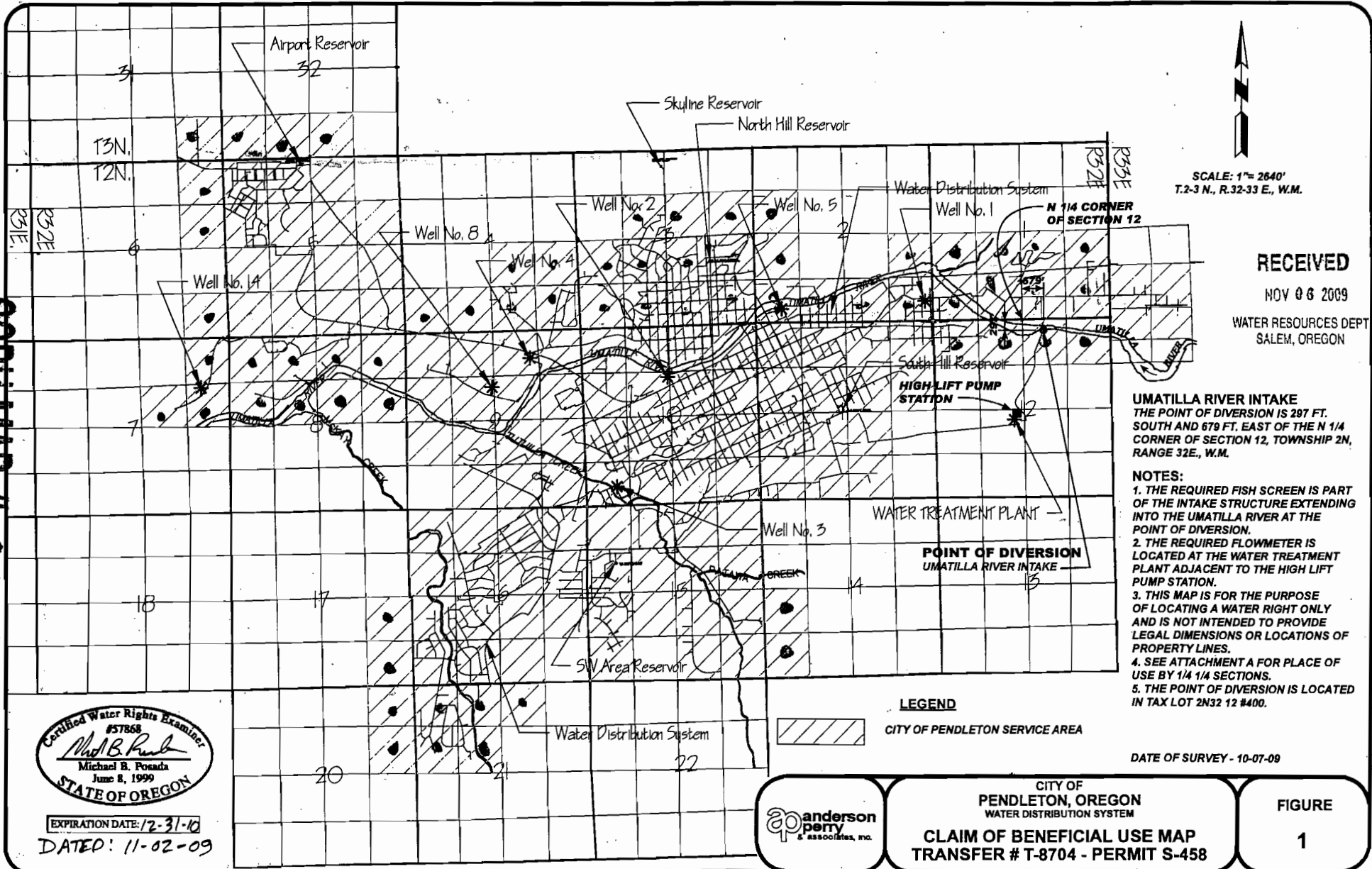

SCALE: 1" = 2640'
T.2-3 N., R.32-33 E., W.M.

RECEIVED
NOV 06 2009
WATER RESOURCES DEPT
SALEM, OREGON

UMATILLA RIVER INTAKE
THE POINT OF DIVERSION IS 297 FT.
SOUTH AND 679 FT. EAST OF THE N 1/4
CORNER OF SECTION 12, TOWNSHIP 2N,
RANGE 32E., W.M.

- NOTES:**
1. THE REQUIRED FISH SCREEN IS PART OF THE INTAKE STRUCTURE EXTENDING INTO THE UMATILLA RIVER AT THE POINT OF DIVERSION.
 2. THE REQUIRED FLOWMETER IS LOCATED AT THE WATER TREATMENT PLANT ADJACENT TO THE HIGH LIFT PUMP STATION.
 3. THIS MAP IS FOR THE PURPOSE OF LOCATING A WATER RIGHT ONLY AND IS NOT INTENDED TO PROVIDE LEGAL DIMENSIONS OR LOCATIONS OF PROPERTY LINES.
 4. SEE ATTACHMENT A FOR PLACE OF USE BY 1/4 1/4 SECTIONS.
 5. THE POINT OF DIVERSION IS LOCATED IN TAX LOT 2N32 12 #400.

LEGEND
CITY OF PENDLETON SERVICE AREA

DATE OF SURVEY - 10-07-09

Certified Water Rights Examiner
#57868
Michael B. Posada
Michael B. Posada
June 8, 1999
STATE OF OREGON

EXPIRATION DATE: 12-31-10
DATED: 11-02-09

ap anderson
perry
& associates, inc.

CITY OF
PENDLETON, OREGON
WATER DISTRIBUTION SYSTEM
CLAIM OF BENEFICIAL USE MAP
TRANSFER # T-8704 - PERMIT S-458

FIGURE
1