

RECEIVED

APR 9 1993

WATER RESOURCES DEPT
SALEM, OREGON

T.4S., R.1W., W.M.

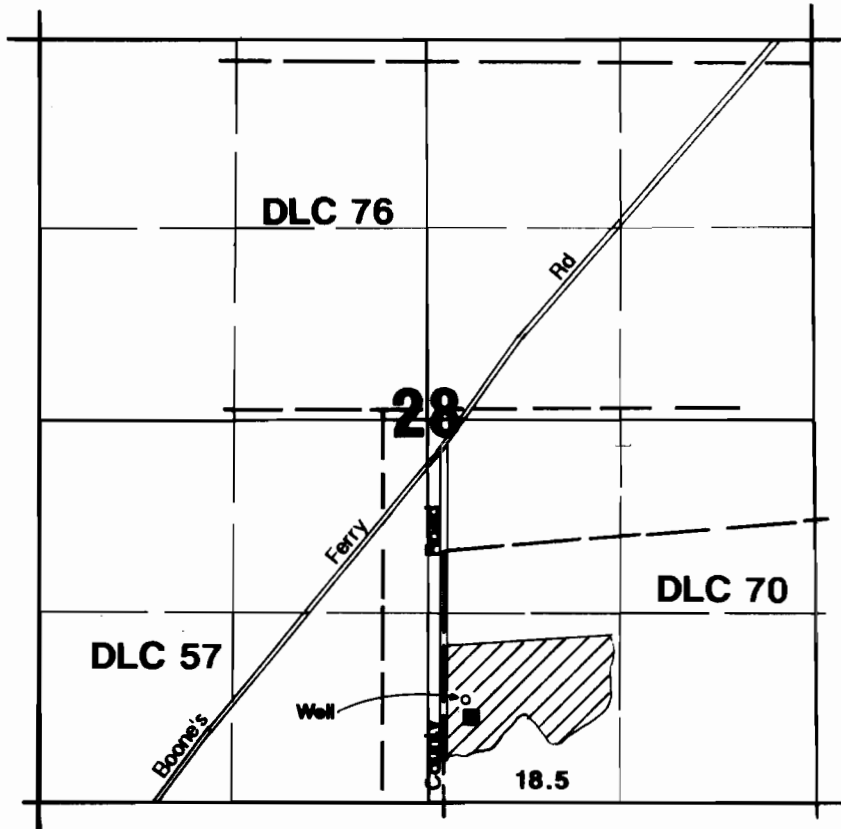

Well located 710'N & 285'E from SW cor. SE1/4 Section 28.

Final Proof Survey

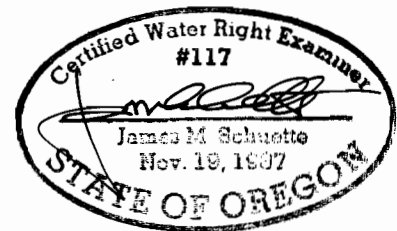

Application #G-12100 Permit #G-11386

In Name Of

Ray Doubrava

Surveyed on March 31, 1993 by JM Schuette

NOTE: Map is for the purpose of identifying location of water right and has no intent to dimension or locate property ownership lines.