

**Claim of Beneficial Use  
Point of Diversion Map  
Partial Perfection of: Permit S-50218 (Application S-69513)  
Township 3 South, Range 5 West (W.M.)**

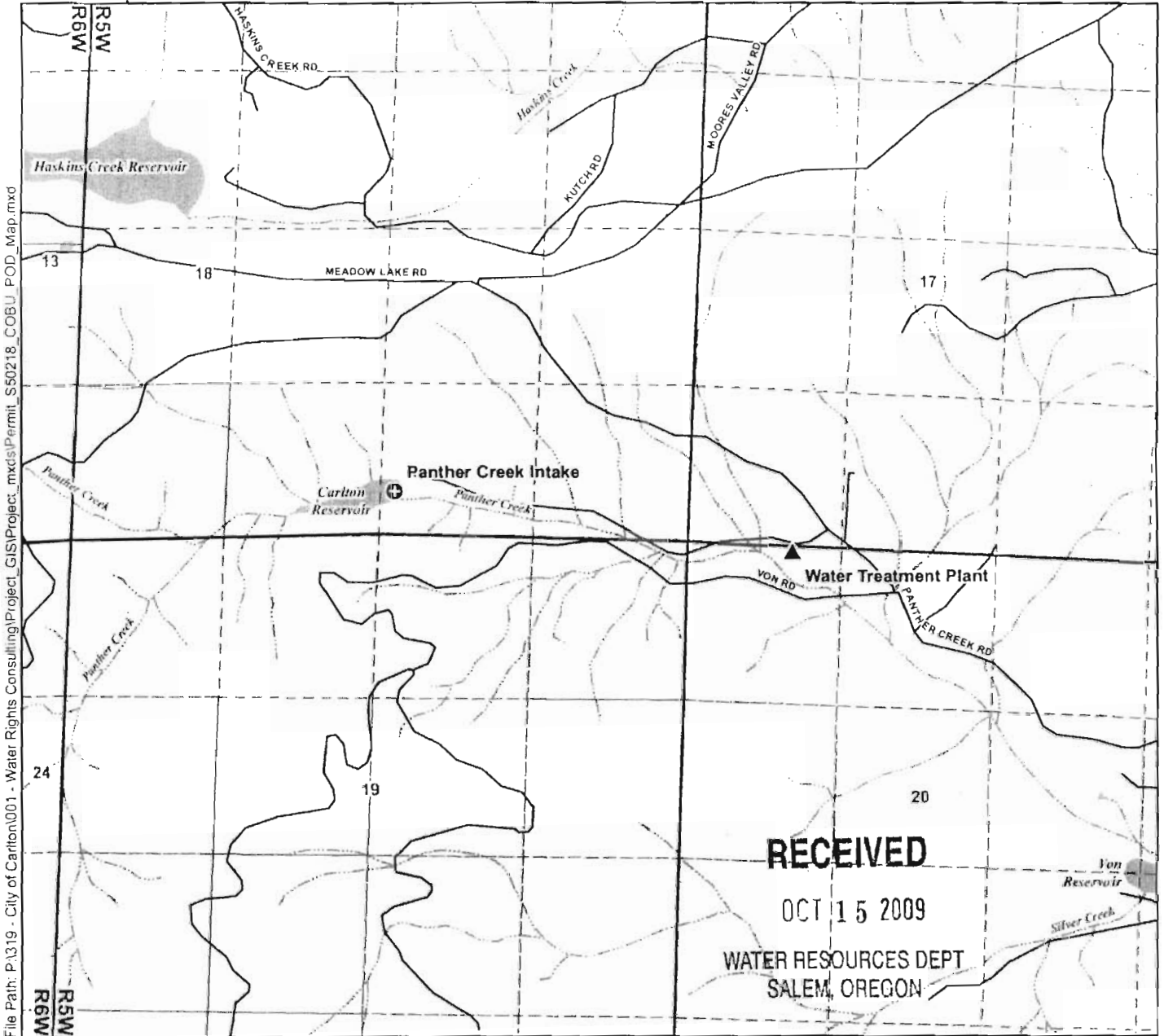

File Path: P:\319 - City of Carlton\001 - Water Rights Consulting\Project\_GIS\Project\_mxd\Permit\_S50218\_COBU\_POD\_Map.mxd

**RECEIVED**

OCT 15 2009

WATER RESOURCES DEPT  
SALEM, OREGON

**Legend**

- Point of Diversion (POD)
- Flow Meter
- Waterbodies
- Watercourses
- Roads

**POD Location Description**

Panther Creek Intake  
Located 360 feet North and 2460 feet West from the SE corner of Section 18, Township 3 South, Range 5 West (W.M.)

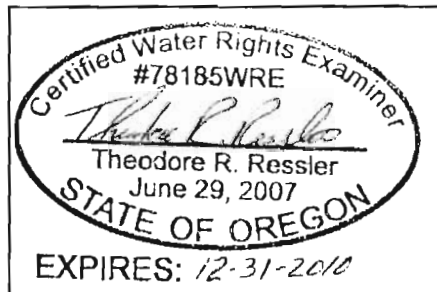

CWRE Stamp and Signature

**Map Information**

Projection: Oregon State Plane North Zone  
Datum: North American Datum of 1983  
Date: August 10, 2009  
Prepared By: GSI Water Solutions, Inc.

**Data Sources**

City of Carlton, OWRD, ESRI,  
Oregon Geospatial Data Clearinghouse

**Disclaimer**

This map was prepared for the purpose of identifying the location of a water right only and it is not intended to provide legal dimensions or location of property ownership lines.

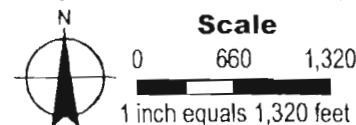

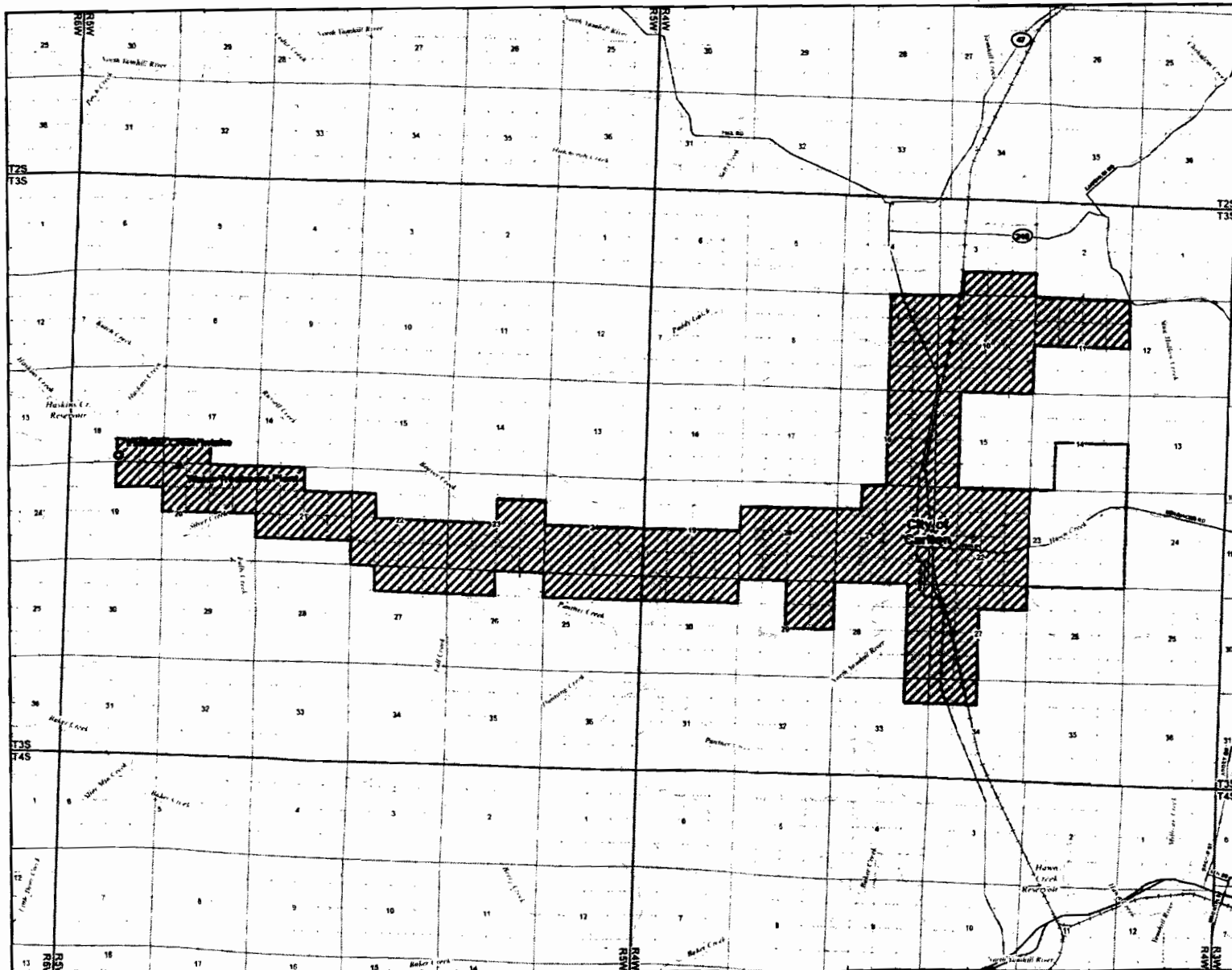

**Claim of Beneficial Use  
Place of Use Map  
Partial Perfection of  
Permit S-00218  
(Application S-00513)  
Township 3 South,  
Ranges 4 & 5 West (W.M.)**

**Legend**

- Point of Diversion (POD)
- ▲ Flow Meter
- ▨ Place of Use (POU)
- Service Area
- Waterbody
- ~~~~ Watercourse
- ≡ Freeways and Highways
- ≡ Major Roads
- Railroads

**RECEIVED**

OCT 15 2009

WATER RESOURCES DEP.  
SALEM, OREGON



CWRE Stamp and Signature

**DISCLAIMERS:**

1. This map was prepared for the purpose of identifying the location of a water right only and it is not intended to provide legal dimensions or location of property ownership lines.
2. Under the provisions of ORS 540.510(3) the City of Carlton may lawfully provide and use water in locations other than those described.

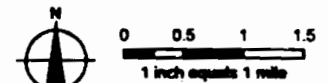

**MAP NOTES:**

Projection: Oregon State Plane North Zone  
Datum: North American Datum of 1983  
Date: January 29, 2009  
Scale Sources: GDSM, ESRI, Oregon Department of State Geology, City of Carlton

