

Water Right Transfer Map from C#31682 & C#35746 & C#36709  
**RECEIVED** T39S, R5W, WM, JOSEPHINE COUNTY  
 SW1/4 of Section 4  
 February 15, 2008

MAR 13 2008

N  
 1"=400'

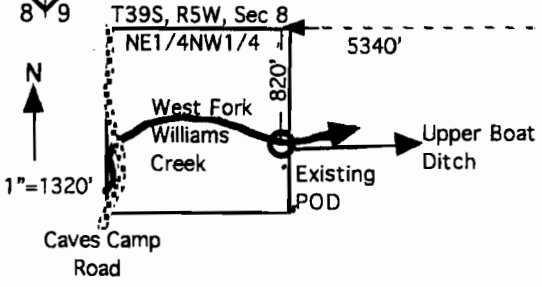
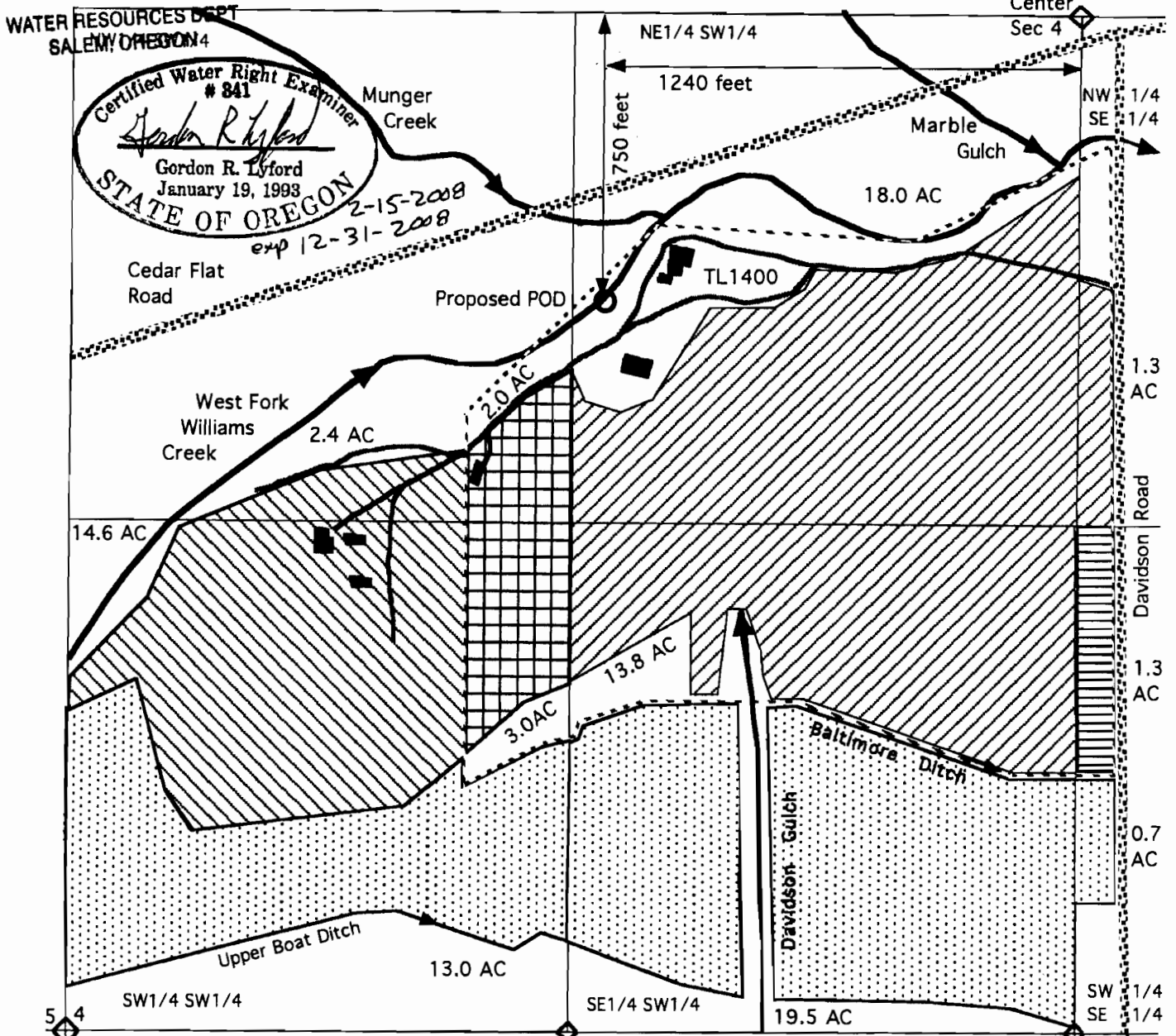

- Transfer POD under C#36709 with a priority of April 1900 Rogue River Decree
- Transfer POD under C#31682 with a priority of July 17, 1946 Application S-21807 and Permit S-17159
- Transfer POD under C#35746 with a priority of May 19, 1964 Application S-39868 and Permit S-29675
- Remaining rights under C#31682
- Remaining rights under C#35746

This map was drawn by Gordon R. Lyford for Tom Anthony & Angela Lathrop to support their application for a water right transfer to change the point of diversion on the West Fork Williams Creek. They own tax lot 1400.  
 This map was prepared for the purpose of identifying the location of water rights only and is not intended to provide legal dimensions or the location of property ownership lines.