

# Claim of Beneficial Use

## Permit S-43135 (Application S-57295)

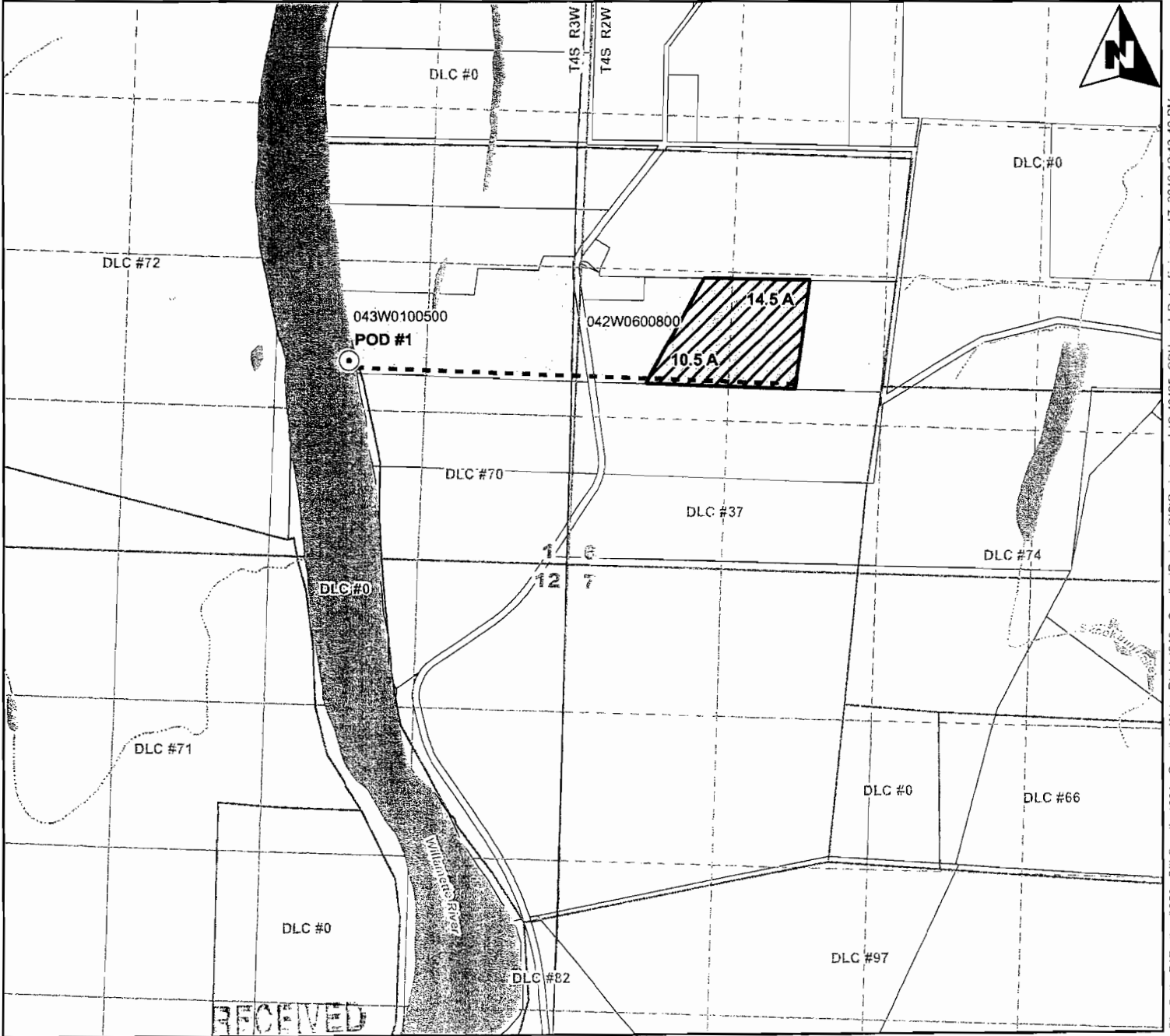

File Path: P:\Portland\350 - Bill Gooding\001 - Gooding Water Rights\046 - Gooding\Project\_GIS\Project\_mxd\350 - CBU.mxd, Date: February 17, 2010 12:13:40 PM.

### Legend

- Point of Diversion
- Water Line
- ▨ Place of Use
- ☁ Waterbodies
- ~ Watercourses
- DLC
- Taxlots
- Taxlots Appurtenant to Water Right

### POD Legal Description

**POD #1:** Located 1750 ft North and 2000 ft West from the Southeast corner of Section 1, Township 4 South, Range 3 West (WM)

FEB 9 2 2010

WA WATER RESOURCES DEPT  
SALEM, OREGON

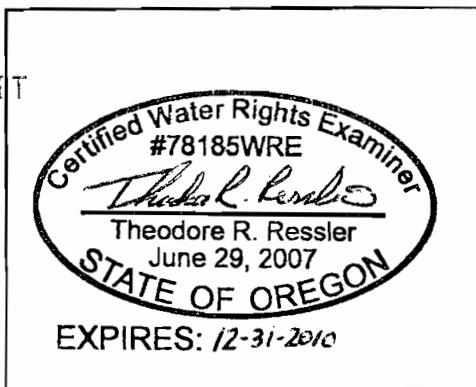

CWRE stamp and signature

This map was prepared for the purpose of identifying the location of a water right only and it is not intended to provide legal dimensions or location of property ownership lines.

Map Projection: Oregon Statewide Lambert Conformal Conic  
 Map Datum: North American Datum 1983  
 Map Date: February 17, 2010  
 Prepared by: Groundwater Solutions, Inc.  
 Data Source: Taxlot coverage provided by Marion County

**Scale** 1 inch = 1,320 feet

0 330 660 1,320

