

MAP

Accompanying application of J. L. WEIDE of Route 1
Rogue River, Jackson County, Oregon, for permit to the
waters of Evans Creek Jackson County, Oregon for
Irrigation use.

February 23rd 1926.

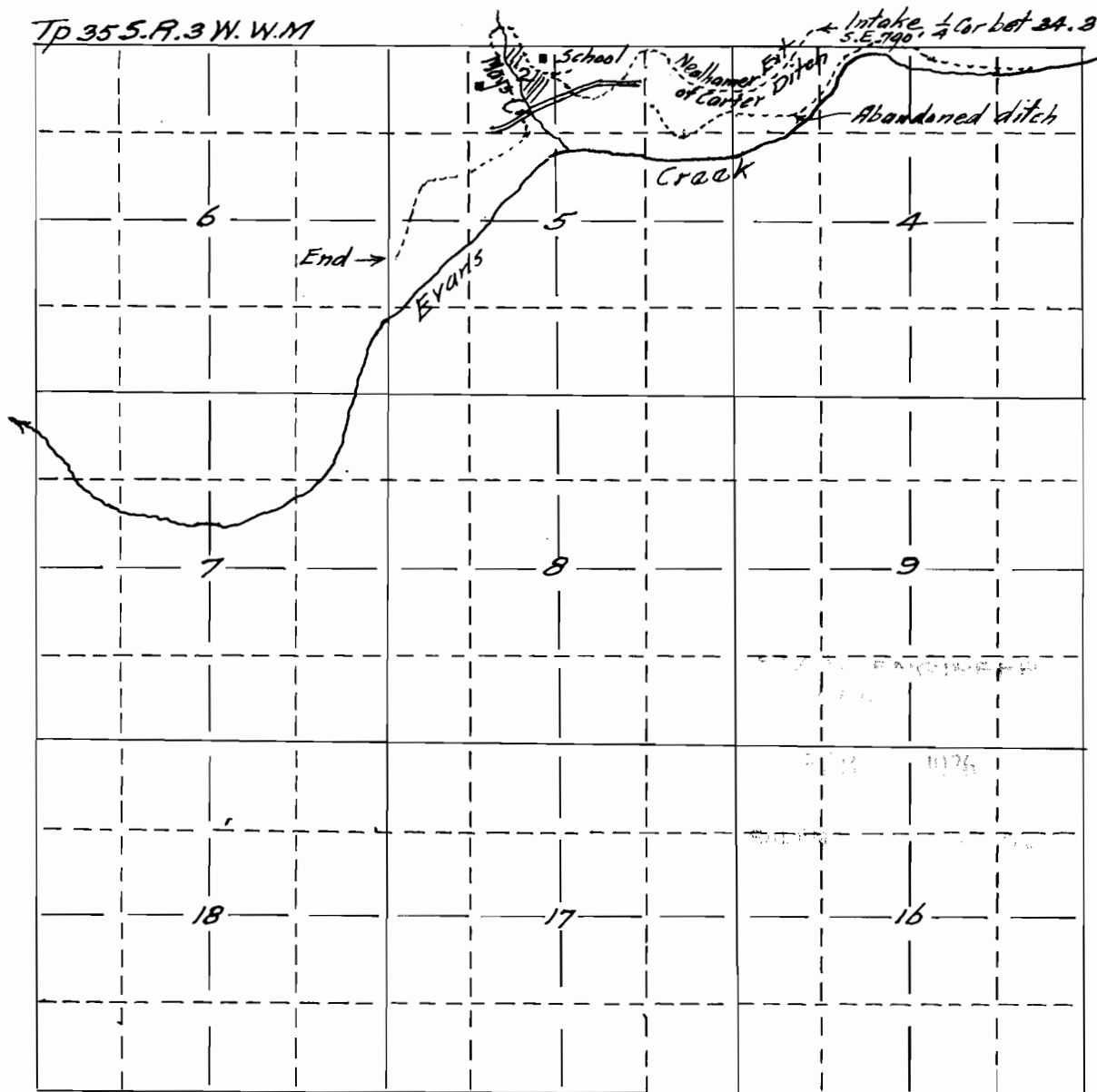

Map made from Water plat records showing location
of Weides land to be irrigated together with streams
and ditches in immediate vicinity. compiled by

Fred. N. Cummings, C.E.

10612