

Re-Revised Water Right Transfer Map From Certificate #19720
T 38 S, R 8 W, WM, Josephine County
Portions of Sections 9, 10, and 11
 August 26, 2009

8-26-2009
 Exp 12-31-2010

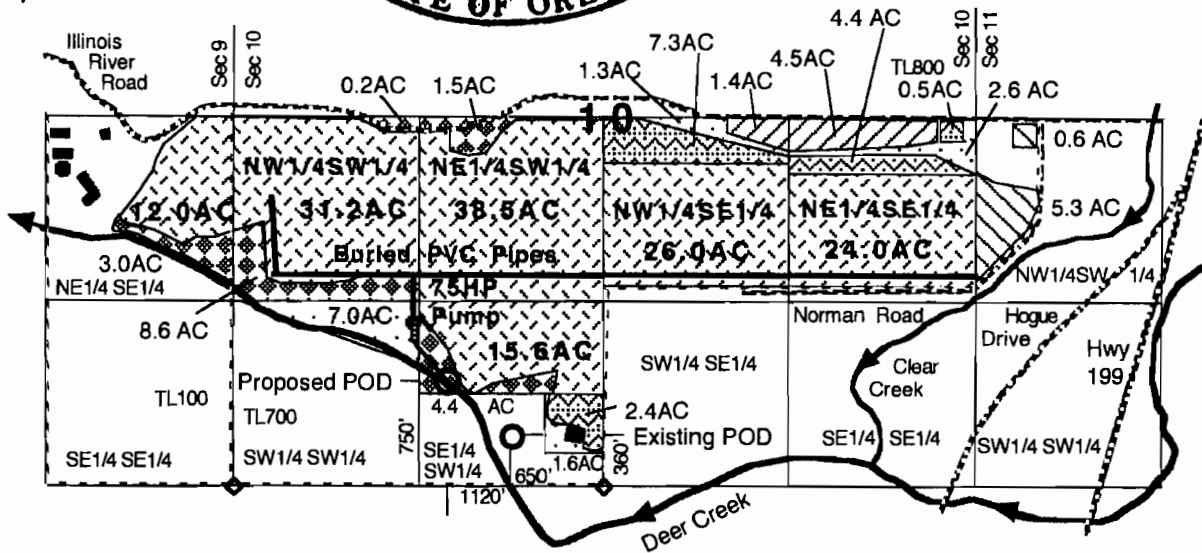

N
 ↑
 1" = 1320'



Application S-22760, Permit S-17867, and Certificate #19720 with a priority of August 15, 1947 for irrigation and supplemental irrigation at a rate of 1/50 cfs per acre from Deer Creek.

- Points of Diversion (POD)
 Proposed POD is located 1120 feet West and 750 feet North from the S1/4 corner of Section 10.
 Existing POD is located 650 feet West and 360 feet North from the S1/4 corner of Section 10.
- ▨ 5.9 acres of existing primary irrigation rights under C #19720 proposed to change the POU and POD.
- ▧ 5.9 acres proposed for primary irrigation rights by the transfer.
- ▩ 14.6 acres of primary irrigation rights under C #19720 proposed to change the POD.
- 147.3 acres of supplemental irrigation rights under C #19720 proposed to change the POD.
- 12.5 acres of abandoned primary irrigation rights under C #19720 to cancel.
- ▬ 17.7 acres of abandoned supplemental irrigation rights under C #19720 to cancel.
- Streams and pond
- Buildings
- Roads

RECEIVED

AUG 31 2009

**WATER RESOURCES DEPT
 SALEM, OREGON**

This map was drawn by Gordon R. Lyford for the Deer Creek Center to support their Water Right Transfer Application to change the POU and POD of irrigation and supplemental irrigation water from Deer Creek. The DCC owns tax lots 100 and 700.

This map was prepared for the purpose of identifying the location of water rights only and is not intended to provide legal dimensions or the location of property ownership lines.

T. 38 S., R. 8 W., W. M.
 Scale 4" = 1 Mile. July 1947
 Deer Creek Ranch

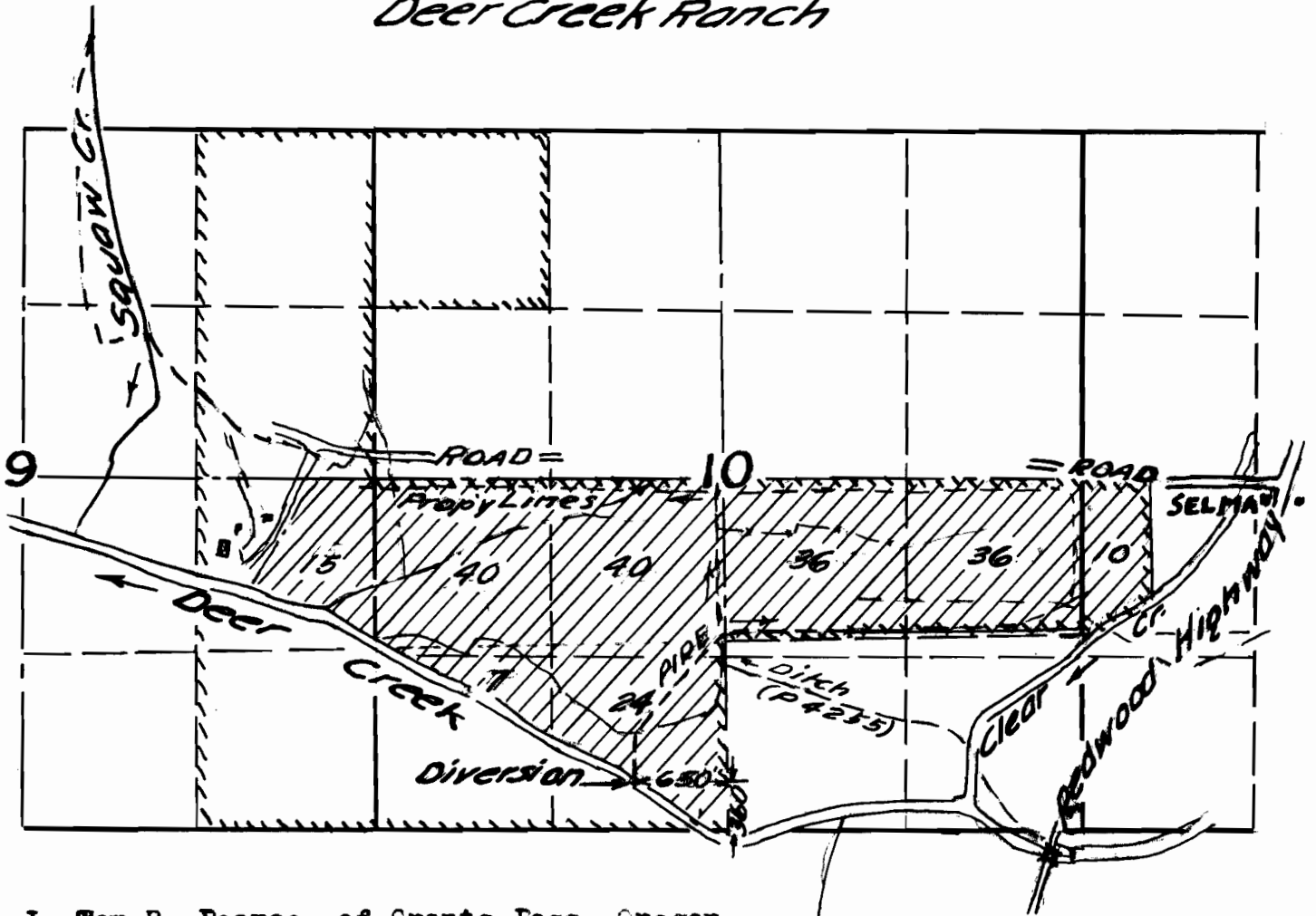

I, Tom R. Pearce, of Grants Pass, Oregon do hereby certify that this map was made from notes taken during an actual survey made by me on August 5, 1947; that the monument shown on this map consisting of 2" pipe and foundation structures is 360 feet North and 650 feet West from the South Quarter corner of Section 10 T38 South R8 West Willamette Meridian.

22760
 15-56-

RECEIVED

STATE ENGINEER
 OREGON

Application No. 22760
 Permit No. 17867

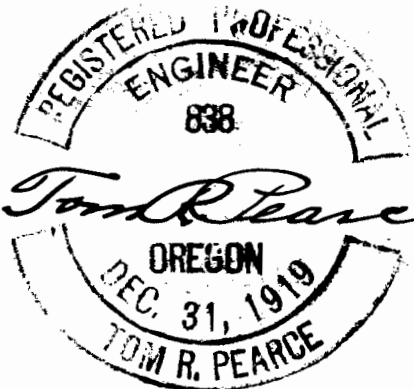

J. H. Fomeroy

Application No.
 Permit No.