

T16S, R18 & R19E,
 Sections 16, 17, 18, 19, 20, 24 & 30, WM
 Crook County, Oregon
 T-8827 Claim of Beneficial Use Map
 Primary Irrigation

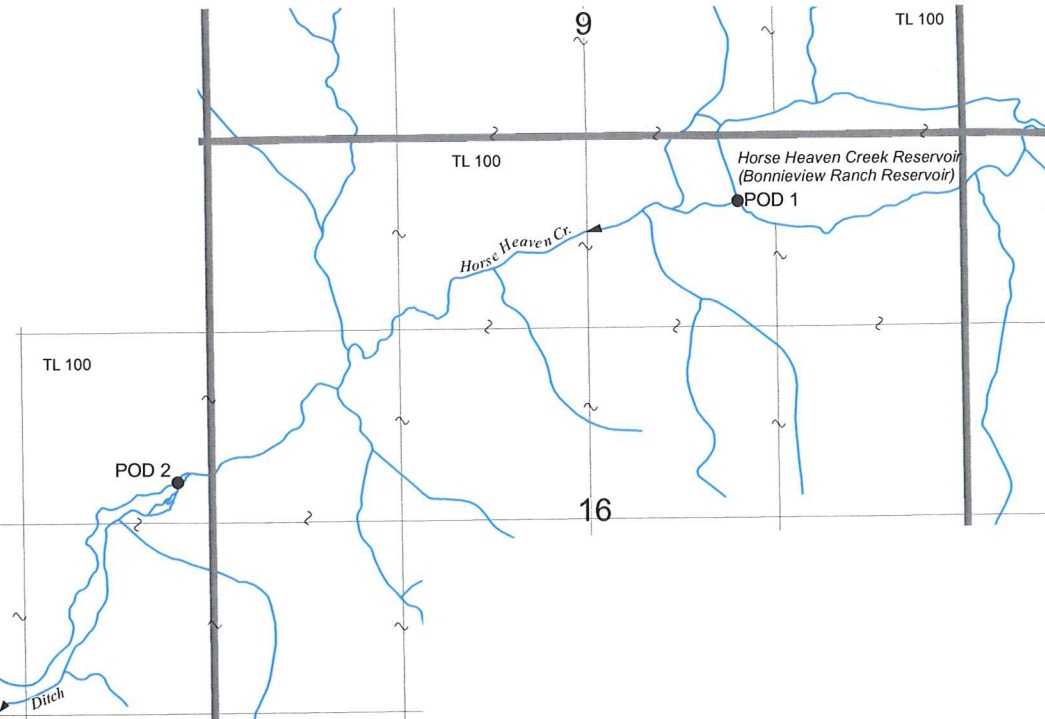
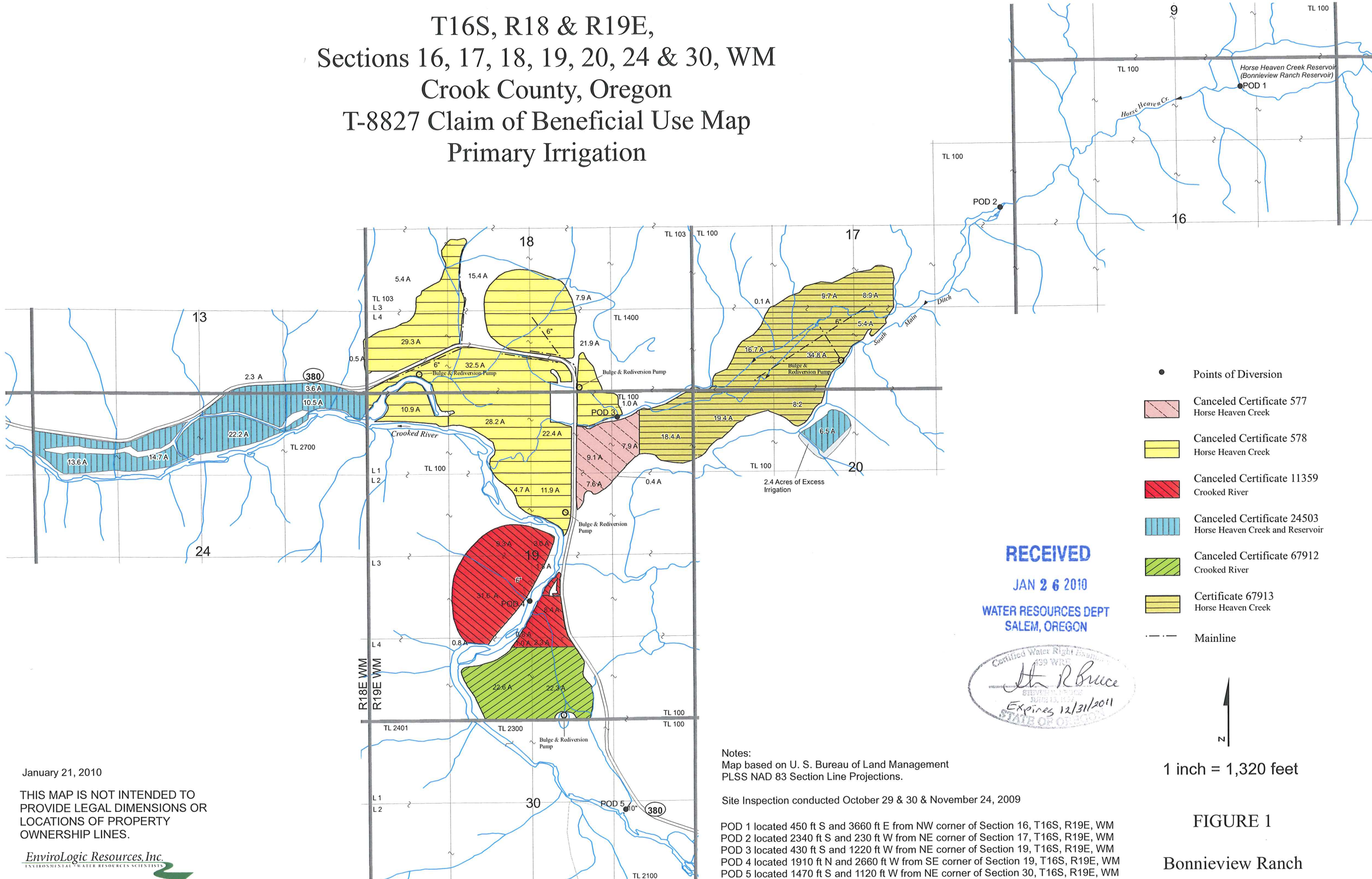

- Points of Diversion
- Canceled Certificate 577
Horse Heaven Creek
- Canceled Certificate 578
Horse Heaven Creek
- Canceled Certificate 11359
Crooked River
- Canceled Certificate 24503
Horse Heaven Creek and Reservoir
- Canceled Certificate 67912
Crooked River
- Certificate 67913
Horse Heaven Creek
- Mainline

RECEIVED
 JAN 26 2010
 WATER RESOURCES DEPT
 SALEM, OREGON

St. R. Bruce
 STEVEN R. BRUCE
 JUN 13, 1977
 Expires 12/31/2011
 STATE OF OREGON



1 inch = 1,320 feet

FIGURE 1

Bonnieview Ranch

January 21, 2010
 THIS MAP IS NOT INTENDED TO
 PROVIDE LEGAL DIMENSIONS OR
 LOCATIONS OF PROPERTY
 OWNERSHIP LINES.



Notes:
 Map based on U. S. Bureau of Land Management
 PLSS NAD 83 Section Line Projections.

Site Inspection conducted October 29 & 30 & November 24, 2009

POD 1 located 450 ft S and 3660 ft E from NW corner of Section 16, T16S, R19E, WM
 POD 2 located 2340 ft S and 230 ft W from NE corner of Section 17, T16S, R19E, WM
 POD 3 located 430 ft S and 1220 ft W from NE corner of Section 19, T16S, R19E, WM
 POD 4 located 1910 ft N and 2660 ft W from SE corner of Section 19, T16S, R19E, WM
 POD 5 located 1470 ft S and 1120 ft W from NE corner of Section 30, T16S, R19E, WM

T16S, R18 & R19E, Sections 16, 17, 18, 19, 20, 24 & 30, WM Crook County, Oregon T-8827 Claim of Beneficial Use Map Supplemental Irrigation

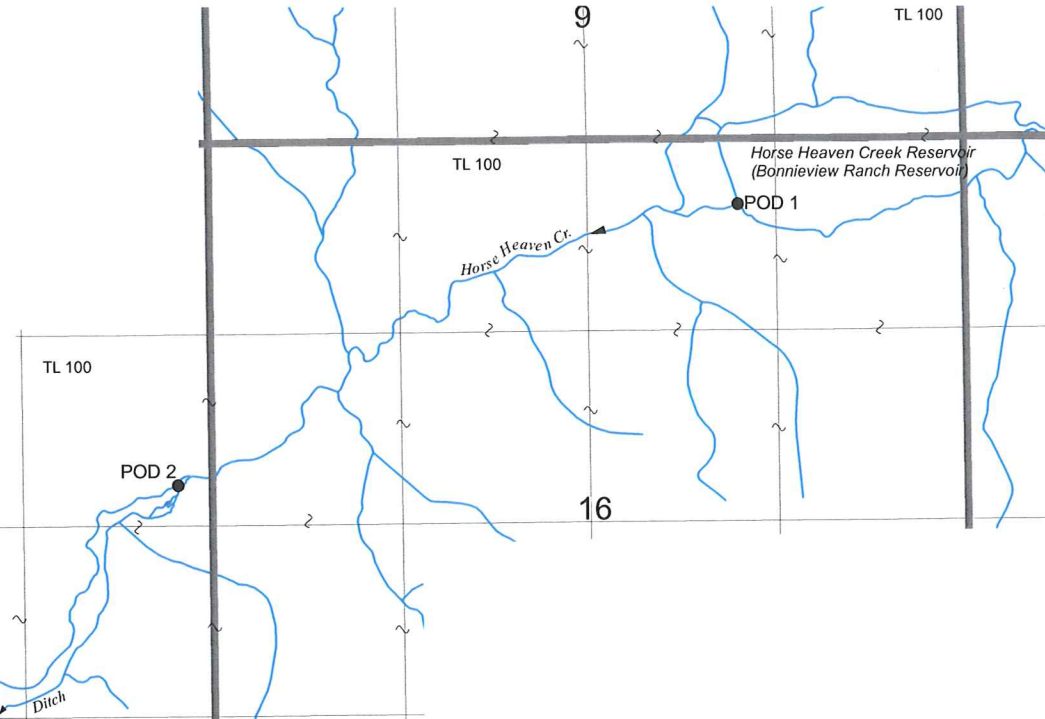
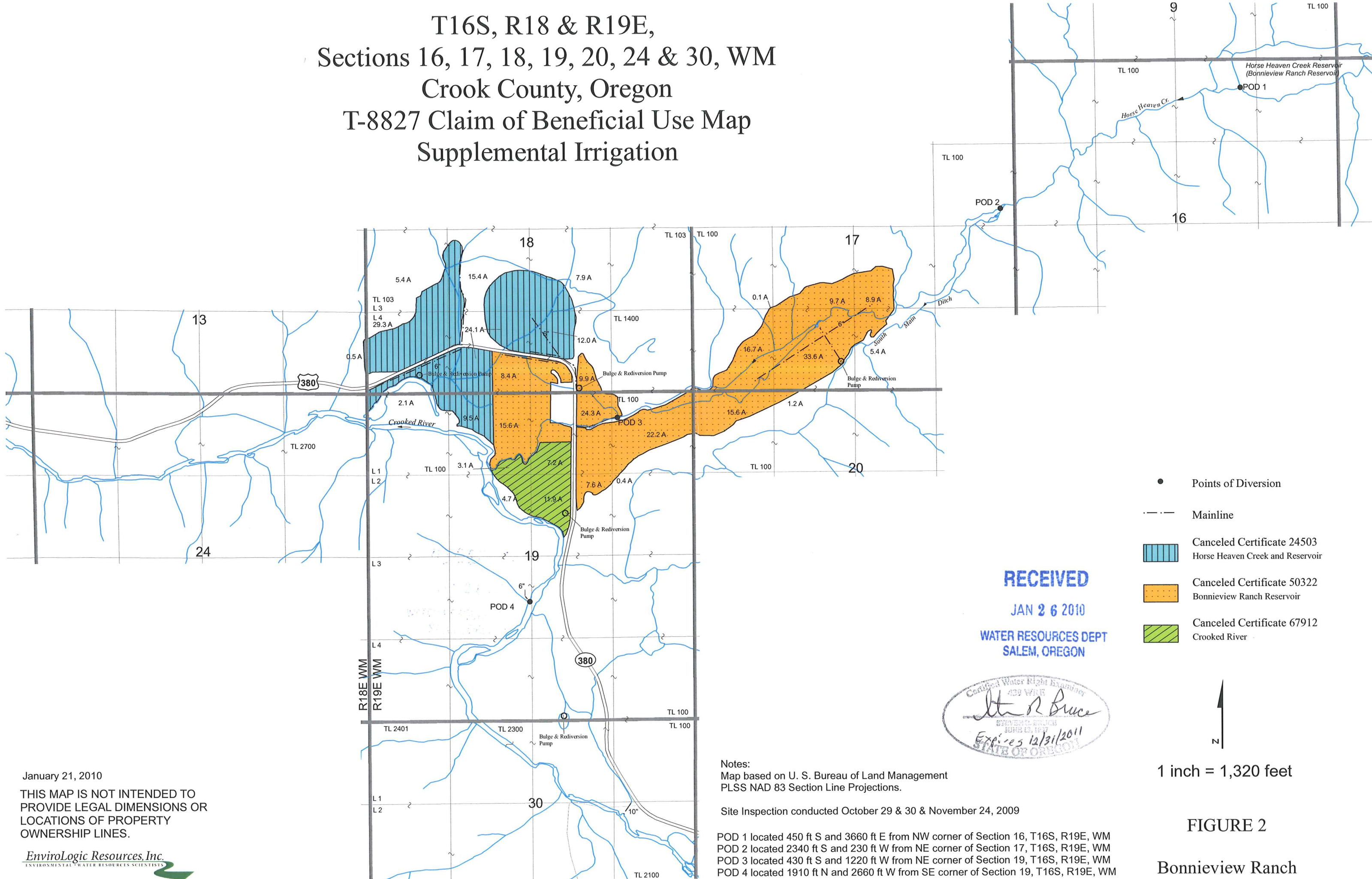

- Points of Diversion
- Mainline
- Canceled Certificate 24503
Horse Heaven Creek and Reservoir
- Canceled Certificate 50322
Bonnieview Ranch Reservoir
- Canceled Certificate 67912
Crooked River

RECEIVED
JAN 26 2010
WATER RESOURCES DEPT
SALEM, OREGON

Certified Water Right Examiner
439 WRR
John R. Bruce
STEVEN C. BRUCE
JUNE 12, 1977
Expires 12/31/2011
STATE OF OREGON



1 inch = 1,320 feet

FIGURE 2

Bonnieview Ranch

January 21, 2010
THIS MAP IS NOT INTENDED TO
PROVIDE LEGAL DIMENSIONS OR
LOCATIONS OF PROPERTY
OWNERSHIP LINES.



Notes:
Map based on U. S. Bureau of Land Management
PLSS NAD 83 Section Line Projections.

Site Inspection conducted October 29 & 30 & November 24, 2009

POD 1 located 450 ft S and 3660 ft E from NW corner of Section 16, T16S, R19E, WM
POD 2 located 2340 ft S and 230 ft W from NE corner of Section 17, T16S, R19E, WM
POD 3 located 430 ft S and 1220 ft W from NE corner of Section 19, T16S, R19E, WM
POD 4 located 1910 ft N and 2660 ft W from SE corner of Section 19, T16S, R19E, WM