

T16S, R18 & R19E, Sections 16, 17, 18, 19, 20, 24 & 30, WM Crook County, Oregon T-8827 Claim of Beneficial Use Map Supplemental Irrigation

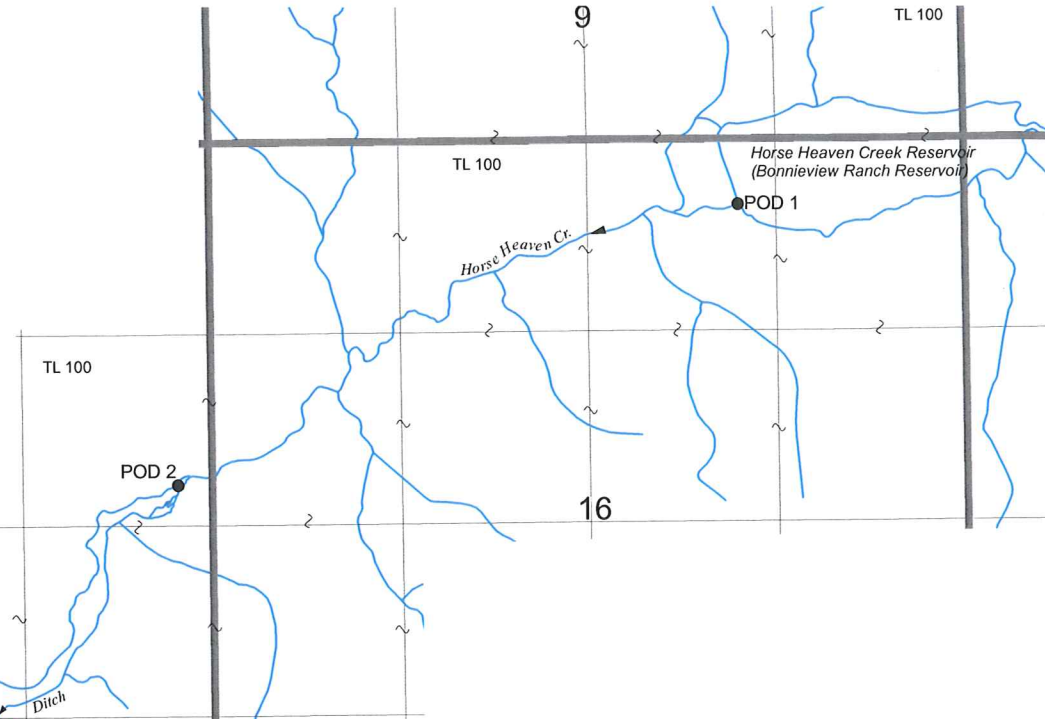
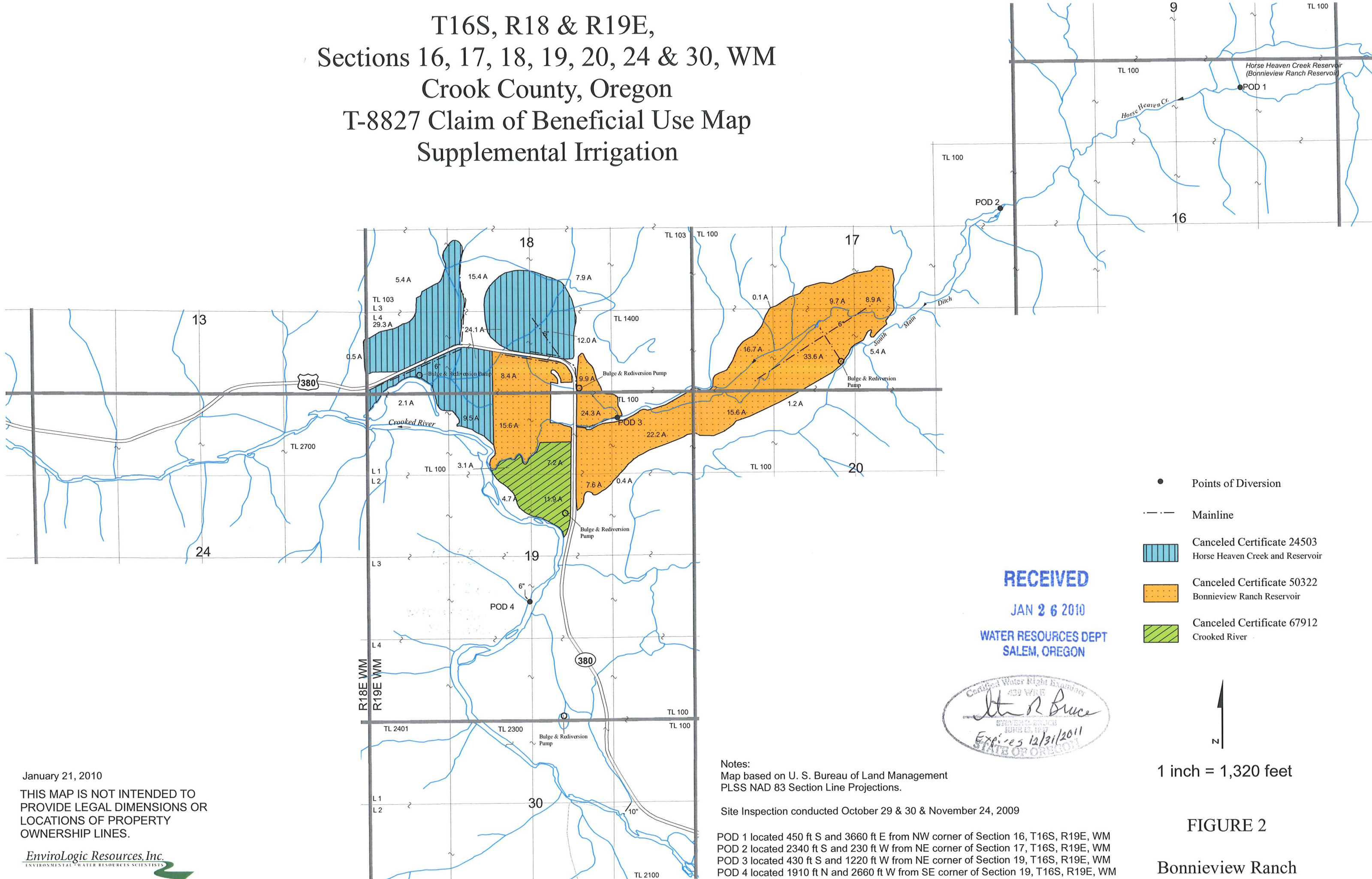

- Points of Diversion
- Mainline
- Canceled Certificate 24503
Horse Heaven Creek and Reservoir
- Canceled Certificate 50322
Bonnieview Ranch Reservoir
- Canceled Certificate 67912
Crooked River

RECEIVED
JAN 26 2010
WATER RESOURCES DEPT
SALEM, OREGON

Certified Water Right Examiner
439 WRR
John R. Bruce
STEVEN C. BRUCE
JUNE 12, 1977
Expires 12/31/2011
STATE OF OREGON



1 inch = 1,320 feet

FIGURE 2

Bonnieview Ranch

January 21, 2010
THIS MAP IS NOT INTENDED TO
PROVIDE LEGAL DIMENSIONS OR
LOCATIONS OF PROPERTY
OWNERSHIP LINES.



Notes:
Map based on U. S. Bureau of Land Management
PLSS NAD 83 Section Line Projections.

Site Inspection conducted October 29 & 30 & November 24, 2009

POD 1 located 450 ft S and 3660 ft E from NW corner of Section 16, T16S, R19E, WM
POD 2 located 2340 ft S and 230 ft W from NE corner of Section 17, T16S, R19E, WM
POD 3 located 430 ft S and 1220 ft W from NE corner of Section 19, T16S, R19E, WM
POD 4 located 1910 ft N and 2660 ft W from SE corner of Section 19, T16S, R19E, WM