

T16S, R18 & R19E,  
 Sections 16, 17, 18, 19, 20, 24 & 30, WM  
 Crook County, Oregon  
 T-8827 Claim of Beneficial Use Map  
 Primary Irrigation

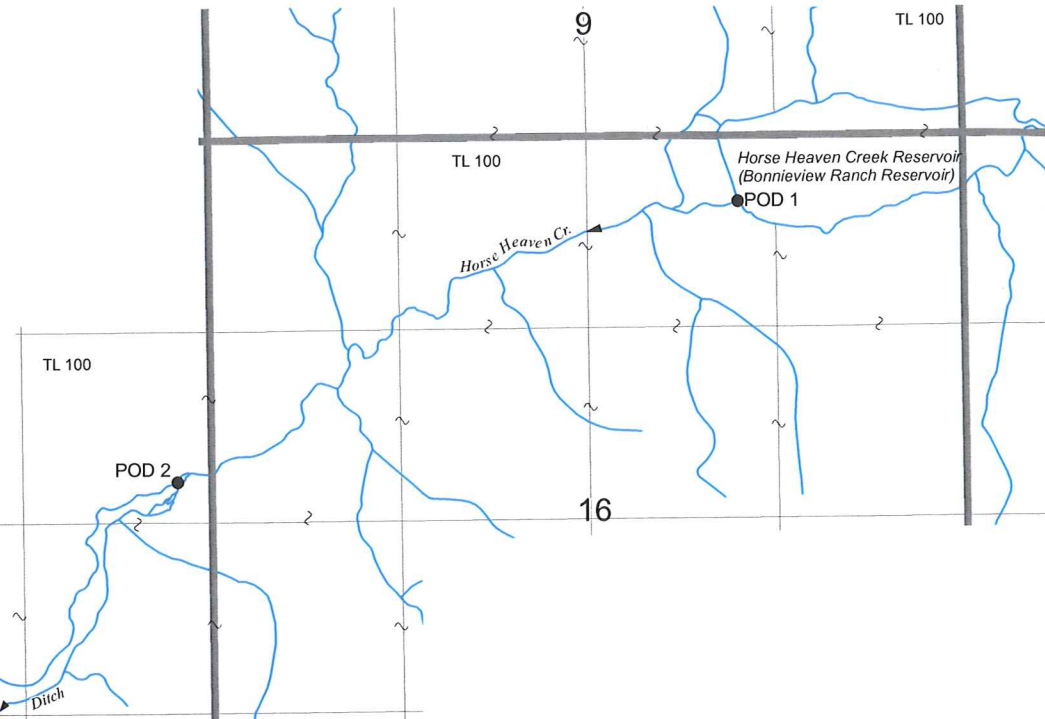
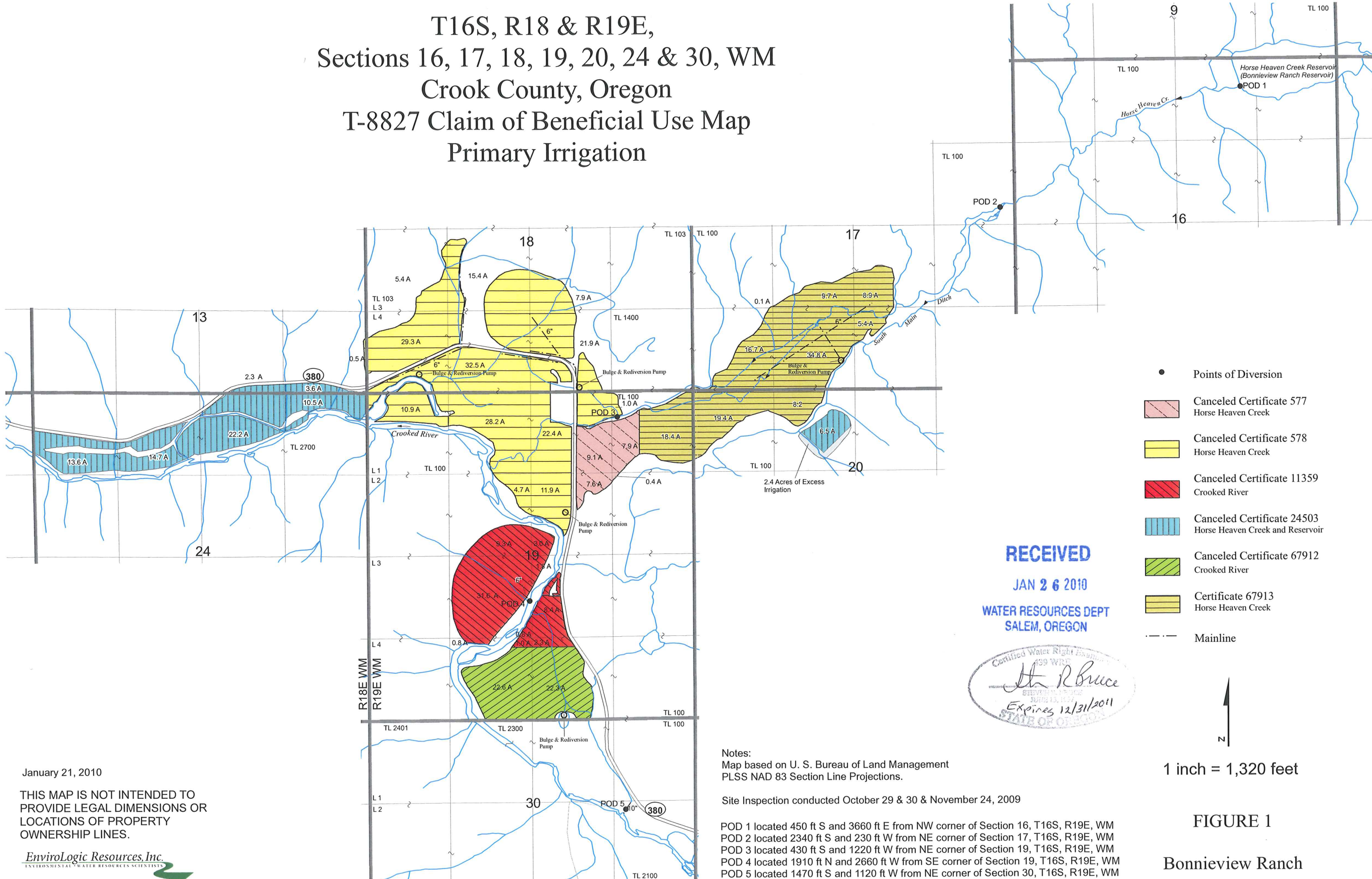

- Points of Diversion
- Canceled Certificate 577  
Horse Heaven Creek
- Canceled Certificate 578  
Horse Heaven Creek
- Canceled Certificate 11359  
Crooked River
- Canceled Certificate 24503  
Horse Heaven Creek and Reservoir
- Canceled Certificate 67912  
Crooked River
- Certificate 67913  
Horse Heaven Creek
- Mainline

**RECEIVED**  
 JAN 26 2010  
 WATER RESOURCES DEPT  
 SALEM, OREGON

*St. R. Bruce*  
 STEVEN R. BRUCE  
 JUN 13, 1977  
 Expires 12/31/2011  
 STATE OF OREGON



1 inch = 1,320 feet

FIGURE 1

Bonnieview Ranch

January 21, 2010  
 THIS MAP IS NOT INTENDED TO  
 PROVIDE LEGAL DIMENSIONS OR  
 LOCATIONS OF PROPERTY  
 OWNERSHIP LINES.



Notes:  
 Map based on U. S. Bureau of Land Management  
 PLSS NAD 83 Section Line Projections.

Site Inspection conducted October 29 & 30 & November 24, 2009

POD 1 located 450 ft S and 3660 ft E from NW corner of Section 16, T16S, R19E, WM  
 POD 2 located 2340 ft S and 230 ft W from NE corner of Section 17, T16S, R19E, WM  
 POD 3 located 430 ft S and 1220 ft W from NE corner of Section 19, T16S, R19E, WM  
 POD 4 located 1910 ft N and 2660 ft W from SE corner of Section 19, T16S, R19E, WM  
 POD 5 located 1470 ft S and 1120 ft W from NE corner of Section 30, T16S, R19E, WM

# T16S, R18 & R19E, Sections 16, 17, 18, 19, 20, 24 & 30, WM Crook County, Oregon T-8827 Claim of Beneficial Use Map Supplemental Irrigation

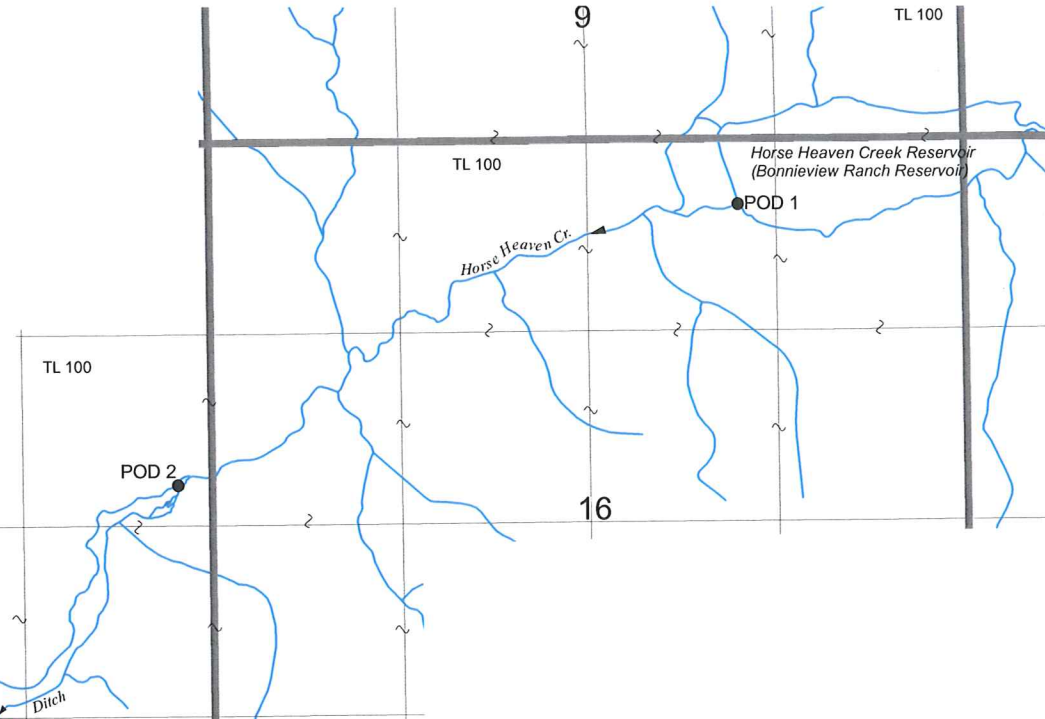
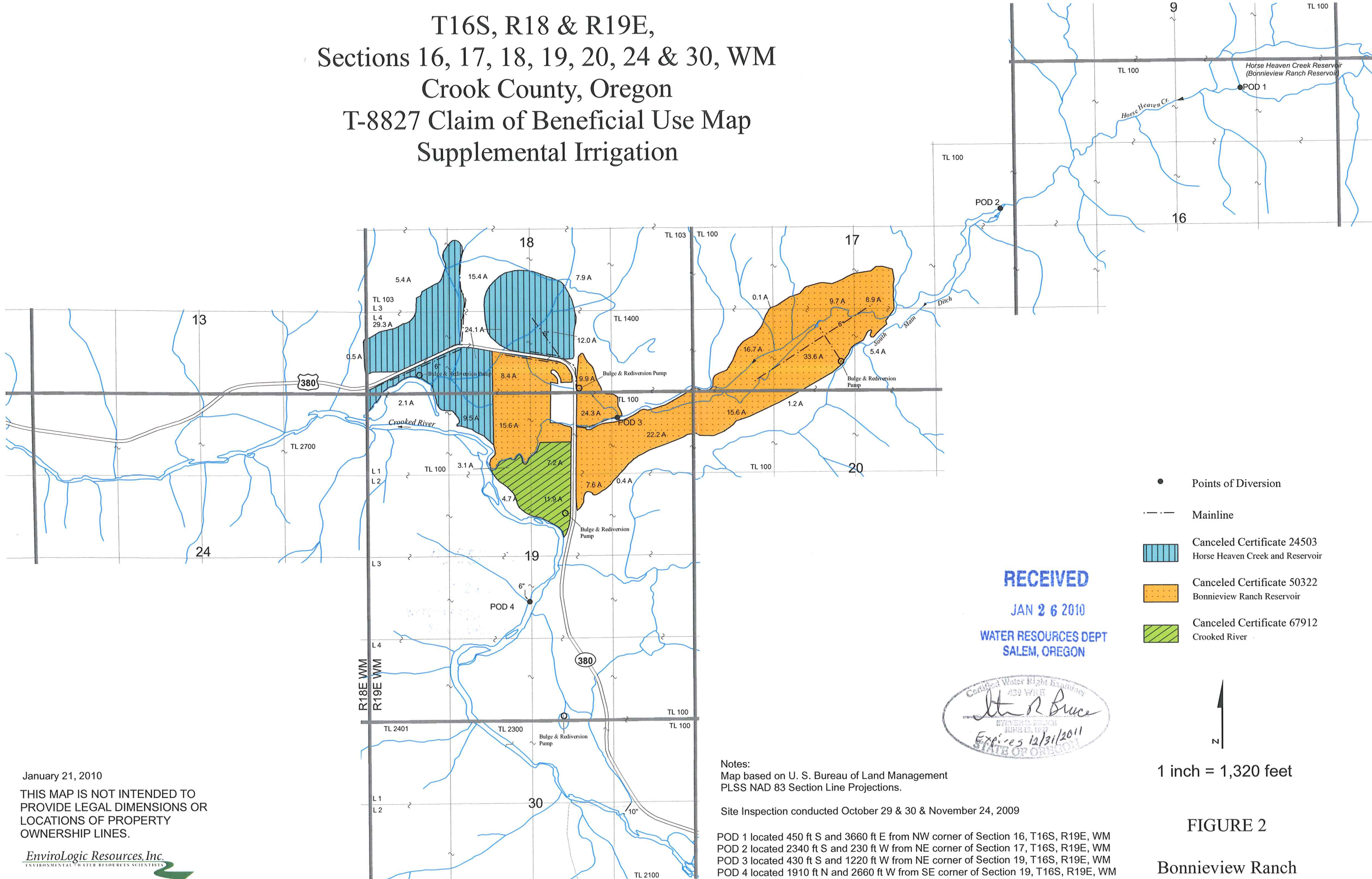

- Points of Diversion
- Mainline
- Canceled Certificate 24503  
Horse Heaven Creek and Reservoir
- Canceled Certificate 50322  
Bonnieview Ranch Reservoir
- Canceled Certificate 67912  
Crooked River

**RECEIVED**  
JAN 26 2010  
WATER RESOURCES DEPT  
SALEM, OREGON

Certified Water Right Examiner  
439 WRR  
*Steve Bruce*  
STEVE BRUCE  
BUREAU OF LAND MANAGEMENT  
Expires 12/31/2011  
STATE OF OREGON



1 inch = 1,320 feet

FIGURE 2

Bonnieview Ranch

January 21, 2010  
THIS MAP IS NOT INTENDED TO  
PROVIDE LEGAL DIMENSIONS OR  
LOCATIONS OF PROPERTY  
OWNERSHIP LINES.



Notes:  
Map based on U. S. Bureau of Land Management  
PLSS NAD 83 Section Line Projections.

Site Inspection conducted October 29 & 30 & November 24, 2009

POD 1 located 450 ft S and 3660 ft E from NW corner of Section 16, T16S, R19E, WM  
POD 2 located 2340 ft S and 230 ft W from NE corner of Section 17, T16S, R19E, WM  
POD 3 located 430 ft S and 1220 ft W from NE corner of Section 19, T16S, R19E, WM  
POD 4 located 1910 ft N and 2660 ft W from SE corner of Section 19, T16S, R19E, WM