

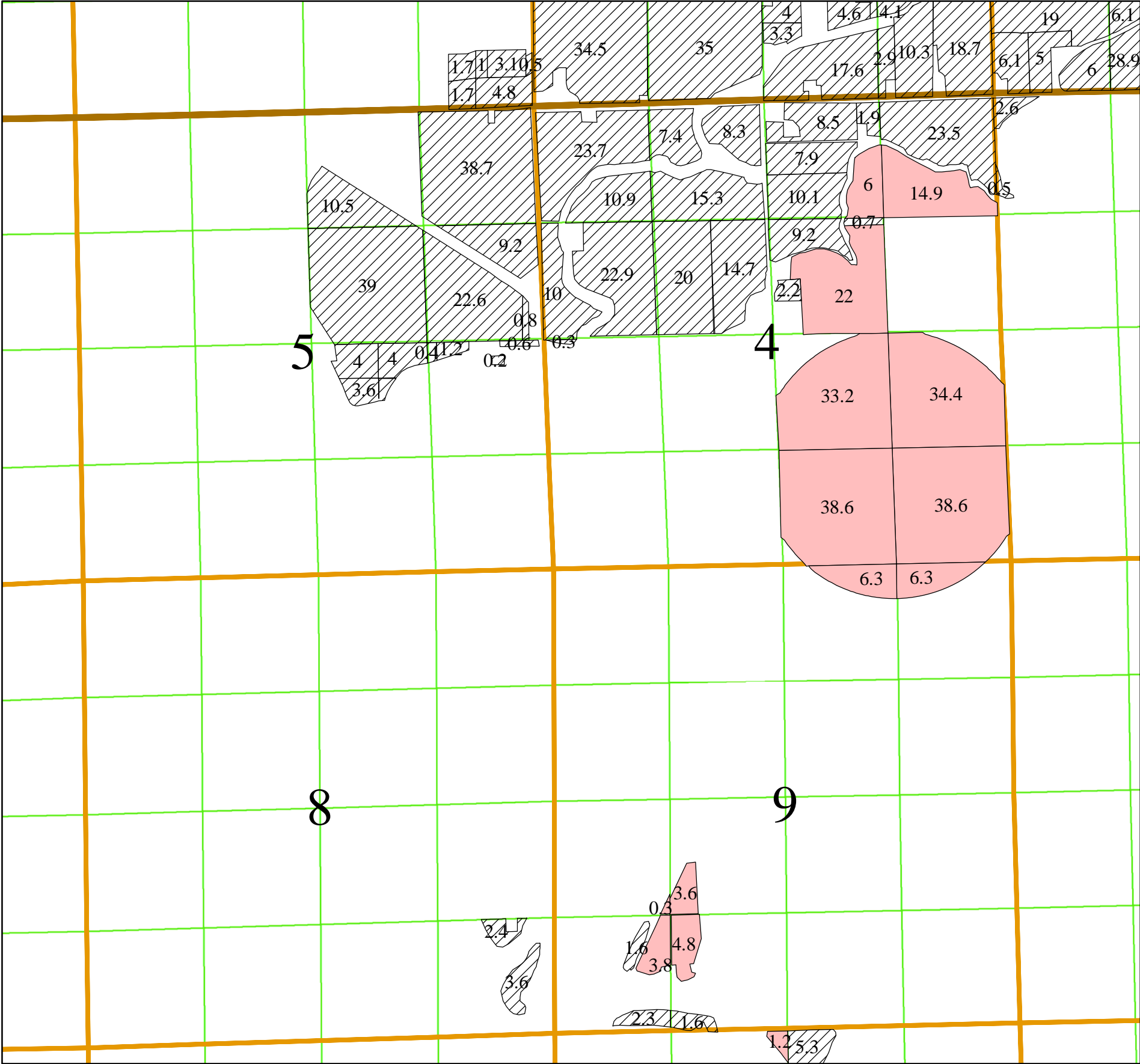

TOWNSHIP 3 NORTH, RANGE 29 EAST, W.M.

SECTIONS 4, 5, 8, and 9

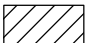

Legend
stan329final
Priority
 1905
 1965

1 inch = 1320 feet

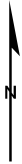

TOWNSHIP 3 NORTH, RANGE 29 EAST, W.M.

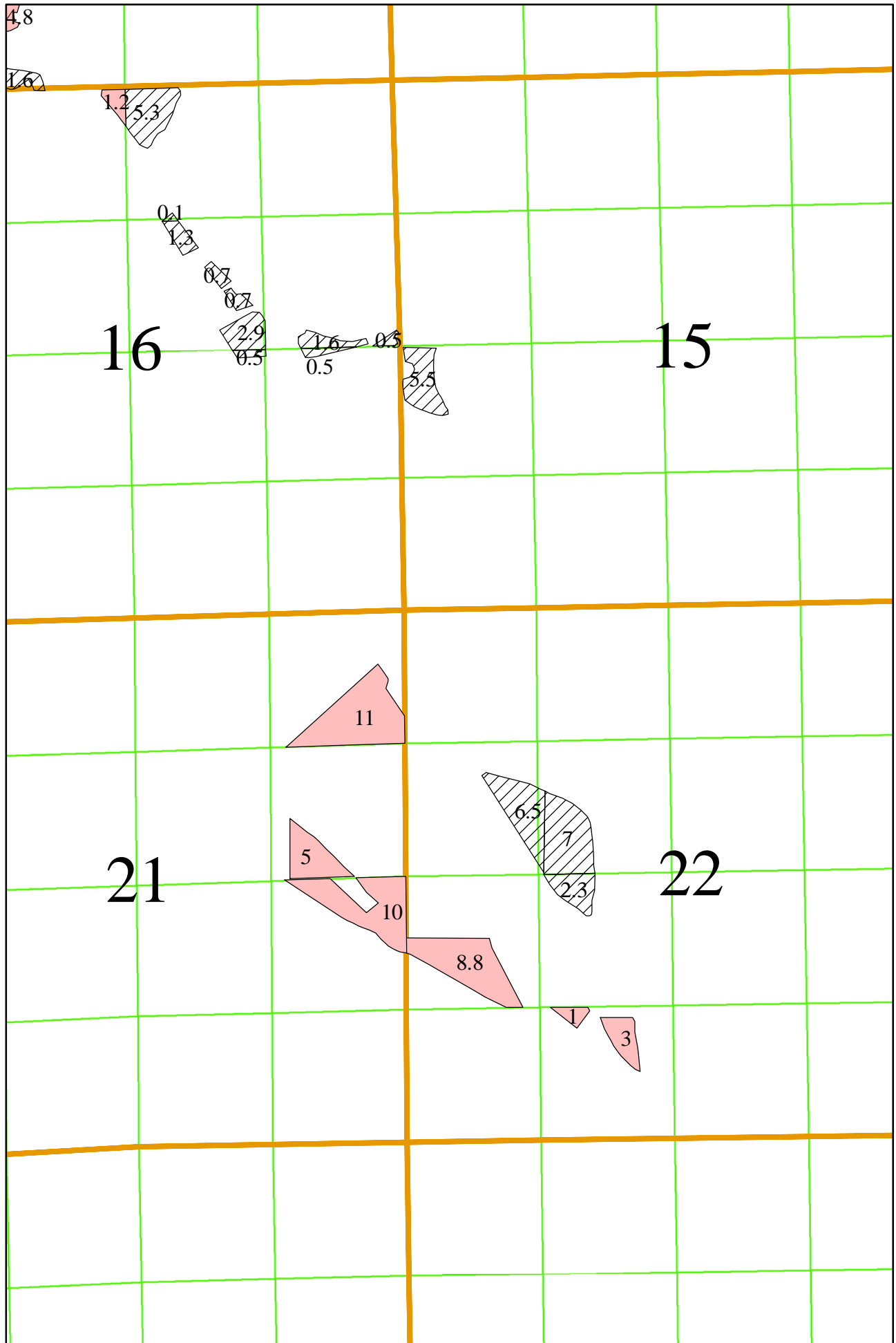

SECTIONS 15, 16, 21, and 22



Legend

stan329final

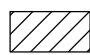
Priority

-  1905
-  1965

1 inch = 1320 feet



TOWNSHIP 4 NORTH, RANGE 28 EAST, W.M.

SECTIONS 13 and 24

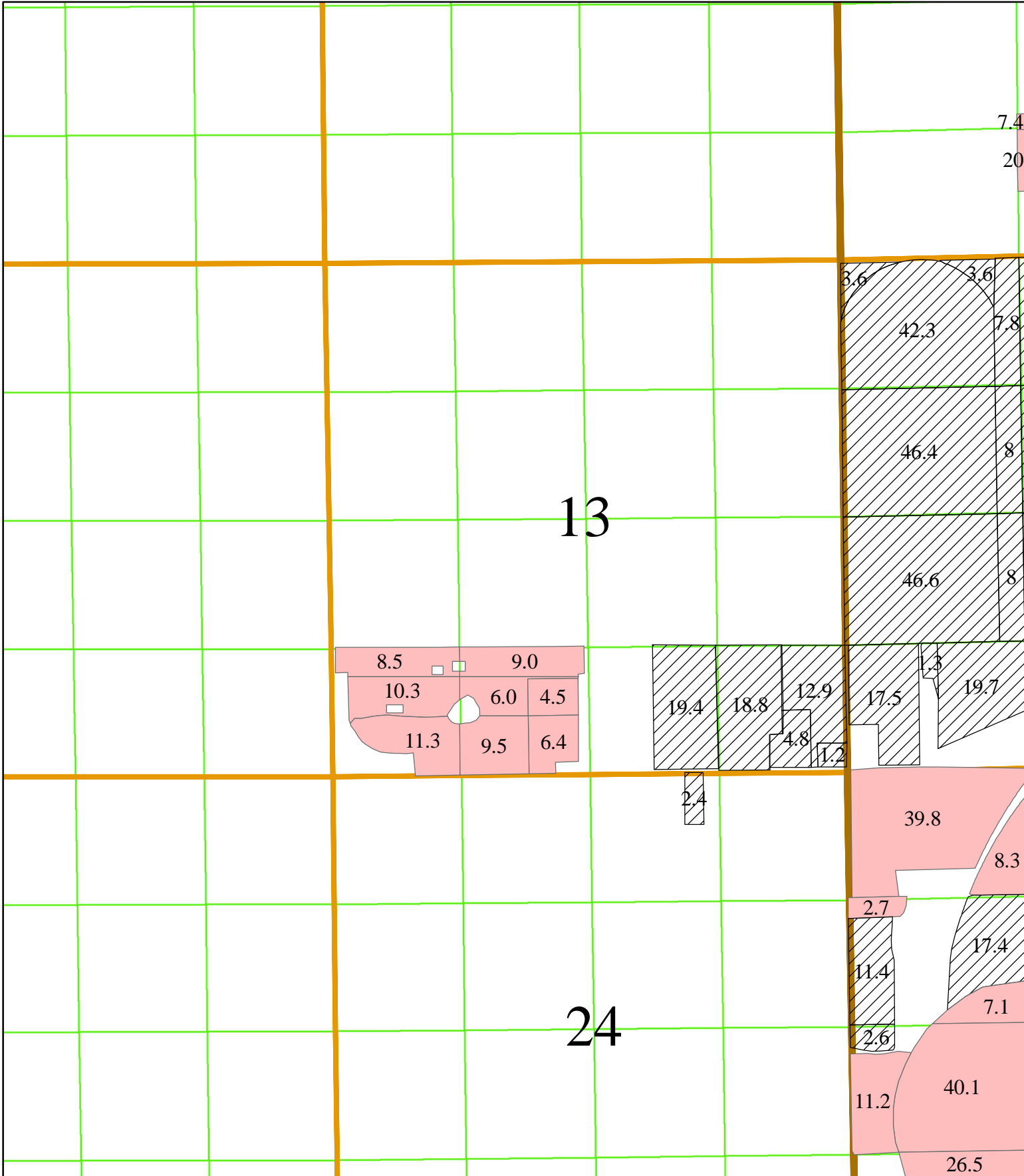

Legend

stan428final

Priority

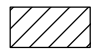
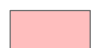
-  1905
-  1965

1 inch = 1320 feet

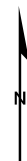

TOWNSHIP 4 NORTH, RANGE 29 EAST, W.M.

SECTIONS 3, 4, 9, and 10

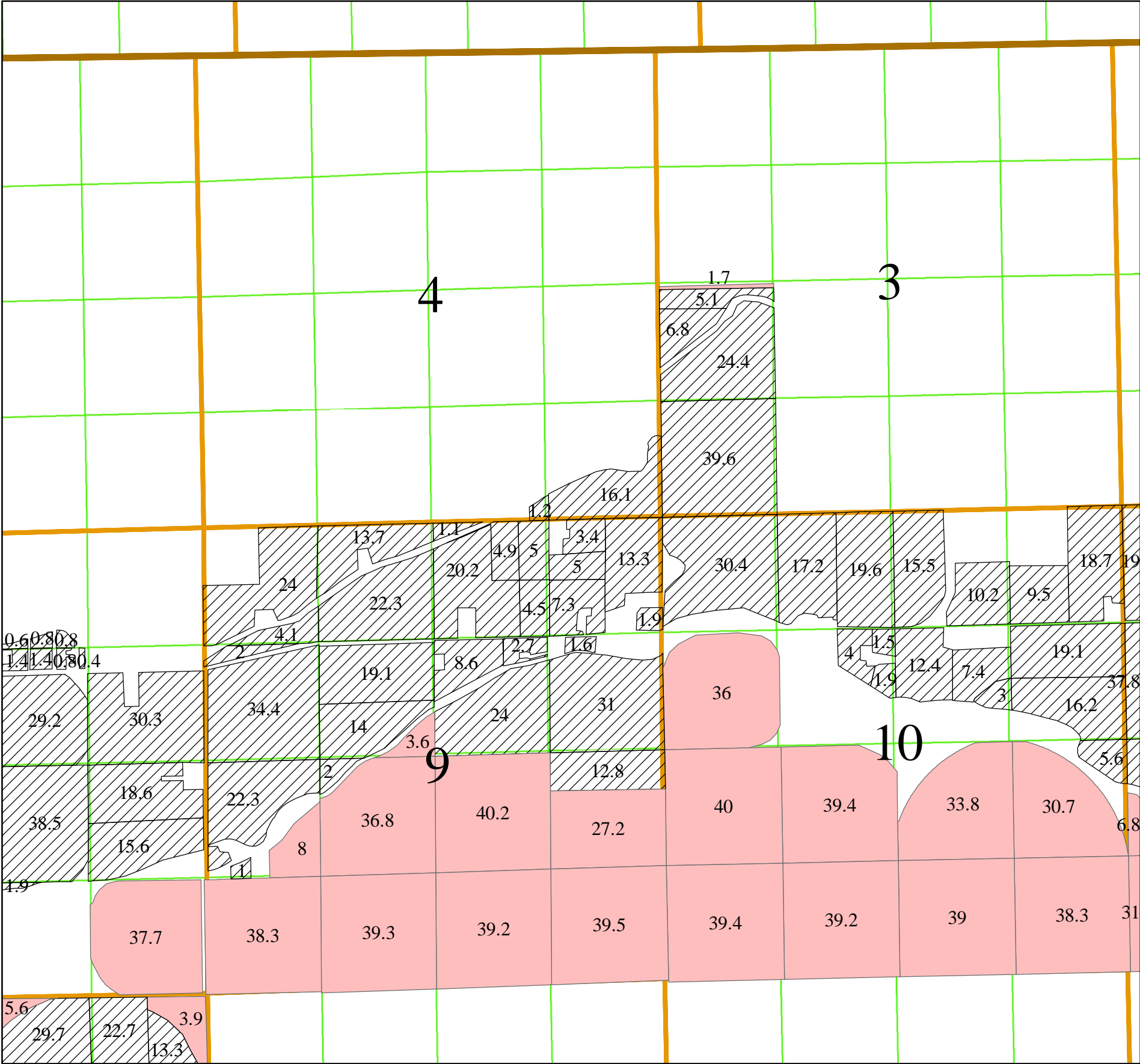

Legend
stan429final
Priority
1905
1965

1 inch = 1320 feet



TOWNSHIP 4 NORTH, RANGE 29 EAST, W.M.

SECTIONS 7, 8, 17, and 18

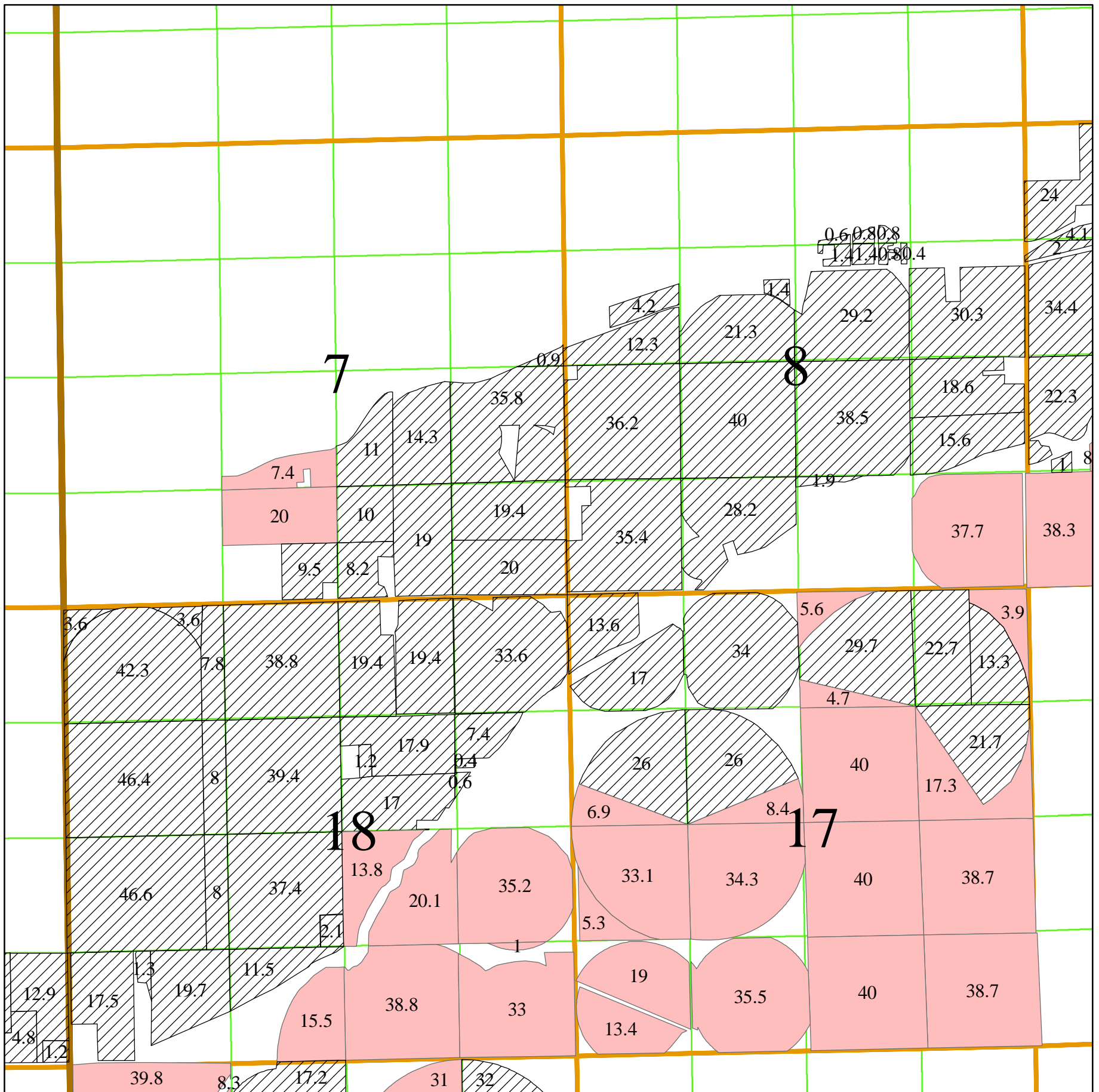

Legend
stan429final
Priority
1905
1965

1 inch = 1320 feet



TOWNSHIP 4 NORTH, RANGE 29 EAST, W.M.

SECTIONS 11, 12, 13, and 14

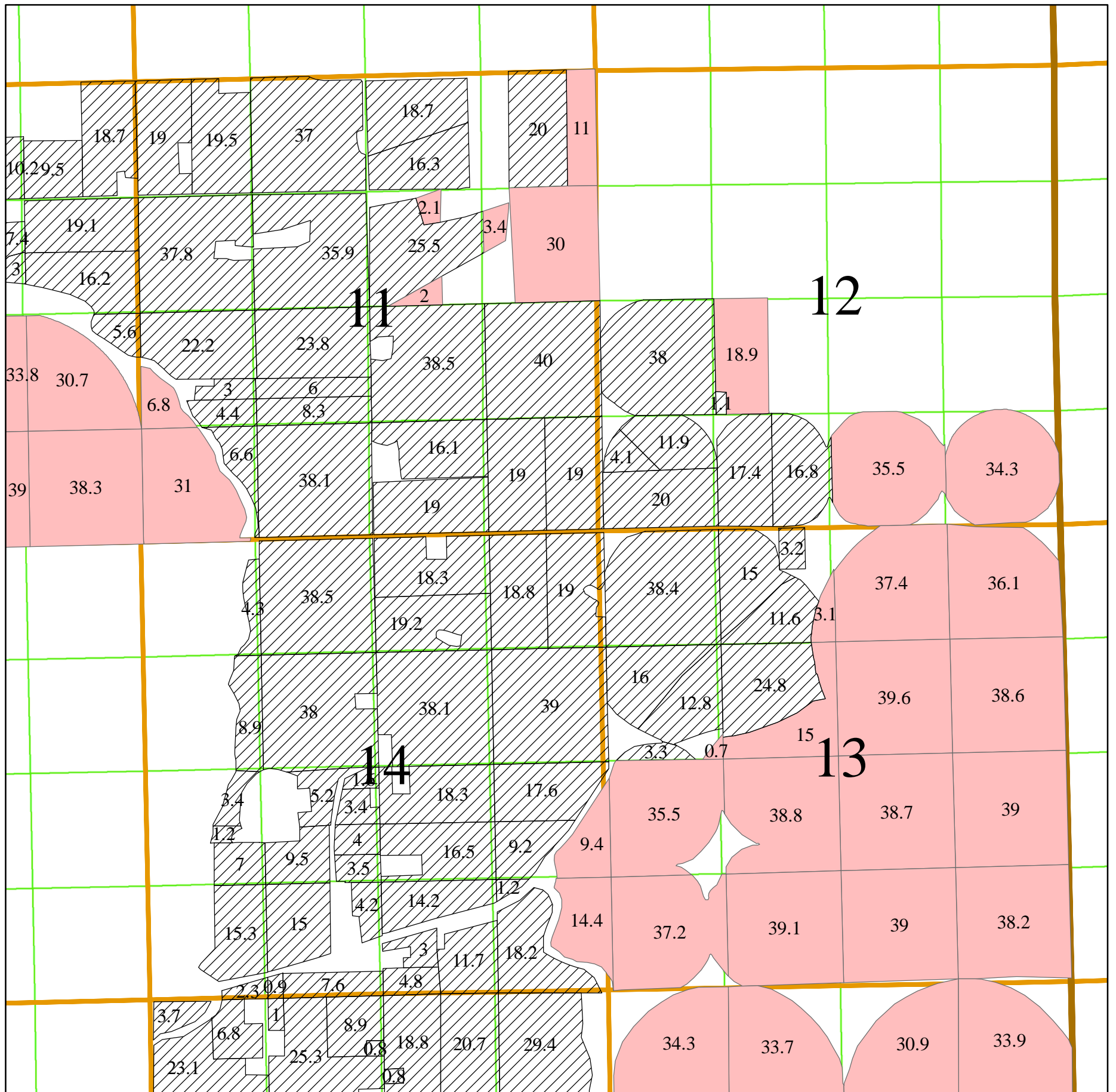

Legend

stan429final

Priority

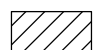
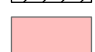
-  1905
-  1965

1 inch = 1320 feet



TOWNSHIP 4 NORTH, RANGE 29 EAST, W.M.

SECTIONS 19, 29, and 32

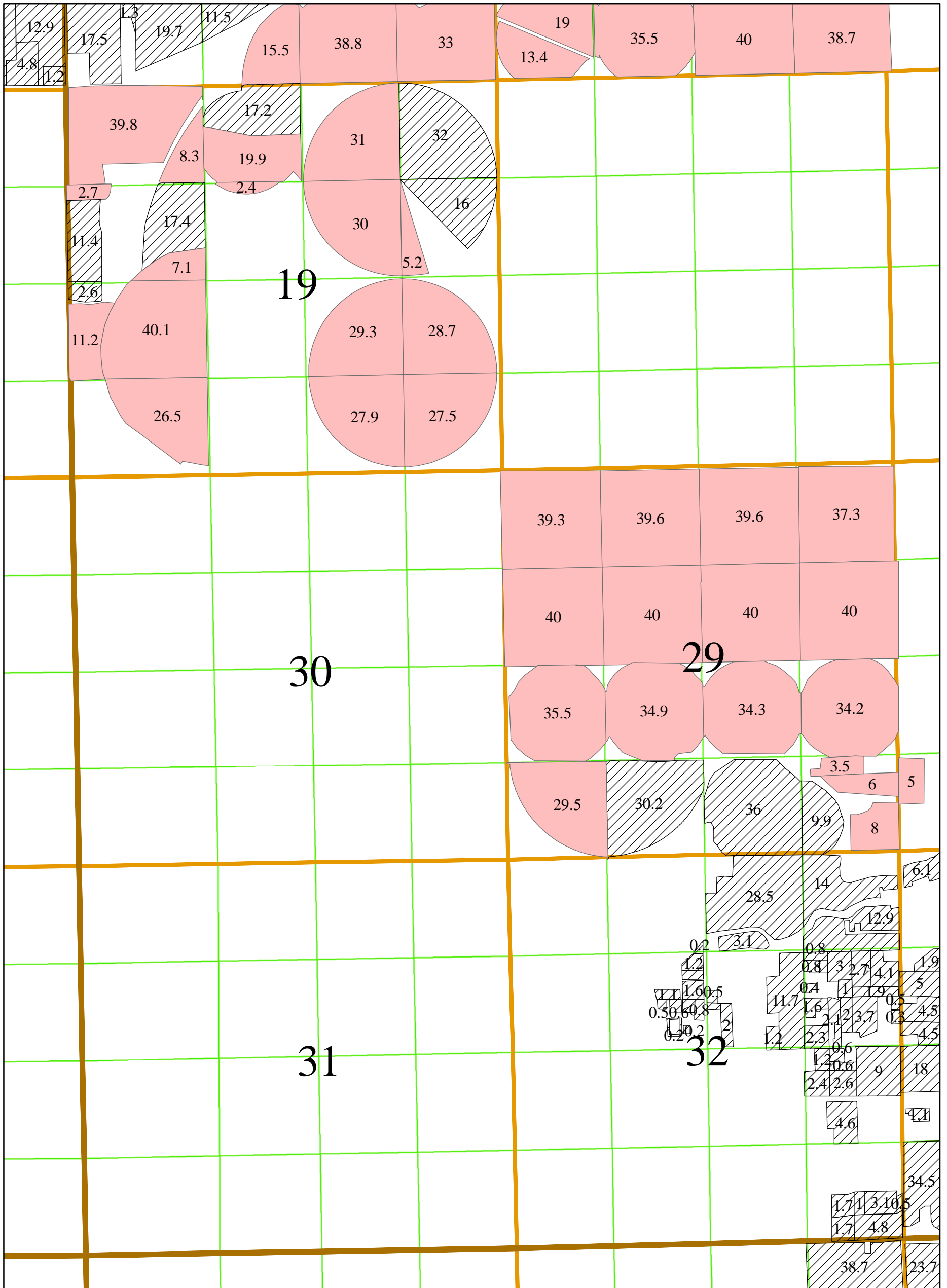

Legend

stan429final

Priority

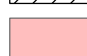
-  1905
-  1965

1 inch = 1320 feet



TOWNSHIP 4 NORTH, RANGE 29 EAST, W.M.

SECTIONS 22, 27, 28, 33 and 34

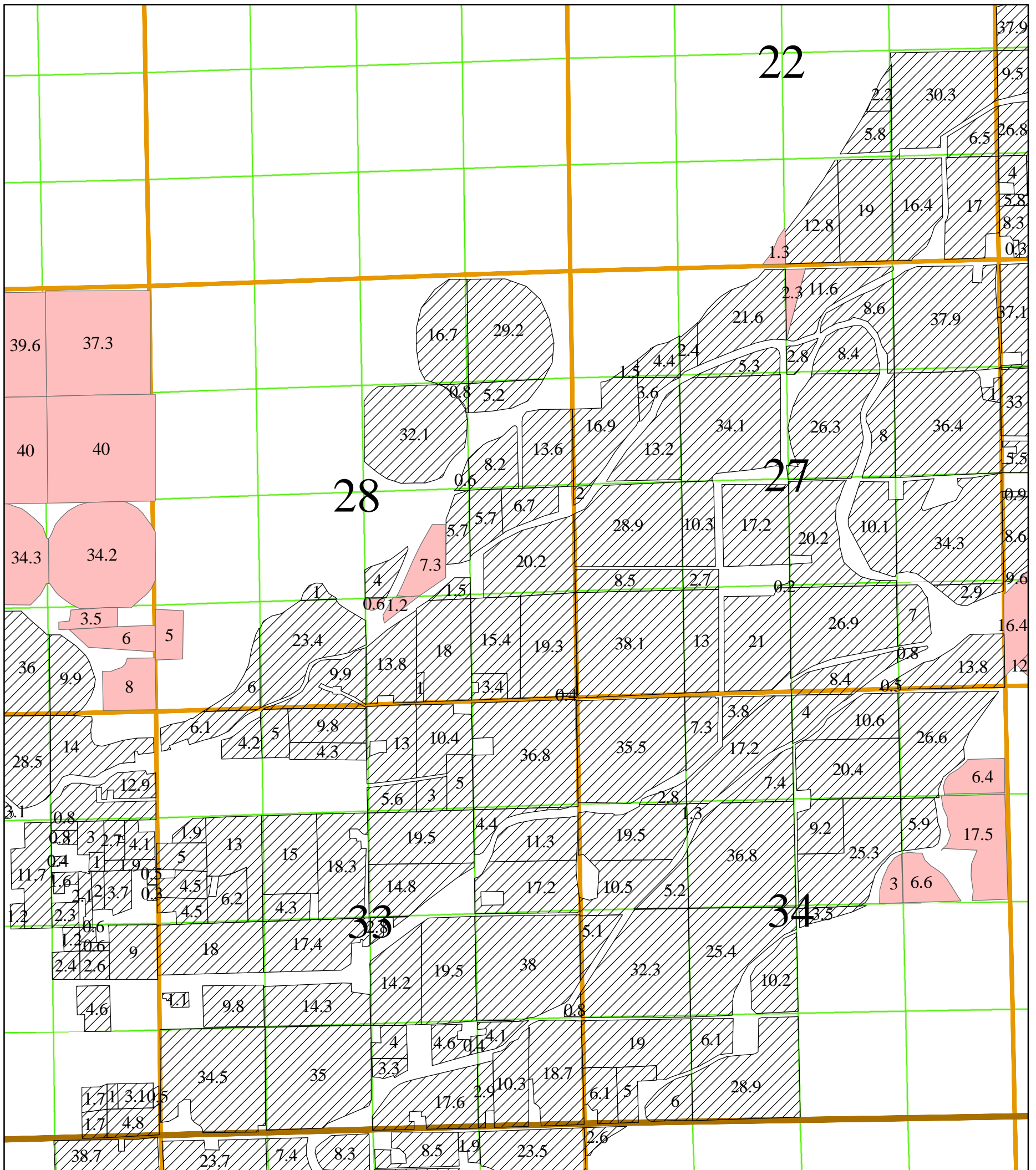

Legend

stan429final

Priority

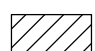
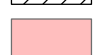
-  1905
-  1965

1 inch = 1320 feet

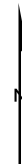

TOWNSHIP 4 NORTH, RANGE 29 EAST, W.M.

SECTIONS 23, 24, 25, 26, and 36

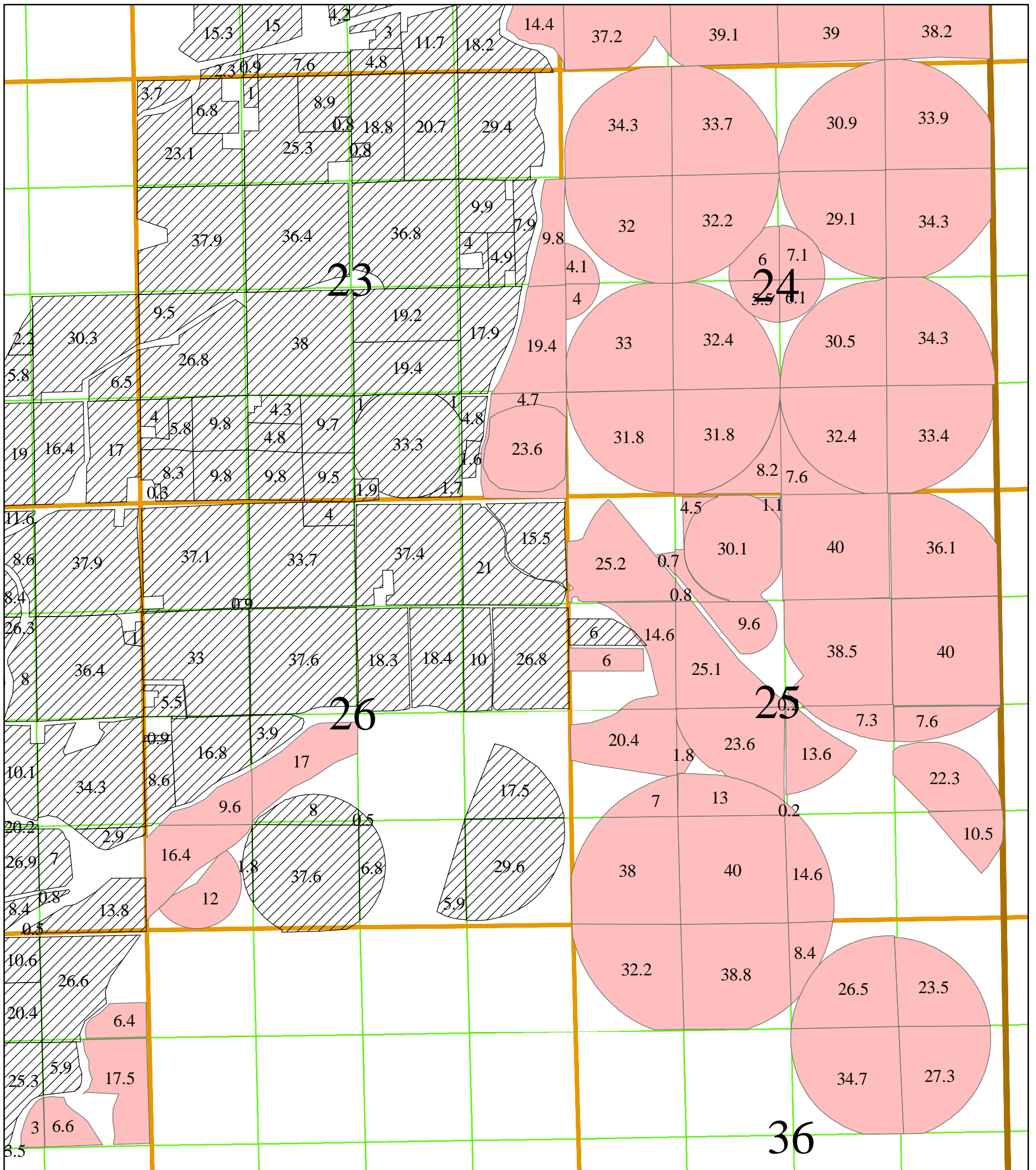

Legend

stan429final

Priority

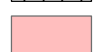
-  1905
-  1965

1 inch = 1320 feet

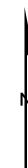

TOWNSHIP 4 NORTH, RANGE 29 EAST, W.M.

SECTION 32

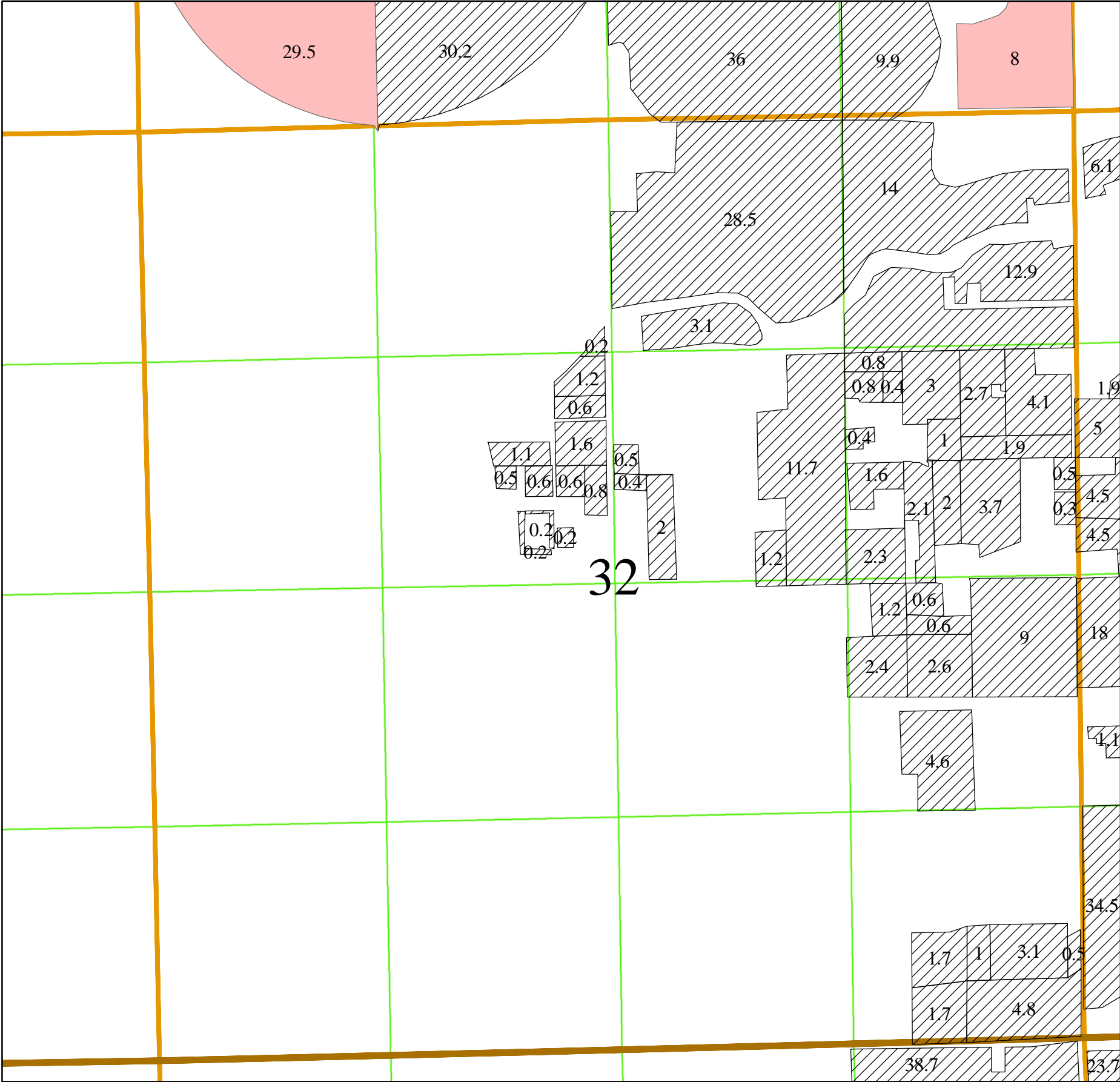

Legend
stan429final
Priority
1905
1965

1 inch = 660 feet

