

# T. 9S. & 10S., R.3W., W.M.

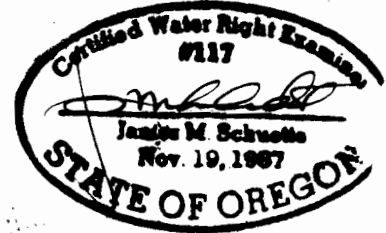

## Final Proof Survey

Application #: 70243  
Permit #: 51561

In the Name Of

## Iverson Brothers

Surveyed on June 29, 1998  
by JM Schuette

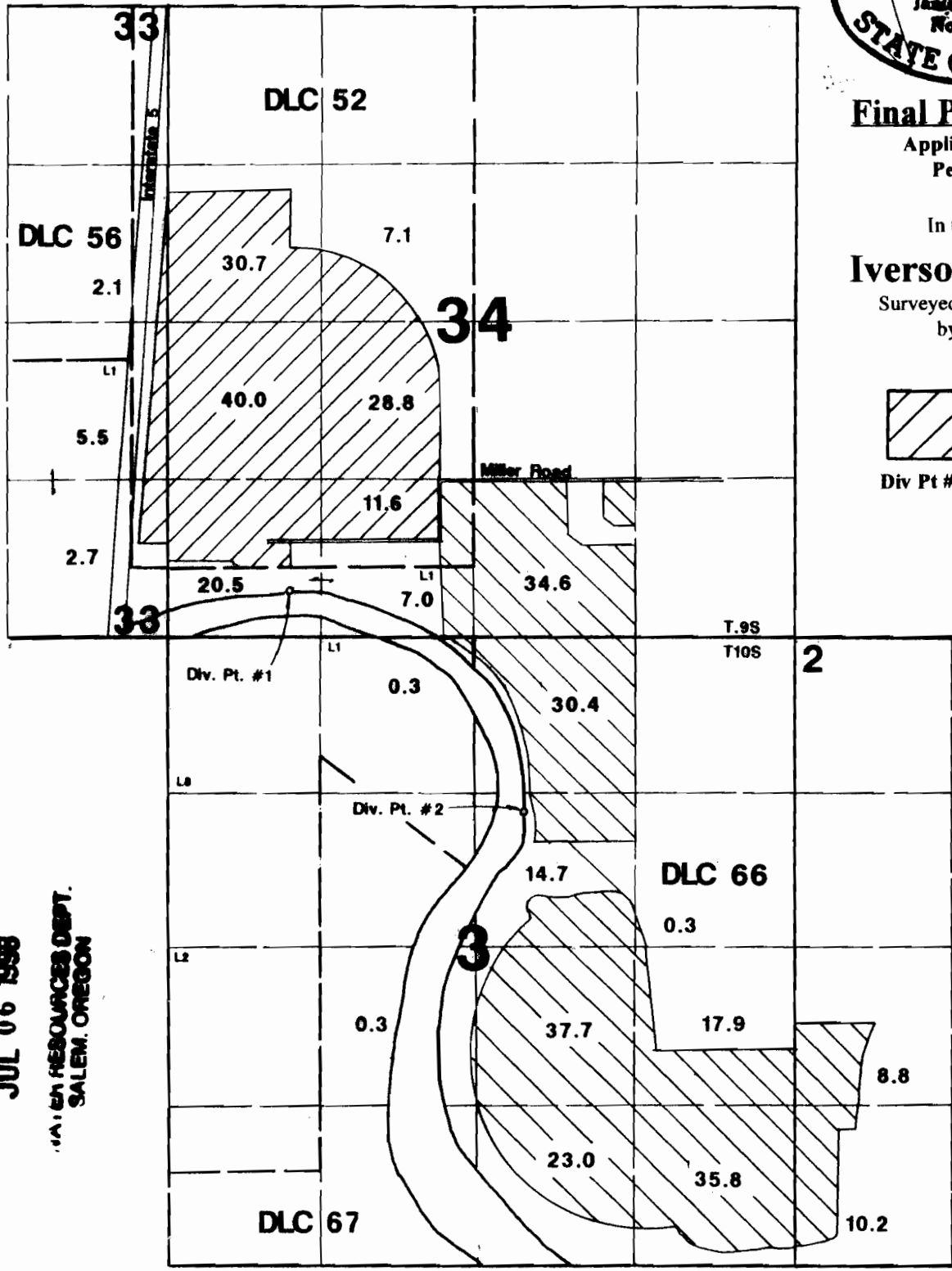

**RECEIVED**

**JUL 06 1998**

WATER RESOURCES DEPT.  
SALEM, OREGON



Div. Pt. #1 is located 450'N & 1020'E from <sup>SW</sup> corner Section 34.  
Div. Pt. #2 is located 1520'S & 3010'E from NW corner Section 3.

**ANNOTATED BY PERMISSION, 7-13-2007**

This Map Was Prepared For The Purpose Of Identifying The Location Of A Water Right Only And Is Not Intended To Provide Legal Dimensions Or Location Of Property Ownership Lines.