

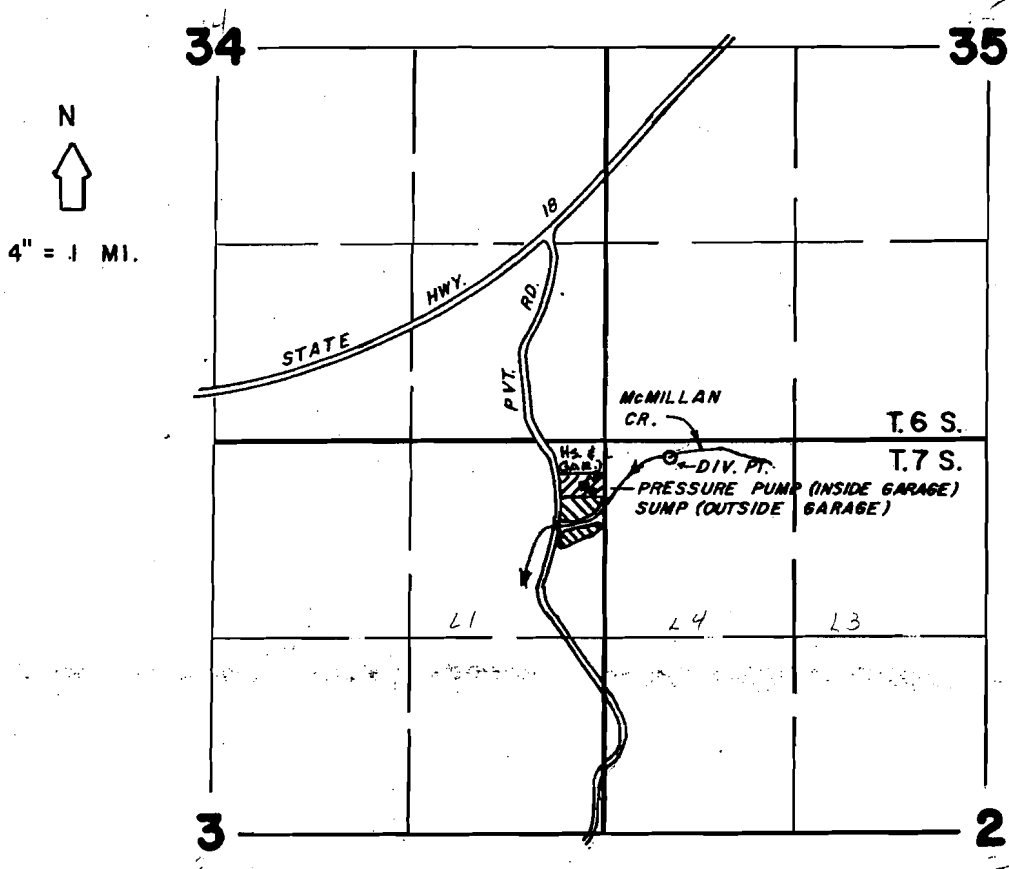

T. 6 & 7 S. R. 10 W. W.M.



N
↑
4" = 1 MI.

-  1971 CERT. NO. 41001 - 1.0 AC. & DOM.
-  1974 CERT. NO. 46894 - 1.4 AC.

WATER RIGHT MAP FOR

NORMA N. McMILLIN

SURVEYED ON JANUARY 2, 1992

THIS MAP WAS PREPARED FOR THE PURPOSE OF IDENTIFYING THE LOCATION OF A WATER RIGHT ONLY AND IS NOT INTENDED TO PROVIDE LEGAL DIMENSIONS OR LOCATION OF PROPERTY OWNERSHIP LINES.

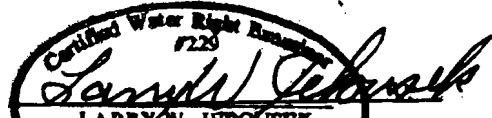
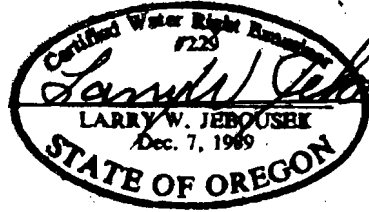
BY: 
 LARRY W. JEBOUSEK
 Dec. 7, 1989

DIV. PT. LOC. 114' S. & 452' E. OF NW COR. SEC. 2