

T. 9S., R. 15E., W.M.

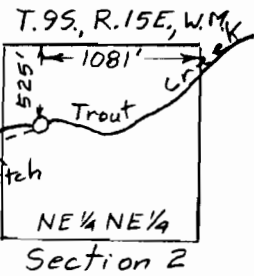

POD #1  
100' N & 300' E  
from W 1/4 corner  
of Section 3

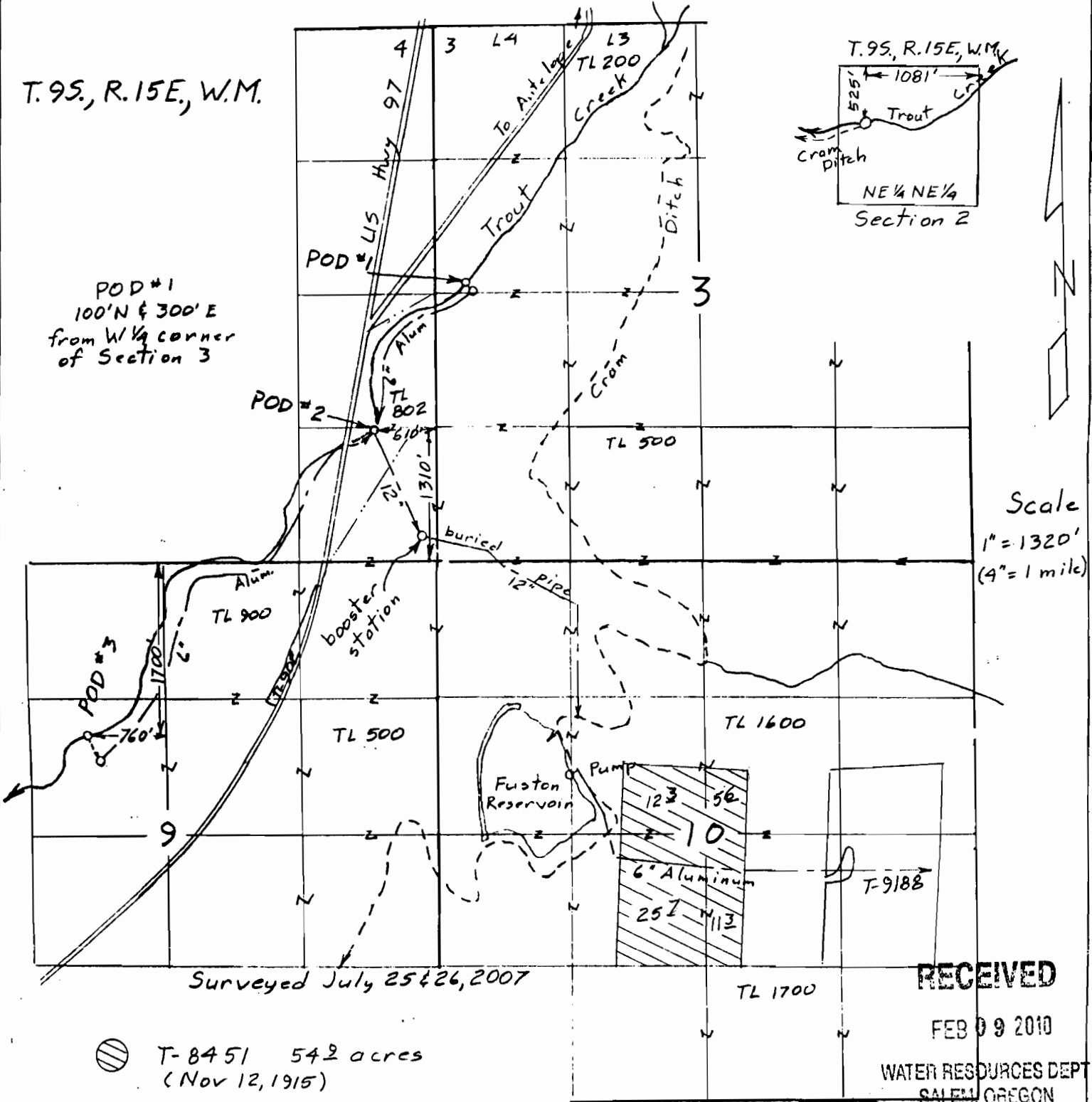

Scale  
1" = 1320'  
(4" = 1 mile)

Surveyed July 25 & 26, 2007

⊘ T-8451 542 acres  
(Nov 12, 1915)

RECEIVED

FEB 09 2010

WATER RESOURCES DEPT  
SALEM, OREGON

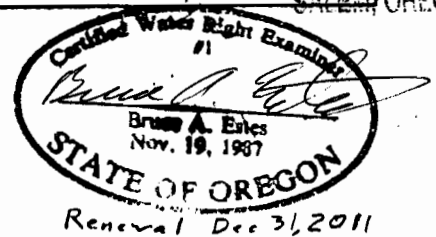

Claim of Beneficial Use Map  
for  
Columbia Empire Farms, Inc.  
(R-2 Ranch)

Transfer T-8451

This map is for the purpose of  
locating a water right only  
and has no intent to provide  
legal dimensions or the location  
of property lines.

**ESTES SURVEYS, LLC**  
 PO Box 47518 80382 Arnold Rd  
 Salem, OR 97306-7519 Bend, OR 97702  
 (503) 566-7593 (541) 382-7391