

T. 5 N., R. 28 E., W. M.

SW1/4 NW1/4  
SECTION 21

# FINAL PROOF SURVEY UNDER

TRANSFER 5228  
IN NAME OF  
LON WADEKAMPER

Surveyed 3-30 1987, by V.L. Church

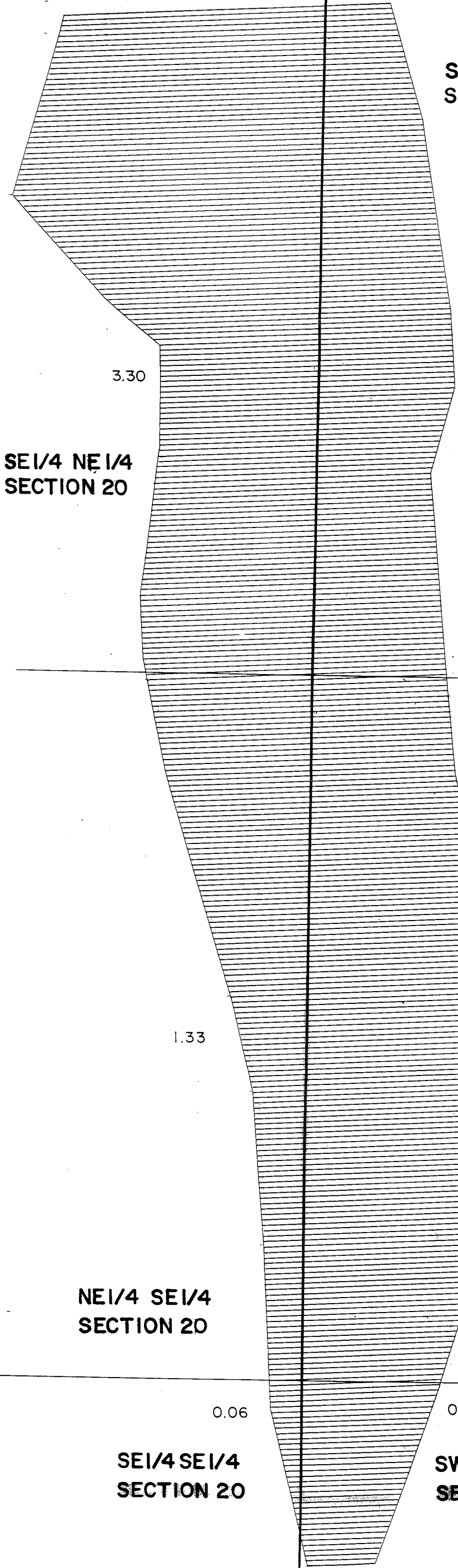

SE1/4 NE1/4  
SECTION 20

NE1/4 SE1/4  
SECTION 20

SE1/4 SE1/4  
SECTION 20

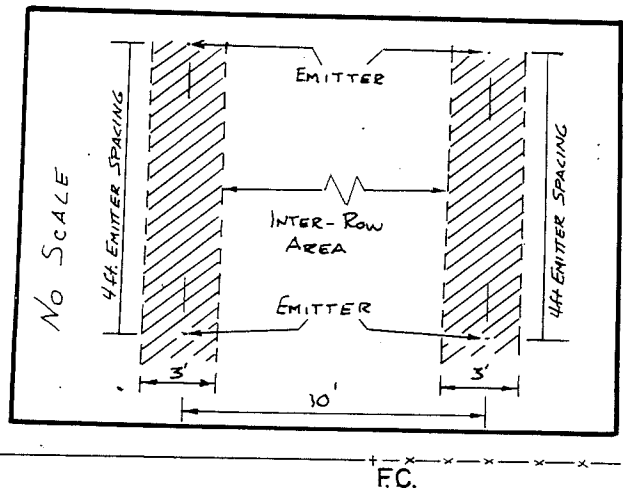

SCALE 1" = 200'

EACH CROSSHATCHED LINE  
REPRESENTS ONE ROW OF  
GRAPES.

WELL LOCATED 1750' SOUTH AND  
90' EAST FROM WEST 1/4 CORNER  
SECTION 21

NW1/4 SW1/4  
SECTION 21

SW1/4 SW1/4  
SECTION 21

WELL