

**Claim of Beneficial Use
Place of Use Map**

Water Right in the Name of:
City of The Dalles
Transfer T-7258 (Permit U-189)

- LEGEND**
- Place of Use (POU)
 - Service Area
 - Major Roadways
 - Waterways
 - Waterbodies

Certified Water Rights Examiner
#78185WRE

Theodore R. Ressler
Theodore R. Ressler
June 29, 2007
STATE OF OREGON

EXPIRES: 12-31-2010

Disclaimer
This map was prepared for the purpose of identifying the location of a water right only and is not intended to provide legal dimensions or location of property ownership lines.

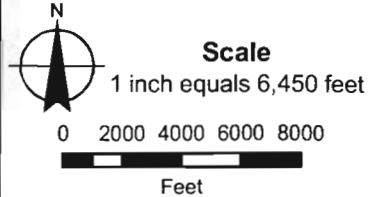

MAP NOTES:
Projection: Oregon State Plane North Zone
Datum: North American Datum of 1983
Date: July 6, 2009
Data Sources: GISMAP, Oregon Geographic Information System, City of The Dalles



Claim of Beneficial Use Point of Appropriation Map Water Right in the Name of: City of The Dalles

Transfer T-7258 (Permit U-189)

Township 1 North, Range 13 East (W.M.)

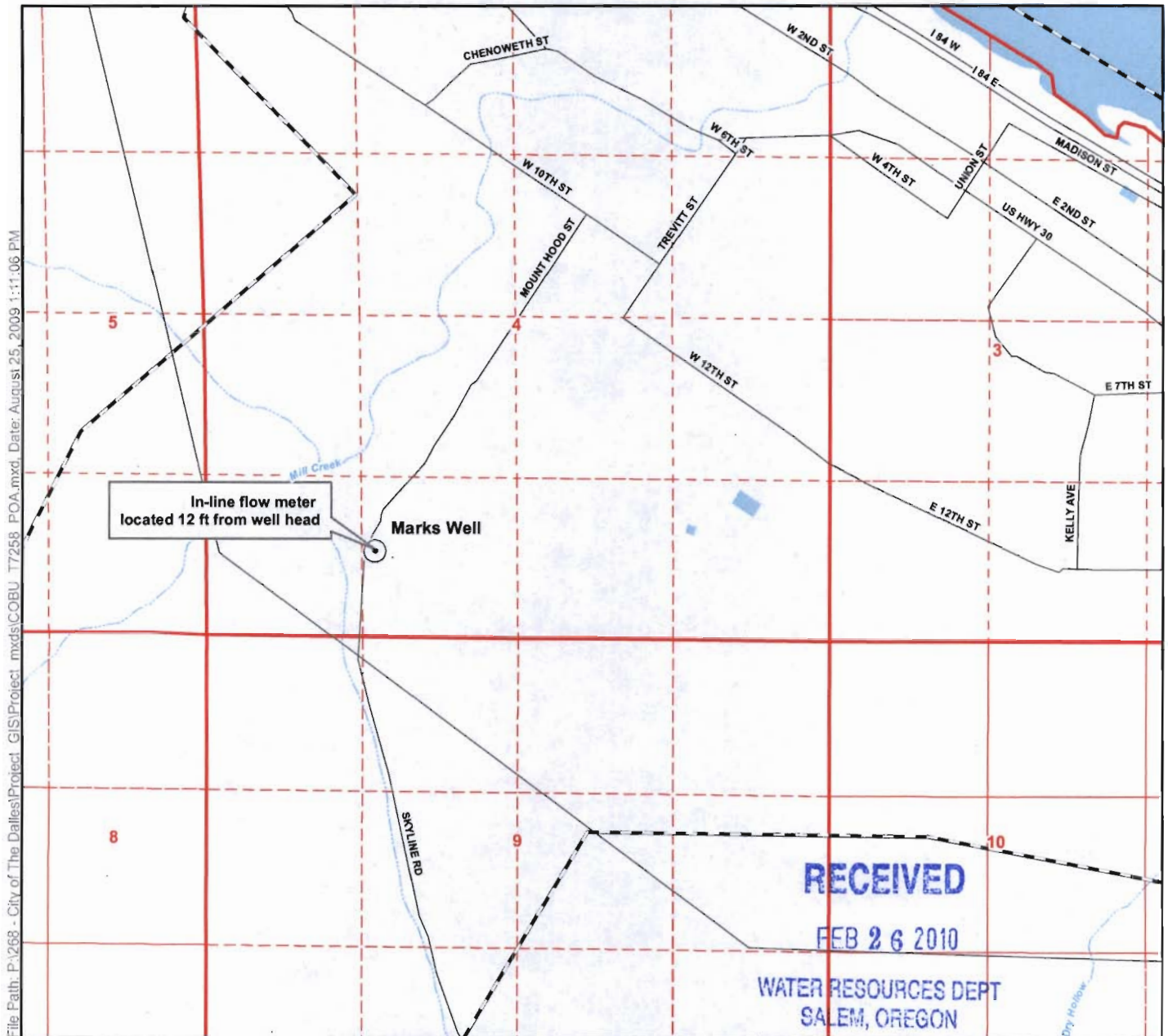

File Path: P:\268 - City of The Dalles\Project_GIS\Protect_mxd\COBU_T7258_POA.mxd, Date: August 25, 2009 1:11:06 PM

Legend

- Point of Appropriation (POA)
- Service Area
- Major Roadways
- Waterways
- Waterbodies

POA Location Descriptions

Marks Well
Located 720 feet North and 1400 feet East from the SW corner of Section 4, Township 1 North, Range 13 East (W.M.)

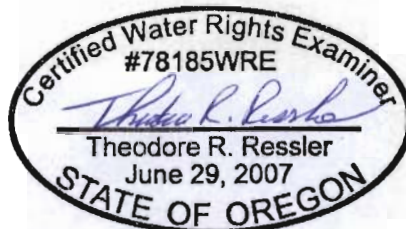

EXPIRES: 12-31-2010

Map Information

Projection: Oregon State Plane North Zone
Datum: North American Datum of 1983
Date: August 25, 2009
Prepared By: GSI Water Solutions, Inc.

Data Sources

OWRD, Oregon Geospatial Clearinghouse, City of The Dalles

Disclaimer

This map was prepared for the purpose of identifying the location of a water right only and it is not intended to provide legal dimensions or location of property ownership lines.



Scale

0 660 1,320
1 inch equals 1,320 feet

