

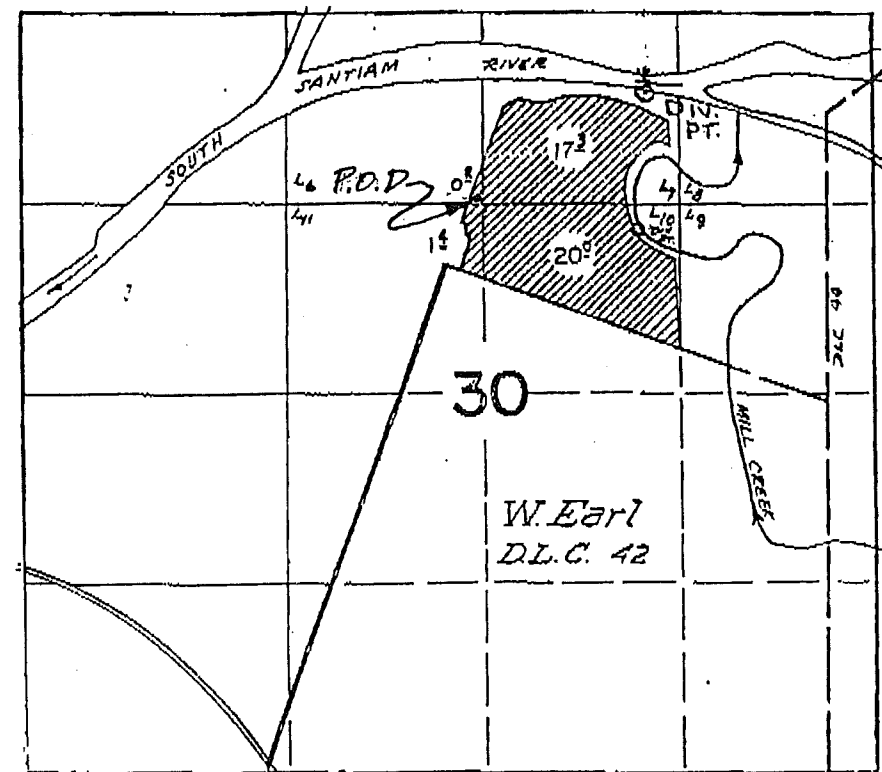

SCALE: 1" = 1320'

NE 1/4 & NW 1/4 OF SECTION 30  
T.10 S., R.2 W., W.M.,  
LINN COUNTY, OREGON



P.O.D. IS 520' North and 240' East of  
NW Corner of D.L.C. No. 42.

I, JACK R. BURRELL, BEING DULY SWORN AS A WATER RIGHT EXAMINER, LICENSE NO. 209, HAVE PREPARED THIS MAP FOR TOM AND NANCY VANASCHE ON THIS 17TH DAY OF OCTOBER 1994. THE AREAS HATCHED REPRESENT THE ACREAGES BEING IRRIGATED AT THE TIME OF THE SURVEY.

PREPARATION OF THIS MAP IS FOR THE PURPOSE OF IDENTIFYING THE LOCATION OF THE WATER RIGHT ONLY AND HAS NO INTENT TO PROVIDE DIMENSIONS OR LOCATION OF PROPERTY OWNERSHIP LINES.

FINAL PROOF SURVEY

Under

APPLICATION T-6554

in the name of

**TOM AND NANCY VANASCHE**  
37731 N.E. Bond Rd.  
Albany, OR 97321

RECEIVED

NOV 18 1994

WATER RESOURCES DEPT

SALEM, OREGON

Surveyed By:

K & D ENGINEERING, INC.

July 15, 1994

**Existing Acres in Section 30**

Under Permit 47557 (Certificate No. 62107) is 38.90 acres. No changes have occurred as a result of this transfer. The authorized place of use is as follows:

NW 1/4 NE 1/4	=	17.3 Acres
SW 1/4 NE 1/4	=	20.0 Acres
NE 1/4 NW 1/4	=	0.2 Acres
SE 1/4 NW 1/4	=	1.4 Acres
<b>TOTAL</b>	<b>=</b>	<b>38.9 ACRES</b>

**PRIOR P.O.D.**

The prior Point of Diversion was 1060 feet North and 1380 feet East from the NW corner of DLC No. 42.

**NEW P.O.D.**

The new Point of Diversion is 520 feet North and 240 feet East from the NW corner of DLC No. 42.

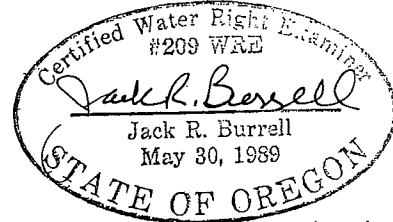

EXPIRATION DATE: 12/31/95

**KD ENGINEERING, INC.**  
202 NW HICKORY STREET  
POST OFFICE BOX 725  
ALBANY, OREGON 97321

**VANASCHE WATER RIGHT**

DSGN. BY: N/A	SCALE: AS SHOWN	SHEET NO.
DWG. BY: G.L.P.	DATE: 10-17-94	1 of 1
CKD. BY: J.R.B.	PROJECT NO: 91-56	