

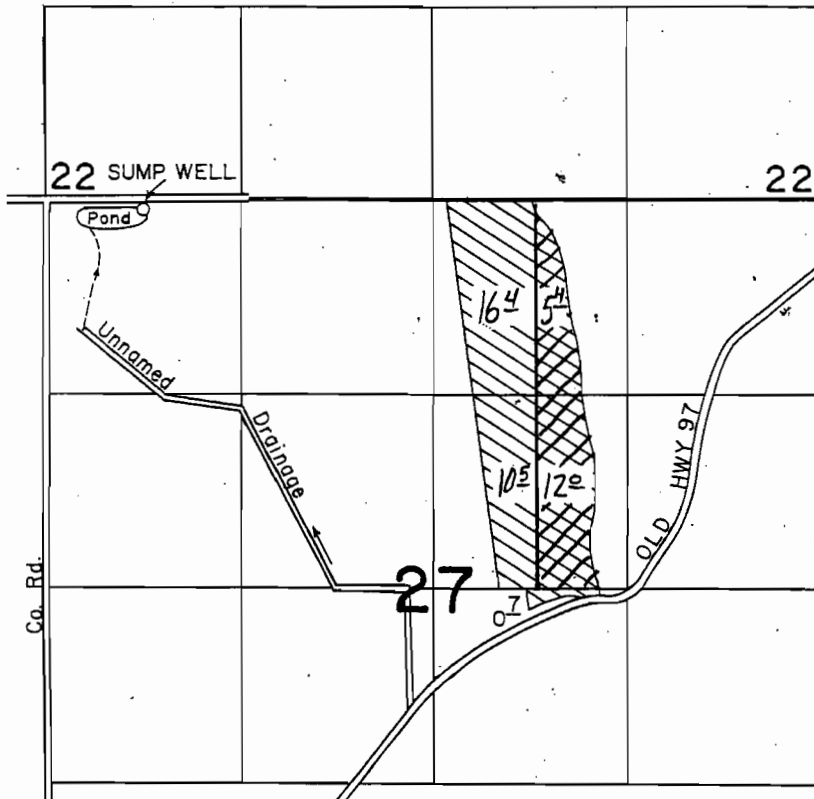



T. 9 S., R. 14 E., W.M.



SUMP WELL LOC.: 80' S. & 650' E. FROM NW CORNER SECTION 27.

-  Supplemental IR under Permits G-8467 & S-43932
-  Primary IR under Permit G-8467
Supplemental IR under Permit S-43932

SCALE: 1" = 1320'

FINAL PROOF SURVEY

UNDER

G-9075 G-8467

Application No. 58230.. Permit No. 43932.....

IN NAME OF

ENOS R. & JANICE R. BROWN

Surveyed JUNE 21, 1989, by B. W. BISHOP.....

5-24-2010 *AC*
2-12-90 *pat*
FXP 9-5 (N111D)