

RECEIVED

JUN - 6 1996

WATER RESOURCES DEPT
SALEM, OREGON

SW1/4NW1/4 SEC. 20, T13S, R29E.

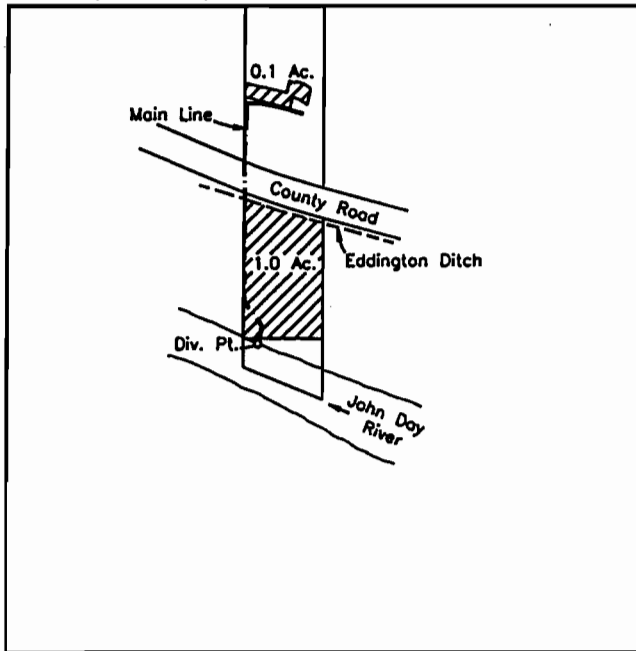

SCALE 1"=400'

W1/4 cor.

Diversion Point is 640' N. and 520' E. of the W1/4 cor.

FINAL PROOF SURVEY
UNDER

TRANSFER NO. 6779
SPECIAL ORDER VOL. 49, PAGE 135

IN NAME OF
MAX AND IRENE FERGUSON

SURVEYED MAY 3, 1996 BY ROBERT D. BAGETT

NOTE: The preparation of this map was for the purpose of identifying the location of the proposed water right and has no intent to provide dimensions or location of property ownership lines.

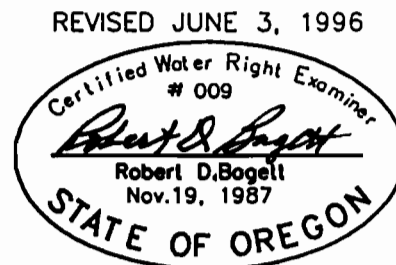

REVISED JUNE 3, 1996